

FITTINGS

FITTINGS FI - F50

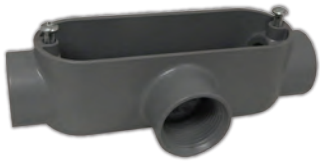

STRAPS F51 - F55



LIQUID TITE F56 - F58



Aluminum Rigid Conduit Bodies T Type - Threaded

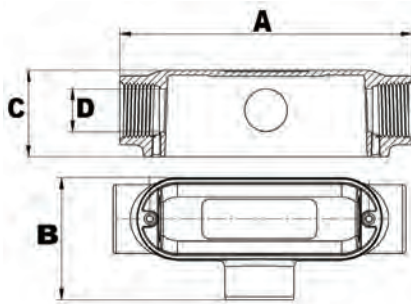

- Tapered Threaded Hubs (NPT)
- RainTight when used with Gasketed Covers
- Die-Cast from High-Strength, Corrosion and Weather Resistant Copper Free Aluminum Alloy
- Flat Back Design for easy mounting close to walls

To Provide Access to Conductors for Pulling, Splicing, and Maintenance. Threaded for Rigid & IMC Conduit

DIMENSIONS = INCHES

CAT. NO.	TRADE SIZE	DIMENSIONS - T SERIES				BOX QTY
		A	B	C	D	
14060	1/2"	4.72	2.03	1.36	.61	50
14061	3/4"	5.51	2.30	1.63	.81	50
14062	1"	6.46	2.68	1.89	1.04	25
14063	1-1/4"	8.35	3.52	2.50	1.37	10
14064	1-1/2"	8.35	3.52	2.50	1.60	10
14065	2"	10.55	4.27	3.41	2.06	10
14066	2-1/2"	13.46	5.89	3.98	2.46	1
14067	3"	13.46	5.89	4.53	3.06	1
14068	3-1/2"	16.30	7.66	5.60	3.54	1
14069	4"	16.30	7.66	5.60	4.02	1
WITH COVER AND GASKET						
14070	1/2"	4.72	2.03	1.36	.61	50
14071	3/4"	5.51	2.30	1.63	.81	50
14072	1"	6.46	2.68	1.89	1.04	25
14073	1-1/4"	8.35	3.52	2.50	1.37	10
14074	1-1/2"	8.35	3.52	2.50	1.60	10
14075	2"	10.55	4.27	3.41	2.06	10
14076	2-1/2"	13.46	5.89	3.98	2.46	1
14077	3"	13.46	5.89	4.53	3.06	1
14078	3-1/2"	16.30	7.66	5.60	3.54	1
14079	4"	16.30	7.66	5.60	4.02	1

Aluminum Rigid Conduit Bodies LB Type - Threaded

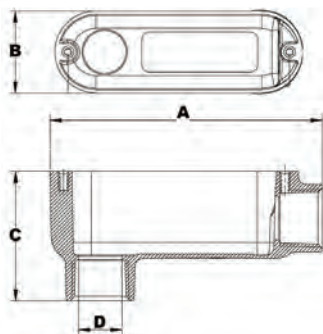

- Tapered Threaded Hubs (NPT)
- RainTight when used with Gasketed Covers
- Die-Cast from High-Strength, Corrosion and Weather Resistant Copper Free Aluminum Alloy
- Flat Back Design for easy mounting close to walls

To Provide Access to Conductors for Pulling, Splicing, and Maintenance. Threaded for Rigid & IMC Conduit

DIMENSIONS = INCHES

CAT. NO.	TRADE SIZE	DIMENSIONS - LB SERIES				BOX QTY
		A	B	C	D	
14040	1/2"	4.31	1.34	2.09	.61	50
14041	3/4"	5.08	1.56	2.39	.81	50
14042	1"	5.92	1.82	2.78	1.04	25
14043	1-1/4"	7.82	2.51	3.52	1.37	10
14044	1-1/2"	7.82	2.51	3.52	1.60	10
14045	2"	10.05	3.19	4.51	2.06	10
14046	2-1/2"	12.83	4.49	5.31	2.46	1
14047	3"	12.83	4.49	5.91	3.06	1
14048	3-1/2"	15.65	5.55	7.09	3.54	1
14049	4"	15.65	5.55	7.09	4.02	1
WITH COVER AND GASKET						
14050	1/2"	4.31	1.34	2.09	.61	50
14051	3/4"	5.08	1.56	2.39	.81	50
14052	1"	5.92	1.82	2.78	1.04	25
14053	1-1/4"	7.82	2.51	3.52	1.37	10
14054	1-1/2"	7.82	2.51	3.52	1.60	10
14055	2"	10.05	3.19	4.51	2.06	10
14056	2-1/2"	12.83	4.49	5.31	2.46	1
14057	3"	12.83	4.49	5.91	3.06	1
14058	3-1/2"	15.65	5.55	7.09	3.54	1
14059	4"	15.65	5.55	7.09	4.02	1

Aluminum Rigid Conduit Bodies LR Type - Threaded



To Provide Access to Conductors for Pulling, Splicing, and Maintenance. Threaded for Rigid & IMC Conduit

DIMENSIONS = INCHES

CAT. NO.	TRADE SIZE	DIMENSIONS-LR SERIES				BOX QTY
		A	B	C	D	
I4080	1/2"	4.31	2.03	1.36	.61	50
I4081	3/4"	5.08	2.30	1.63	.81	50
I4082	1"	5.92	2.68	1.89	1.04	25
I4083	1-1/4"	7.82	3.52	2.50	1.37	10
I4084	1-1/2"	7.82	3.52	2.50	1.60	10
I4085	2"	10.05	4.27	3.41	2.06	10
I4086	2-1/2"	12.83	5.89	3.98	2.46	1
I4087	3"	12.83	5.89	4.53	3.06	1
I4088	3-1/2"	15.65	7.66	5.59	3.54	1
I4089	4"	15.65	7.66	5.59	4.02	1
WITH COVER AND GASKET						
I4090	1/2"	4.31	2.03	1.36	.61	50
I4091	3/4"	5.08	2.30	1.63	.81	50
I4092	1"	5.92	2.68	1.89	1.04	25
I4093	1-1/4"	7.82	3.52	2.50	1.37	10
I4094	1-1/2"	7.82	3.52	2.50	1.60	10
I4095	2"	10.05	4.27	3.41	2.06	10
I4096	2-1/2"	12.83	5.89	3.98	2.46	1
I4097	3"	12.83	5.89	4.53	3.06	1
I4098	3-1/2"	15.65	7.66	5.59	3.54	1
I4099	4"	15.65	7.66	5.59	4.02	1

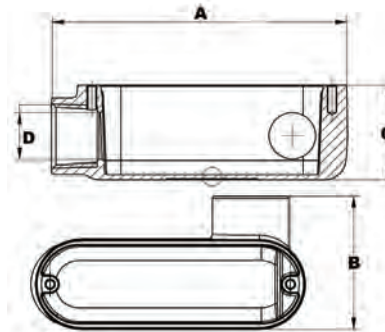

- Tapered Threaded Hubs (NPT)
- RainTight when used with Gasketed Covers
- Die-Cast from High-Strength, Corrosion and Weather Resistant, Copper Free Aluminum Alloy
- Flat Back Design for easy mounting close to walls

Aluminum Rigid Conduit Bodies LL Type - Threaded



To Provide Access to Conductors for Pulling, Splicing, and Maintenance. Threaded for Rigid & IMC Conduit

DIMENSIONS = INCHES

CAT. NO.	TRADE SIZE	DIMENSIONS-LL SERIES				BOX QTY
		A	B	C	D	
I4100	1/2"	4.31	2.03	1.36	.61	50
I4101	3/4"	5.08	2.30	1.63	.81	50
I4102	1"	5.92	2.68	1.89	1.04	25
I4103	1-1/4"	7.82	3.52	2.50	1.37	10
I4104	1-1/2"	7.82	3.52	2.50	1.60	10
I4105	2"	10.05	4.27	3.41	2.06	10
I4106	2-1/2"	12.83	5.89	3.98	2.46	1
I4107	3"	12.83	5.89	4.53	3.06	1
I4108	3-1/2"	15.65	7.66	5.59	3.54	1
I4109	4"	15.65	7.66	5.59	4.02	1
WITH COVER AND GASKET						
I4110	1/2"	4.31	2.03	1.36	.61	50
I4111	3/4"	5.08	2.30	1.63	.81	50
I4112	1"	5.92	2.68	1.89	1.04	25
I4113	1-1/4"	7.82	3.52	2.50	1.37	10
I4114	1-1/2"	7.82	3.52	2.50	1.60	10
I4115	2"	10.05	4.27	3.41	2.06	10
I4116	2-1/2"	12.83	5.89	3.98	2.46	1
I4117	3"	12.83	5.89	4.53	3.06	1
I4118	3-1/2"	15.65	7.66	5.59	3.54	1
I4119	4"	15.65	7.66	5.59	4.02	1

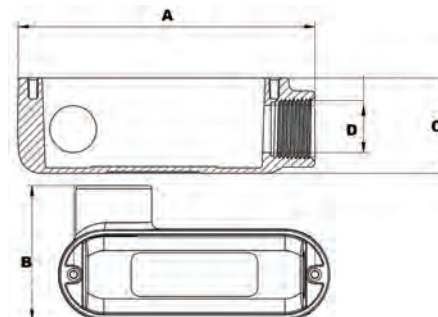

- Tapered Threaded Hubs (NPT)
- RainTight when used with Gasketed Covers
- Die-Cast from High-Strength, Corrosion and Weather Resistant, Copper Free Aluminum Alloy
- Flat Back Design for easy mounting close to walls

Aluminum Rigid Conduit Bodies C Type-Threaded



Conduit Bodies FITTINGS

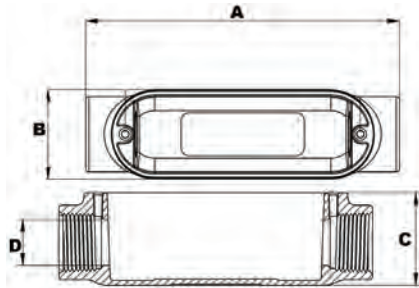

- Tapered Threaded Hubs (NPT)
- RainTight when used with Gasketed Covers
- Die-Cast from High-Strength, Corrosion and Weather Resistant, Copper Free Aluminum Alloy
- Flat Back Design for easy mounting close to walls

To Provide Access to Conductors for Pulling, Splicing, and Maintenance. Threaded for Rigid & IMC Conduit

DIMENSIONS = INCHES

CAT. NO.	TRADE SIZE	DIMENSIONS-C SERIES				BOX QTY
		A	B	C	D	
I4I20	1/2"	4.72	1.34	1.36	.61	50
I4I21	3/4"	5.51	1.56	1.63	.81	50
I4I22	1"	6.46	1.82	1.89	1.04	25
I4I23	1-1/4"	8.35	2.51	2.50	1.37	10
I4I24	1-1/2"	8.35	2.51	2.50	1.60	10
I4I25	2"	10.55	3.19	3.41	2.06	10
I4I26	2-1/2"	13.46	4.49	3.98	2.46	1
I4I27	3"	13.46	4.49	4.53	3.06	1
I4I28	3-1/2"	16.30	5.55	5.59	3.54	1
I4I29	4"	16.30	5.55	5.59	4.02	1
WITH COVER AND GASKET						
I4I30	1/2"	4.72	1.34	1.36	.61	50
I4I31	3/4"	5.51	1.56	1.63	.81	50
I4I32	1"	6.46	1.82	1.89	1.04	25
I4I33	1-1/4"	8.35	2.51	2.50	1.37	10
I4I34	1-1/2"	8.35	2.51	2.50	1.60	10
I4I35	2"	10.55	3.19	3.41	2.06	10
I4I36	2-1/2"	13.46	4.49	3.98	2.46	1
I4I37	3"	13.46	4.49	4.53	3.06	1
I4I38	3-1/2"	16.30	5.55	5.59	3.54	1
I4I39	4"	16.30	5.55	5.59	4.02	1

Aluminum Mogul Conduit Bodies with Cover & Gasket

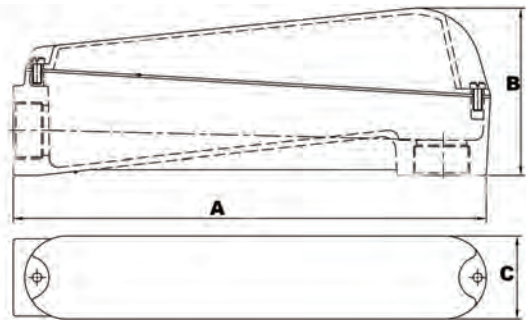

- Larger body size facilitates pulling of large and heavy conductors
- Specially designed raised cast covers provide additional wiring area
- Moguls are used for pulling straight, 45° or 90° angle turns and/or making taps and splices
- Exclusive built-in rollers facilitate cable pulling
- Smooth, rounded integral bushing in each hub protects conductor insulation
- Accurately tapped, tapered threads for tight, rigid joints and ground continuity
- Covers have captive stainless steel screws to speed installation, prevent 'freezing' of screws
- Includes cellulose/rubber Flex Sealing Gasket
- Length Requirement: distance between centerline of each hub bushing (conduit stop) exceeds six times the trade diameter of the conduit

WITH COVER & GASKET

DIMENSIONS = INCHES

CAT. NO.	TRADE SIZE	DIMENSIONS			WIRESIZE	BOX QTY
		A	B	C		
I4300	1-1/4"	9.65	3.54	2.50	3 #1/0 AWG	2
I4301	1-1/2"	14.53	5.41	3.13	3 #3/0 AWG	1
I4302	2"	14.53	5.41	3.13	3 #300 MCM	1
I4303	2-1/2"	22.01	7.54	4.53	3 #400 MCM	1
I4304	3"	22.01	7.54	4.53	3 #700 MCM	1
I4305	3-1/2"	28.84	8.94	5.51	3 #900 MCM	1
I4306	4"	28.84	8.94	5.51	3 #1000 MCM	1

Aluminum EMT Set Screw Conduit Bodies T Type



To Provide Access to Conductors for Pulling, Splicing, and Maintenance. For EMT Conduit

- Set Screw for EMT Conduit
- RainTight when used with Gasketed Covers
- Die-Cast from High-Strength, Corrosion and Weather Resistant Copper Free Aluminum Alloy
- Flat Back Design for easy mounting close to walls

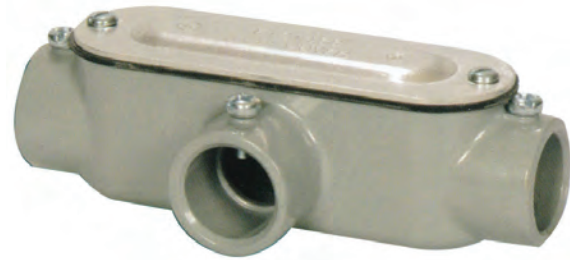

DIMENSIONS = INCHES

CAT. NO.	TRADE SIZE	DIMENSIONS-T SERIES				BOX QTY
		A	B	C	D	
14160	1/2"	4.75	2.03	1.36	.72	50
14161	3/4"	5.51	2.30	1.63	.96	50
14162	1"	6.46	2.68	1.89	1.18	25
14163	1-1/4"	8.35	3.52	2.50	1.53	10
14164	1-1/2"	8.36	3.52	2.50	1.76	10
14165	2"	10.55	4.27	3.41	2.21	10
WITH COVER AND GASKET						
14170	1/2"	4.75	2.03	1.36	.72	50
14171	3/4"	5.51	2.30	1.63	.96	50
14172	1"	6.46	2.68	1.89	1.18	25
14173	1-1/4"	8.35	3.52	2.50	1.53	10
14174	1-1/2"	8.36	3.52	2.50	1.76	10
14175	2"	10.55	4.27	3.41	2.21	10

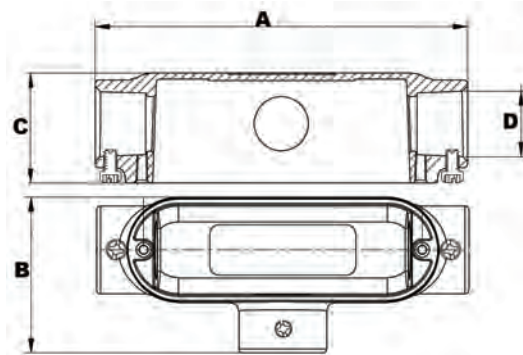

Aluminum EMT Set Screw Conduit Bodies LB Type



To Provide Access to Conductors for Pulling, Splicing, and Maintenance. For EMT Conduit

- Set Screw for EMT Conduit
- RainTight when used with Gasketed Covers
- Die-Cast from High-Strength, Corrosion and Weather Resistant Copper Free Aluminum Alloy
- Flat Back Design for easy mounting close to walls



DIMENSIONS = INCHES

CAT. NO.	TRADE SIZE	DIMENSIONS-LB SERIES				BOX QTY
		A	B	C	D	
14140	1/2"	4.31	1.34	2.09	.72	50
14141	3/4"	5.08	1.56	2.39	.96	50
14142	1"	5.92	1.82	2.78	1.18	25
14143	1-1/4"	7.82	2.51	3.52	1.53	10
14144	1-1/2"	7.82	2.51	3.52	1.76	10
14145	2"	10.05	3.19	4.51	2.21	10
WITH COVER AND GASKET						
14150	1/2"	4.31	1.34	2.09	.72	50
14151	3/4"	5.08	1.56	2.39	.96	50
14152	1"	5.92	1.82	2.78	1.18	25
14153	1-1/4"	7.82	2.51	3.52	1.53	10
14154	1-1/2"	7.82	2.51	3.52	1.76	10
14155	2"	10.05	3.19	4.51	2.21	10

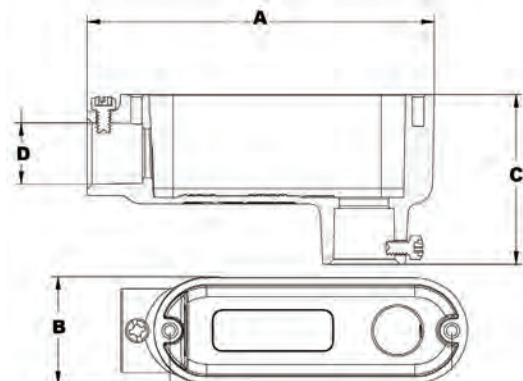

Aluminum EMT Set Screw Conduit Bodies LR Type



To Provide Access to Conductors for Pulling, Splicing, and Maintenance. For EMT Conduit

- Set Screw for EMT Conduit
- RainTight when used with Gasketed Covers
- Die-Cast from High-Strength, Corrosion and Weather Resistant Copper Free Aluminum Alloy
- Flat Back Design for easy mounting close to walls

DIMENSIONS = INCHES

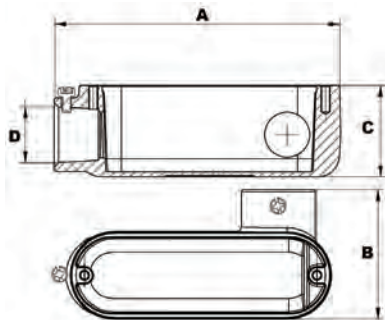

CAT. NO.	TRADE SIZE	DIMENSIONS-LR SERIES				BOX QTY
		A	B	C	D	
14180	1/2"	4.31	2.03	1.36	.72	50
14181	3/4"	5.08	2.30	1.63	.96	50
14182	1"	5.92	2.68	1.89	1.18	25
14183	1-1/4"	7.82	3.52	2.50	1.52	10
14184	1-1/2"	7.82	3.52	2.50	1.76	10
14185	2"	10.05	4.27	3.41	2.21	10
WITH COVER AND GASKET						
14190	1/2"	4.31	2.03	1.36	.72	50
14191	3/4"	5.08	2.30	1.63	.96	50
14192	1"	5.92	2.68	1.89	1.18	25
14193	1-1/4"	7.82	3.52	2.50	1.52	10
14194	1-1/2"	7.82	3.52	2.50	1.76	10
14195	2"	10.05	4.27	3.41	2.21	10

Aluminum EMT Set Screw Conduit Bodies LL Type



To Provide Access to Conductors for Pulling, Splicing, and Maintenance. For EMT Conduit

- Set Screw for EMT Conduit
- RainTight when used with Gasketed Covers
- Die-Cast from High-Strength, Corrosion and Weather Resistant Copper Free Aluminum Alloy
- Flat Back Design for easy mounting close to walls

DIMENSIONS = INCHES

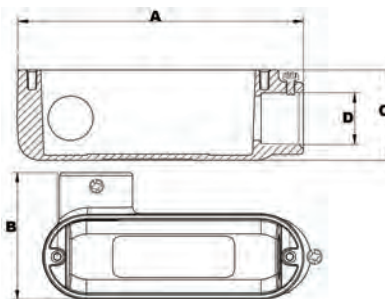

CAT. NO.	TRADE SIZE	DIMENSIONS-LL SERIES				BOX QTY
		A	B	C	D	
14200	1/2"	4.31	2.03	1.36	.72	50
14201	3/4"	5.08	2.30	1.63	.96	50
14202	1"	5.92	2.68	1.89	1.18	25
14203	1-1/4"	7.82	3.52	2.50	1.52	10
14204	1-1/2"	7.82	3.52	2.50	1.76	10
14205	2"	10.05	4.27	3.41	2.21	10
WITH COVER AND GASKET						
14210	1/2"	4.31	2.03	1.36	.72	50
14211	3/4"	5.08	2.30	1.63	.96	50
14212	1"	5.92	2.68	1.89	1.18	25
14213	1-1/4"	7.82	3.52	2.50	1.52	10
14214	1-1/2"	7.82	3.52	2.50	1.76	10
14215	2"	10.05	4.27	3.41	2.21	10

Aluminum EMT Set Screw Conduit Bodies Type C



To Provide Access to Conductors for Pulling, Splicing, and Maintenance. For EMT Conduit

- Set Screw for EMT Conduit
- RainTight when used with Gasketed Covers
- Die-Cast from High-Strength, Corrosion and Weather Resistant Copper Free Aluminum Alloy
- Flat Back Design for easy mounting close to walls



DIMENSIONS = INCHES

CAT. NO.	TRADE SIZE	DIMENSIONS-C SERIES				BOX QTY
		A	B	C	D	
I4220	1/2"	4.72	1.34	1.36	.72	50
I4221	3/4"	5.51	1.56	1.63	.96	50
I4222	1"	6.46	1.82	1.89	1.18	25
I4223	1-1/4"	8.35	2.51	2.50	1.52	10
I4224	1-1/2"	8.35	2.51	2.50	1.76	10
I4225	2"	10.55	3.19	3.41	2.21	10
WITH COVER AND GASKET						
I4230	1/2"	4.72	1.34	1.36	.72	50
I4231	3/4"	5.51	1.56	1.63	.96	50
I4232	1"	6.46	1.82	1.89	1.18	25
I4233	1-1/4"	8.35	2.51	2.50	1.52	10
I4234	1-1/2"	8.35	2.51	2.50	1.76	10
I4235	2"	10.55	3.19	3.41	2.21	10

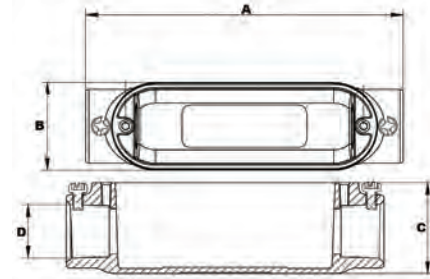

Trade Size in Inches		Wire Size (THWN, THHN) Conductor Size AWG/kcmil																					
		14	12	10	8	6	4	3	2	1	1/0	2/0	3/0	4/0	250	300	350	400	500	600	700	750	
1/2	EMT	12	9	5	3	2	1	1	1	1	1	--	--	--	--	--	--	--	--	--	--	--	--
	IMC	14	10	6	3	2	1	1	1	1	1	1	--	--	--	--	--	--	--	--	--	--	--
	GALV	13	9	6	3	2	1	1	1	1	1	--	--	--	--	--	--	--	--	--	--	--	--
3/4	EMT	22	16	10	6	4	2	1	1	1	1	1	1	1	1	--	--	--	--	--	--	--	--
	IMC	24	17	11	6	4	3	2	1	1	1	1	1	1	1	--	--	--	--	--	--	--	--
	GALV	22	16	10	6	4	2	1	1	1	1	1	1	1	1	--	--	--	--	--	--	--	--
1	EMT	35	26	16	9	7	4	3	3	1	1	1	1	1	1	1	1	1	1	1	1	1	1
	IMC	39	29	18	10	7	4	4	3	2	1	1	1	1	1	1	1	1	1	1	1	1	1
	GALV	36	26	17	9	7	4	3	3	1	1	1	1	1	1	1	1	1	1	1	1	1	1
1-1/4	EMT	61	45	28	16	12	7	6	5	4	3	2	1	1	1	1	1	1	1	1	1	1	1
	IMC	68	49	31	18	13	8	6	5	4	3	3	2	1	1	1	1	1	1	1	1	1	1
	GALV	63	46	29	16	12	7	6	5	4	3	2	1	1	1	1	1	1	1	1	1	1	1
1-1/2	EMT	84	61	38	22	16	10	8	7	5	4	3	2	1	1	1	1	1	1	1	1	1	1
	IMC	91	67	42	24	17	10	9	7	5	4	4	3	2	1	1	1	1	1	1	1	1	1
	GALV	85	62	39	22	16	10	8	7	5	4	3	3	2	1	1	1	1	1	1	1	1	1
Trade Size in Inches		Wire Size (THWN, THHN) Conductor Size AWG/kcmil																					
		14	12	10	8	6	4	3	2	1	1/0	2/0	3/0	4/0	250	300	350	400	500	600	700	750	
2	EMT	138	101	63	36	26	16	13	11	8	7	6	5	4	3	2	1	1	1	1	1	1	1
	IMC	149	109	68	39	38	17	15	12	9	8	6	5	4	3	3	2	2	1	1	1	1	1
	GALV	140	102	64	37	27	16	14	11	8	7	6	5	4	3	3	2	2	1	1	1	1	1
2-1/2	EMT	241	176	111	64	46	28	24	20	15	12	10	8	7	6	5	4	4	3	2	2	1	1
	IMC	211	154	97	56	40	25	21	17	13	11	9	7	6	5	4	4	3	3	2	1	1	1
	GALV	200	146	92	53	38	23	20	17	12	10	8	7	6	5	4	3	3	2	1	1	1	1
3	EMT	364	226	167	96	69	43	36	30	22	19	16	13	11	9	7	6	6	5	4	3	3	3
	IMC	362	238	150	86	62	38	32	27	20	17	14	12	9	8	7	6	5	4	3	3	3	3
	GALV	309	225	142	82	59	36	31	26	19	16	13	11	9	7	6	5	5	4	3	3	3	3
3-1/2	EMT	476	347	219	126	91	56	47	40	29	25	20	17	14	11	10	9	8	7	6	5	4	4
	IMC	436	318	200	115	83	51	43	36	27	23	19	16	13	10	9	8	7	6	5	4	4	4
	GALV	412	301	189	109	79	48	41	34	25	21	18	15	12	10	8	7	7	5	4	4	4	4
4	EMT	608	443	279	161	116	71	60	51	37	32	26	22	18	15	13	11	10	8	7	6	5	5
	IMC	562	410	258	149	107	66	56	47	35	29	24	20	17	13	12	10	9	7	6	5	5	5
	GALV	531	387	244	140	101	62	53	44	33	27	23	19	16	13	11	10	8	7	6	5	5	5

Above information referenced from tables C1, C4, and C8 in the National Electric Code of 2008.
 For more information on the following types of conduit, please see the table listed below in the appendix C of the National Electric Code of 2008.
 Rigid PVC Conduit, Schedule 80 -- Table C9
 Rigid PVC Conduit, Schedule 40 -- Table C10
 Flexible Metallic Conduit -- Table C3
 Liquidtight Flexible Metallic Conduit -- Table C7
 Liquidtight Flexible Nonmetallic Conduit (Type FNM-C-B) -- Table C5
 If you have any other questions see the NEC Code Book

FITTINGS Conduit Bodies

Aluminum Combination Conduit Bodies T Type



To Provide Access to Conductors for Pulling, Splicing, and Maintenance. For Rigid, IMC & EMT Conduit

- Threaded for Rigid & IMC Conduits
- Set Screw for EMT Conduit
- RainTight when used with Gasketed Covers
- Die-Cast from High-Strength, Corrosion and Weather Resistant Copper Free Aluminum Alloy
- Flat Back Design for easy mounting close to walls

DIMENSIONS - INCHES

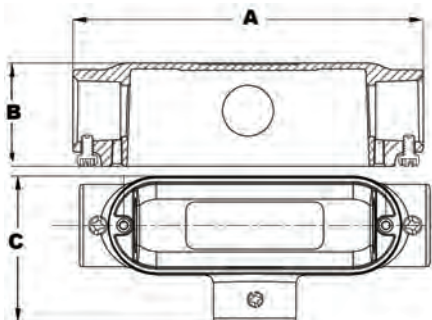

CAT. NO.	TRADE SIZE	DIMENSIONS-T SERIES			BOX QTY
		A	B	C	
14252	1/2"	4.72	1.36	2.03	50
14253	3/4"	5.51	1.63	2.30	50
14254	1"	6.46	1.89	2.68	25
14255	1-1/4"	8.35	2.50	3.52	10
14256	1-1/2"	8.35	2.50	3.52	10
14257	2"	10.55	3.41	4.27	10
WITH COVER AND GASKET					
14258	1/2"	4.72	1.36	2.03	50
14259	3/4"	5.51	1.63	2.30	50
14260	1"	6.46	1.89	2.68	25
14261	1-1/4"	8.35	2.50	3.52	10
14262	1-1/2"	8.35	2.50	3.52	10
14263	2"	10.55	3.41	4.27	10

Aluminum Combination Conduit Bodies LB Type



To Provide Access to Conductors for Pulling, Splicing, and Maintenance. For Rigid, IMC & EMT Conduit

- Threaded for Rigid & IMC Conduits
- Set Screw for EMT Conduit
- RainTight when used with Gasketed Covers
- Die-Cast from High-Strength, Corrosion and Weather Resistant Copper Free Aluminum Alloy
- Flat Back Design for easy mounting close to walls

DIMENSIONS - INCHES

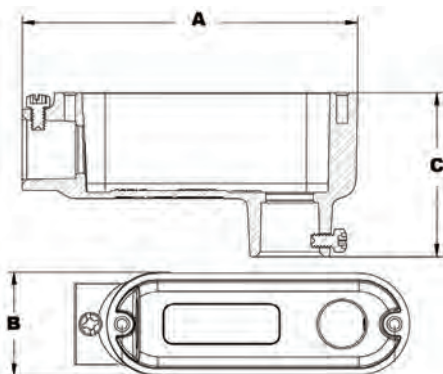

CAT. NO.	TRADE SIZE	DIMENSIONS-LB SERIES			BOX QTY
		A	B	C	
14240	1/2"	4.31	1.34	2.09	50
14241	3/4"	5.08	1.56	2.39	50
14242	1"	5.92	1.82	2.78	25
14243	1-1/4"	7.82	2.51	3.52	10
14244	1-1/2"	7.82	2.51	3.52	10
14245	2"	10.05	3.19	4.51	10
WITH COVER AND GASKET					
14246	1/2"	4.31	1.34	2.09	50
14247	3/4"	5.08	1.56	2.39	50
14248	1"	5.92	1.82	2.78	25
14249	1-1/4"	7.82	2.51	3.52	10
14250	1-1/2"	7.82	2.51	3.52	10
14251	2"	10.05	3.19	4.51	10

Aluminum Combination Conduit Bodies LR Type



To Provide Access to Conductors for Pulling, Splicing, and Maintenance. For Rigid, IMC & EMT Conduit

- Threaded for Rigid & IMC Conduits
- Set Screw for EMT Conduit
- RainTight when used with Gasketed Covers
- Die-Cast from High-Strength, Corrosion and Weather Resistant Copper Free Aluminum Alloy
- Flat Back Design for easy mounting close to walls

DIMENSIONS = INCHES

CAT. NO.	TRADE SIZE	DIMENSIONS-LR SERIES			BOX QTY
		A	B	C	
14264	1/2"	4.31	2.03	1.36	50
14265	3/4"	5.08	2.30	1.63	50
14266	1"	5.92	2.68	1.89	25
14267	1-1/4"	7.82	3.52	2.50	10
14268	1-1/2"	7.82	3.52	2.50	10
14269	2"	10.05	4.27	3.41	10
WITH COVER AND GASKET					
14270	1/2"	4.31	2.03	1.36	50
14271	3/4"	5.08	2.30	1.63	50
14272	1"	5.92	2.68	1.89	25
14273	1-1/4"	7.82	3.52	2.50	10
14274	1-1/2"	7.82	3.52	2.50	10
14275	2"	10.05	4.27	3.41	10

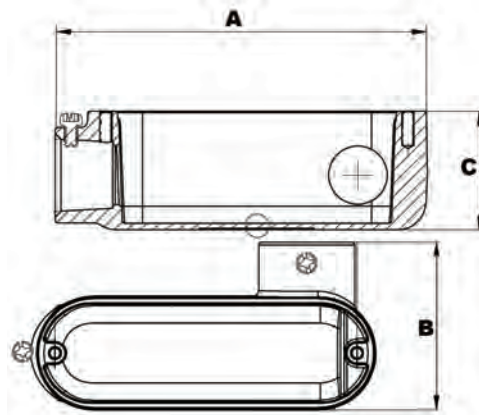

Aluminum Combination Conduit Bodies LL Type



To Provide Access to Conductors for Pulling, Splicing, and Maintenance. For Rigid, IMC & EMT Conduit

- Threaded for Rigid & IMC Conduits
- Set Screw for EMT Conduit
- RainTight when used with Gasketed Covers
- Die-Cast from High-Strength, Corrosion and Weather Resistant Copper Free Aluminum Alloy
- Flat Back Design for easy mounting close to walls

DIMENSIONS = INCHES

CAT. NO.	TRADE SIZE	DIMENSIONS-LL SERIES			BOX QTY
		A	B	C	
14276	1/2"	4.31	2.03	1.36	50
14277	3/4"	5.08	2.30	1.63	50
14278	1"	5.92	2.68	1.89	25
14279	1-1/4"	7.82	3.52	2.50	10
14280	1-1/2"	7.82	3.52	2.50	10
14281	2"	10.05	4.27	3.41	10
WITH COVER AND GASKET					
14282	1/2"	4.31	2.03	1.36	50
14283	3/4"	5.08	2.30	1.63	50
14284	1"	5.92	2.68	1.89	25
14285	1-1/4"	7.82	3.52	2.50	10
14286	1-1/2"	7.82	3.52	2.50	10
14287	2"	10.05	4.27	3.41	10

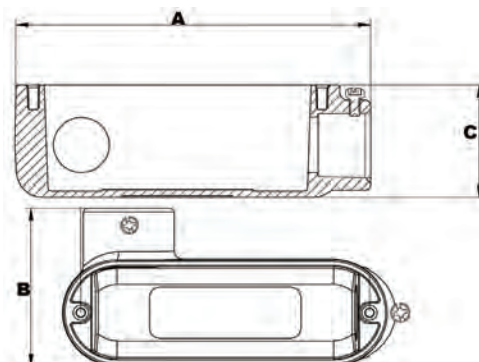

FITTINGS

Conduit Bodies

F8



Aluminum Combination Conduit Bodies C Type



To Provide Access to Conductors for Pulling, Splicing, and Maintenance. For Rigid, IMC & EMT Conduit



- Threaded for Rigid & IMC Conduits
- Set Screw for EMT Conduit
- RainTight when used with Gasketed Covers
- Die-Cast from High-Strength, Corrosion and Weather Resistant Copper Free Aluminum Alloy
- Flat Back Design for easy mounting close to walls

DIMENSIONS = INCHES

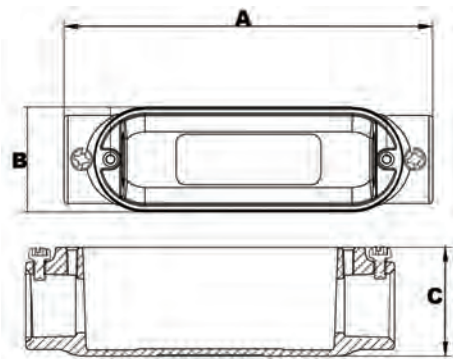

CAT. NO.	TRADE SIZE	DIMENSIONS-C SERIES			BOX QTY
		A	B	C	
14288	1/2"	4.72	1.34	1.36	50
14289	3/4"	5.51	1.56	1.63	50
14290	1"	6.46	1.82	1.89	25
14291	1-1/4"	8.35	2.51	2.50	10
14292	1-1/2"	8.35	2.51	2.50	10
14293	2"	10.55	3.19	3.41	10
WITH COVER AND GASKET					
14294	1/2"	4.72	1.34	1.36	50
14295	3/4"	5.51	1.56	1.63	50
14296	1"	6.46	1.82	1.89	25
14297	1-1/4"	8.35	2.51	2.50	10
14298	1-1/2"	8.35	2.51	2.50	10
14299	2"	10.55	3.19	3.41	10

Aluminum Service Entrance Condulets



- Tapered Threaded Hubs (NPT)
- Raintight with Gasketed covers
- Die Cast from High-Strength, Corrosion and Weather Resistant Copper Free Aluminum Alloy
- Flat Back Design for easy mounting close to walls

WITH GASKETED COVER

DIMENSIONS = INCHES

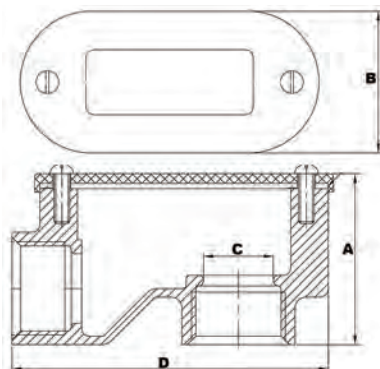

CAT. NO.	TRADE SIZE	DIMENSIONS				BOX QTY
		A	B	C	D	
14307	1/2"	1.59	1.38	.59	3.15	300
14308	3/4"	1.89	1.71	.78	3.58	175
14310	1-1/4"	2.05	1.93	1.00	4.17	60
14313*	1-1/4"	2.56	2.48	1.31	7.78	32
14314*	2"	3.68	3.13	1.99	10.10	12

*Extra Long

Steel Conduit Body Covers



- Used with Conduit Body to cover opening
- Assembled with captive zinc plated steel screws
- Raised Center to Accommodate Cable Bend Radius



DIMENSIONS = INCHES

CAT. NO.	TRADE SIZE	DIMENSIONS		INNER BOX	OUTER BOX
		A	B		
I4002	1/2"	3.90	1.34	25	250
I4003	3/4"	4.67	1.54	25	200
I4004	1"	5.37	1.79	10	100
I4005	1-1/4" - 1-1/2"	7.28	2.50	-	50
I4006	2"	9.49	3.15	-	50
I4007	2-1/2" - 3"	12.21	4.53	-	20
I4008	3-1/2" - 4"	14.96	5.51	-	10

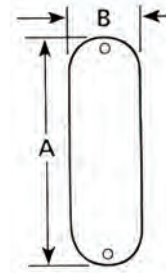

Aluminum Conduit Body Covers



- Used with Conduit Body to cover opening
- Stamped from high-strength corrosion and weather resistant copper-free aluminum alloy
- Assembled with captive zinc plated steel screws
- Raised Center to Accommodate Cable Bend Radius



DIMENSIONS = INCHES

CAT. NO.	TRADE SIZE	DIMENSIONS		INNER BOX	OUTER BOX
		A	B		
I4010	1/2"	3.88	1.34	10	250
I4011	3/4"	4.67	1.56	10	250
I4012	1"	5.39	1.77	10	100
I4013	1-1/4" - 1-1/2"	7.28	2.50	10	50
I4014	2"	9.47	3.13	10	50
I4015	2-1/2" - 3"	12.21	4.53	-	25
I4016	3-1/2" - 4"	14.96	5.51	-	20

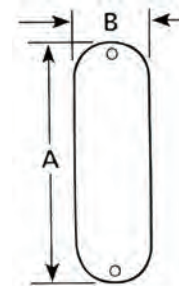

Neoprene Rubber Conduit Body Gasket

- Gasket used with Conduit Body for a rain tight seal
- Neoprene Rubber Material



DIMENSIONS = INCHES

CAT. NO.	TRADE SIZE	DIMENSIONS		INNER BOX	OUTER BOX
		A	B		
I4030	1/2"	3.90	1.34	100	1,000
I4031	3/4"	4.67	1.54	100	1,000
I4032	1"	5.37	1.73	50	500
I4033	1-1/4" - 1-1/2"	7.28	2.50	50	500
I4034	2"	9.49	3.15	30	300
I4035	2-1/2" - 3"	12.21	4.53	10	100
I4036	3-1/2" - 4"	14.96	5.51	10	100

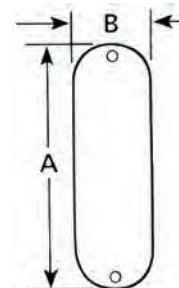

Malleable Rigid Set Screw Box Connector



- Connect Thread-less Rigid Conduit to boxes and enclosures
- Malleable Iron
- Concrete Tight
- Male Hub Thread (NPT)
- Zinc Finish

DIMENSIONS = INCHES

CAT. NO.	TRADE SIZE	DIMENSIONS			INNER BOX	OUTER BOX
		A	B	C		
I4340	1/2"	1.39	.455	1.10	25	250
I4341	3/4"	1.68	.500	1.39	25	250
I4342	1"	1.75	.500	1.61	25	100
I4343	1-1/4"	1.90	.66	1.90	5	50
I4344	1-1/2"	2.45	.66	2.22	5	50
I4345	2"	2.55	.68	2.75	-	20

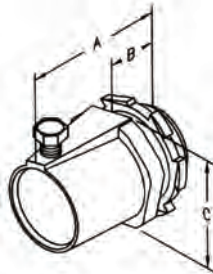

Malleable Rigid Set Screw Couplings



- Couple Sections of Thread-less Rigid Conduit together
- Malleable Iron
- Concrete Tight
- Zinc Finish

DIMENSIONS = INCHES

CAT. NO.	TRADE SIZE	DIMENSIONS				INNER BOX	OUTER BOX
		A	B	C	D		
I4350	1/2"	1.77	1.07	.86	.63	25	250
I4351	3/4"	2.13	1.35	1.05	.63	25	250
I4352	1"	2.62	1.59	1.36	.63	10	100
I4353	1-1/4"	2.81	1.91	1.69	.63	5	50
I4354	1-1/2"	2.91	2.01	1.90	.63	5	50
I4355	2"	3.38	2.70	2.40	.63	-	20
I4356	2-1/2"	3.73	3.45	2.92	.63	-	12
I4357	3"	4.10	3.95	3.52	.63	-	12
I4358	3-1/2"	4.52	4.45	4.10	.63	-	6
I4359	4"	5.62	5.01	4.52	.63	-	6

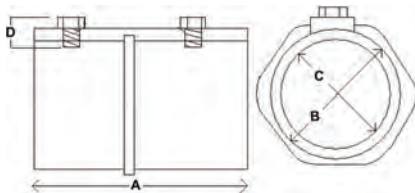

Rigid Short Radius Elbows

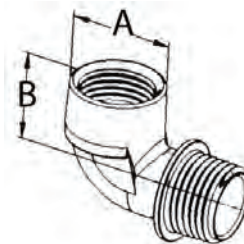

- For Connecting Rigid Conduit or IMC to an Outlet Box in Tight Radius Applications
- Zinc Die Cast

DIMENSIONS = INCHES

CAT. NO.	TRADE SIZE	DIMENSIONS		INNER BOX	OUTER BOX
		A	B		
I4408	1/2"	.95	.95	25	250
I4409	3/4"	1.16	1.00	15	150

Rigid Steel Compression Box Connector

NEW



AVAILABLE
JUNE 2020

- Connect Thread-less Rigid Conduit to boxes and enclosures
- Zinc Plated Steel
- Concrete Tight
- Male Hub Thread (NPT)

DIMENSIONS = INCHES

CAT. NO.	TRADE SIZE	DIMENSIONS			INNER BOX	OUTER BOX
		A	B	C		
14360	1/2"	1.39	.455	1.10	20	200
14361	3/4"	1.68	.500	1.39	10	100
14362	1"	1.75	.500	1.61	5	50
14363	1-1/4"	1.90	.66	1.90	5	50
14364	1-1/2"	2.45	.66	2.22	-	12
14365	2"	2.55	.68	2.75	-	12



Rigid Steel Compression Insulated Box Connector

NEW



- Connect Thread-less Rigid Conduit to boxes and enclosures
- Zinc Plated Steel
- Insulated Throat
- Concrete Tight
- Male Hub Thread (NPT)

DIMENSIONS = INCHES

CAT. NO.	TRADE SIZE	DIMENSIONS			INNER BOX	OUTER BOX
		A	B	C		
14370	1/2"	1.39	.455	1.10	20	200
14371	3/4"	1.68	.500	1.39	10	100
14372	1"	1.75	.500	1.61	5	50
14373	1-1/4"	1.90	.66	1.90	5	50
14374	1-1/2"	2.45	.66	2.22	-	12
14375	2"	2.55	.68	2.75	-	12



Rigid Steel Compression Couplings

NEW



- Couple Sections of Thread-less Rigid Conduit together
- Zinc Plated Steel
- Concrete Tight

DIMENSIONS = INCHES

CAT. NO.	TRADE SIZE	DIMENSIONS				INNER BOX	OUTER BOX
		A	B	C	D		
14380	1/2"	1.77	1.07	.86	.63	10	100
14381	3/4"	2.13	1.35	1.05	.63	10	100
14382	1"	2.62	1.59	1.36	.63	5	50
14383	1-1/4"	2.81	1.91	1.69	.63	5	50
14384	1-1/2"	2.91	2.01	1.90	.63	-	12
14385	2"	3.38	2.70	2.40	.63	-	5



Rigid Steel Couplings

NEW



AVAILABLE
JUNE 2020

- Connect Threaded Rigid Conduit
- Zinc Plated Steel
- Concrete Tight
- Male Hub Thread (NPT)

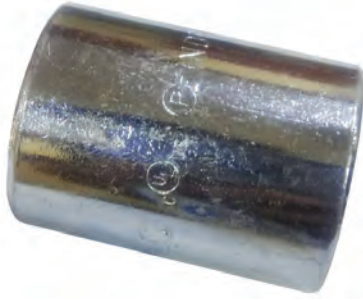

DIMENSIONS = INCHES

CAT. NO.	TRADE SIZE	DIMENSIONS		INNER BOX
		LENGTH	OD	
I4387	1/2"	1.63	1.01	100
I4388	3/4"	1.64	1.25	50
I4389	1"	1.97	1.53	30
I4390	1-1/4"	2.03	1.87	25
I4391	1-1/2"	2.06	2.16	25
I4392	2"	2.13	2.65	20
I4393	2-1/2"	3.19	3.25	12
I4394	3"	3.31	3.87	12
I4395	3-1/2"	3.41	4.50	12
I4396	4"	3.52	4.88	6
I4397	5"	3.95	6.00	3
I4398	6"	4.25	7.20	1

Malleable Rigid 3-Piece Couplings



- Used to Join 2 lengths of Threaded Conduit when Neither Can Be Rotated
- Threaded (NPT) for Rigid Conduit and IMC
- Concrete Tight

DIMENSIONS = INCHES

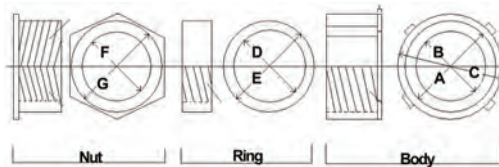

CAT. NO.	TRADE SIZE	DIMENSIONS							INNER BOX	OUTER BOX
		A	B	C	D	E	F	G		
I4440	1/2"	1.01	.869	1.30	.788	.981	.775	1.05	20	200
I4441	3/4"	1.20	1.10	1.55	.970	1.19	.965	1.25	10	100
I4442	1"	1.52	1.33	1.78	1.22	1.50	1.23	1.58	5	50
I4443	1-1/4"	1.91	1.69	2.20	1.58	1.85	1.56	1.90	5	50
I4444	1-1/2"	2.15	1.93	2.50	1.83	2.10	1.78	2.20	3	30
I4445	2"	2.65	2.40	3.08	2.25	2.58	2.25	2.75	-	20
I4446	2-1/2"	3.20	2.90	3.75	2.70	3.10	2.70	3.31	-	10
I4447	3"	3.85	3.58	4.40	3.35	3.82	3.30	4.40	-	5
I4448	3-1/2"	4.09	4.05	5.04	4.10	4.15	4.00	4.90	-	5
I4449	4"	4.89	4.55	5.40	4.30	4.85	4.33	5.02	-	2
I4450	5"	5.89	5.55	6.75	5.43	5.84	5.43	5.93	-	1
I4451	6"	6.93	6.62	7.62	6.50	6.81	6.50	6.87	-	1

Malleable Rigid Split Couplings

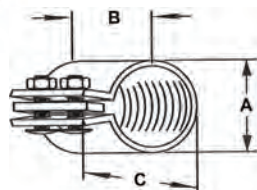

- A Speed Union for Economically Joining 2 Threaded Rigid Metal Conduits
- A Neoprene Gasket provides a Concrete Tight Seal at the Joint
- Use where Conduit Runs are Closely Spaced; or Conduit is tight against Wall, Ceiling or other Obstruction
- Use where Conduits Cannot be Rotated

DIMENSIONS = INCHES

CAT. NO.	TRADE SIZE	DIMENSIONS			INNER BOX	OUTER BOX
		A	B	C		
I4452	2"	2.75	2.04	3.30	-	25
I4453	2-1/2"	3.20	2.98	4.23	2	10
I4454	3"	3.85	3.14	4.85	2	10
I4455	3-1/2"	4.48	3.26	5.36	1	5
I4456	4"	4.83	3.34	6.07	1	5

Rigid to Rigid Pull Elbows - Zinc Die Cast



- For use as a Wire Pulling Elbow to Facilitate Wire Pulling on a Sharp Bend in run of Threaded Rigid or IMC Conduit
- Removable Cover allows easy access to facilitate wire pulling
- Furnished with Neoprene Gasket and Cover
- Rain Tight



DIMENSIONS = INCHES

CAT. NO.	TRADE SIZE	DIMENSIONS			OUTER BOX
		A	B	C	
I4400	1/2"	1.34	1.03	.97	100
I4401	3/4"	1.40	1.30	1.23	50
I4402	1"	1.97	1.55	1.51	30
I4403	1-1/4"	2.32	1.90	1.91	20

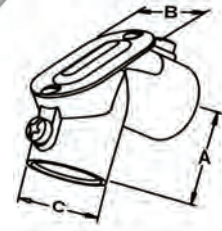

Rigid to Box Pull Elbows - Zinc Die Cast



- For Connecting Threaded Rigid Conduit or IMC to Box or Enclosures to Form 90° bend
- Removable Cover allows easy access to Facilitate Wire Pulling
- Furnished with Neoprene Gasket and Cover
- Rain Tight



DIMENSIONS = INCHES

CAT. NO.	TRADE SIZE	DIMENSIONS			OUTER BOX
		A	B	C	
I4404	1/2"	1.34	1.03	.97	100
I4405	3/4"	1.40	1.30	1.19	50
I4406	1"	1.97	1.55	1.51	30
I4407	1-1/4"	2.32	1.90	1.91	20

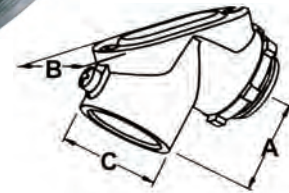

Straight Malleable Concrete Slab Inserts For Threaded Rigid Conduit



- Allows In-Slab Ceiling Drops & Floor Mounts in Poured Concrete
- Provides Flush Threaded Conduit Hub for mounting, pulling, & future access to conduit systems
- Design allows In-Slab Conduit System Prefabrication
- Designed for Straight Through Conduit Runs and Mounting of Floor boxes in slabs over 6" thick



DIMENSIONS = INCHES

CAT. NO.	TRADE SIZE	DIMENSIONS			OUTER BOX
		A	B	C	
I4420	1/2"	1.50	1.75	1.25	20
I4421	3/4"	2.72	2.00	1.75	20
I4422	1"	2.50	3.25	1.50	10

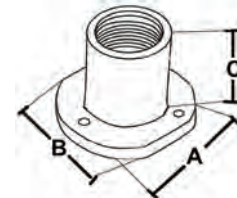

90° Malleable Concrete Slab Inserts For Threaded Rigid Conduit



- Allows In-Slab Ceiling Drops & Floor Mounts in Poured Concrete
- Provides Flush Threaded Conduit Hub for mounting, pulling, and future access to conduit systems
- Allows In-Slab Conduit System Prefabrication - Flush Design
- Designed to Eliminate Bending of conduit in slabs over 4" thick
- Designed for 90° Bends Through Conduit Runs

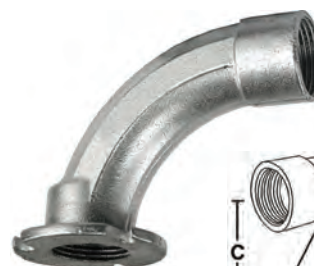

DIMENSIONS = INCHES

CAT. NO.	TRADE SIZE	DIMENSIONS				OUTER BOX
		A	B	C	D	
I4423	1/2"	1.50	1.75	3.12	3.62	20
I4424	3/4"	2.75	2.00	3.06	3.68	20
I4425	1"	2.50	3.75	2.93	3.68	10

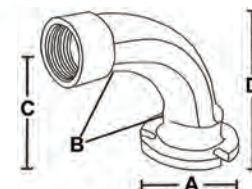

Rigid Offset Nipples - Zinc Die Cast

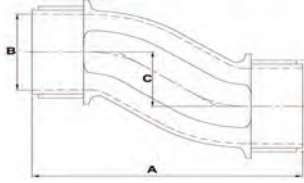

- Use as an Offset Connector between Two Enclosures
- To Offset the Axis of Raceways 3/4"

DIMENSIONS = INCHES

CAT. NO.	TRADE SIZE	DIMENSIONS			INNER BOX	OUTER BOX
		A	B	C		
I4460	1/2"	2.42	.59	.75	35	350
I4461	3/4"	2.42	.78	.75	20	200
I4462	1"	2.58	1.00	.75	15	150
I4463	1-1/4"	2.83	1.32	.75	5	50
I4464	1-1/2"	2.87	1.53	.75	5	50
I4465	2"	3.11	1.99	.75	3	30
I4466	2-1/2"	4.13	2.35	.75	-	18
I4467	3"	4.47	2.95	.75	-	15

1" Long Conduit Speed Nipple - Zinc Die Cast

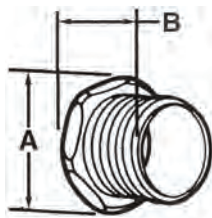

- Use with Rigid Coupling to Terminate Threaded Conduit to a Knockout, Box or Enclosure, where space is limited within the box
- Use with a Locknut to provide a Short Raceway between Boxes and enclosures

DIMENSIONS = INCHES

CAT. NO.	TRADE SIZE	DIMENSIONS		INNER BOX	OUTER BOX
		A	B		
I4502	1/2"	1.04	1.00	100	1,000
I4503	3/4"	1.34	1.00	50	500
I4504	1"	1.63	1.00	25	250

Rigid Nipples - Zinc Die Cast

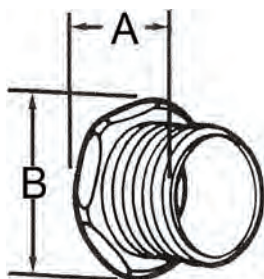

- Use with Rigid Coupling to Terminate Threaded Conduit to a Knockout, Box or Enclosure, where space is limited within the box
- Used with a Locknut to provide a Short Raceway between Boxes and Enclosures

DIMENSIONS = INCHES

CAT. NO.	TRADE SIZE	DIMENSIONS		INNER BOX	OUTER BOX
		A	B		
I4480	1/2"	.64	.98	100	1,000
I4481	3/4"	.72	1.18	100	1,000
I4482	1"	.81	1.50	50	500
I4483	1-1/4"	.94	1.77	25	250
I4484	1-1/2"	1.07	2.17	25	150
I4485	2"	1.08	2.60	15	90
I4486	2-1/2"	1.09	3.09	-	20
I4487	3"	1.25	3.71	-	20
I4488	3-1/2"	1.27	4.24	-	10
I4489	4"	1.27	4.70	-	10

Rigid Nipples with Insulated Throat - Zinc



- Use with Rigid Coupling to Terminate Threaded Conduit to a Knockout, Box or Enclosure where space is limited within the box
- Used with a Locknut to provide a Short Raceway between Boxes and Enclosures
- Insulated Throat

DIMENSIONS = INCHES

CAT. NO.	TRADE SIZE	DIMENSIONS		INNER BOX	OUTER BOX
		A	B		
I4490	1/2"	.68	.98	100	1,000
I4491	3/4"	.82	1.18	100	1,000
I4492	1"	.85	1.50	50	500
I4493	1-1/4"	1.00	1.77	25	250
I4494	1-1/2"	1.13	2.17	25	150
I4495	2"	1.14	2.60	15	90
I4496	2-1/2"	1.16	3.09	-	20
I4497	3"	1.33	3.71	-	20
I4498	3-1/2"	1.35	4.24	-	10
I4499	4"	1.35	4.70	-	10

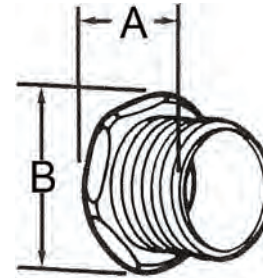

Rigid Steel Nipples

DIMENSIONS = INCHES

CAT. NO.	TRADE SIZE	INNER BOX
I4600	1/2" X CLOSE	25
I4601	1/2" X 1-1/2"	25
I4602	1/2" X 2"	25
I4603	1/2" X 3"	25
I4604	1/2" X 4"	25
I4610	3/4" X CLOSE	25
I4611	3/4" X 1-1/2"	25
I4612	3/4" X 2"	25
I4613	3/4" X 3"	25
I4614	3/4" X 4"	25
I4615	1" X CLOSE	25
I4616	1" X 2"	25
I4617	1" X 2 1/2"	25
I4618	1" X 3"	25
I4619	1" X 4"	25
I4635	1-1/4" X CLOSE	25
I4636	1-1/4" X 2"	25
I4637	1-1/4" X 3"	25
I4638	1-1/2" X CLOSE	25
I4639	1-1/2" X 2"	25
I4640	1-1/2" X 3"	25
I4641	1-1/2" X 4"	25
I4642	2" X CLOSE	25
I4643	2" X 3"	25
I4644	2" X 4"	25
I4645	2" X 5"	25
I4646	2" X 6"	25
I4655	3" X CLOSE	10
I4656	3" X 3"	10
I4657	3" X 4"	10
I4658	3" X 5"	10
I4659	3" X 6"	10
I4691	4" X CLOSE	10
I4693	4" X 4"	6
I4695	4" X 5"	5
I4697	4" X 6"	5

NEW

AVAILABLE
JUNE 2020



- Connect Threaded Rigid Conduit
- Zinc Plated Steel
- Concrete Tight
- Male Hub Thread (NPT)



FITTINGS

Rigid Nipples

F16

Conduit Bushings - Zinc Die Cast

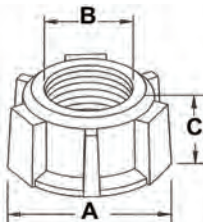

- Used with a locknut to terminate threaded Rigid and IMC conduit to a box or enclosure
- Bushings rounded surface prevents damage to wire insulation during pulling

DIMENSIONS = INCHES

CAT. NO.	TRADE SIZE	DIMENSIONS			INNER BOX	OUTER BOX
		A	B	C		
14530	1/2"	1.04	.59	.41	140	1400
14531	3/4"	1.28	.78	.43	100	1,000
14532	1"	1.54	1.00	.49	50	500
14533	1-1/4"	1.89	1.31	.51	30	300
14534	1-1/2"	2.17	1.53	.51	20	200
14535	2"	2.64	1.99	.51	15	150
14536	2-1/2"	3.19	2.39	.73	-	75
14537	3"	3.82	2.99	.73	-	65
14538	3-1/2"	4.31	3.47	.73	-	50
14539	4"	4.84	3.95	.73	-	40

Conduit Bushings with Insulated Throat - Zinc Die Cast

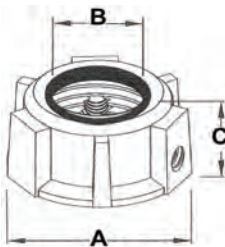

- Used with a locknut to terminate threaded Rigid and IMC conduit to a box or enclosure
- Bushings rounded surface prevents damage to wire insulation during pulling
- Insulated Throat

DIMENSIONS = INCHES

CAT. NO.	TRADE SIZE	DIMENSIONS			INNER BOX	OUTER BOX
		A	B	C		
14540	1/2"	1.06	.53	.45	140	1400
14541	3/4"	1.28	.78	.47	100	1,000
14542	1"	1.53	1.00	.53	50	500
14543	1-1/4"	1.89	1.31	.59	30	300
14544	1-1/2"	2.17	1.53	.59	20	200
14545	2"	2.64	1.99	.59	15	150
14546	2-1/2"	3.19	2.63	.79	-	75
14547	3"	3.82	2.95	.81	-	65
14548	3-1/2"	4.31	3.41	.81	-	50
14549	4"	4.84	3.91	.81	-	40

Grounding Bushing Insulated Throat with Aluminum Lug - Zinc

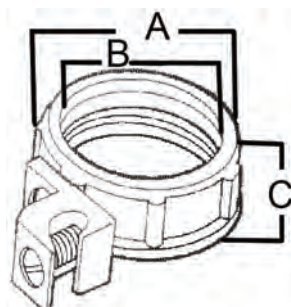

- Used with a locknut to terminate threaded Rigid & IMC conduit to a box or enclosure and to provide a smooth pulling surface
- Thermoplastic liner prevents damage to wire insulation
- Lug provides for bonding jumper to a neutral bus bar
- Resists corrosion, chemicals, and temperature extremes
- Set-screw provided with each fitting locks bushing in any desired position

DIMENSIONS = INCHES

CAT. NO.	TRADE SIZE	GROUNDING LUG RANGE	DIMENSIONS			INNER BOX	OUTER BOX
			A	B	C		
14570	1/2"	#14 - #4	1.06	.59	.53	50	500
14571	3/4"	#14 - #4	1.28	.78	.53	40	400
14572	1"	#14 - #4	1.53	1.00	.63	25	250
14574	1-1/4"	#14 - #4	1.87	1.31	.65	25	250
14576	1-1/2"	#14 - #2	2.17	1.52	.69	25	250
14578	2"	#14 - #2	2.66	1.99	.69	10	100
14579	2-1/2"	#14 - #1/0	3.23	2.34	.91	5	50
14581	3"	#14 - #1/0	3.84	2.95	.91	5	50
14583	3-1/2"	#14 - #2/0	4.33	3.39	.91	4	40
14585	4"	#14 - #2/0	4.84	3.86	.91	4	40

Thermoplastic Conduit Bushings



- Use to Protect Conductors in Rigid or IMC Conduit from Abrasion/Damage during Pull
- Rounded surface of bushing prevents damage to wire insulation
- Thermoplastic material-heat, impact & torque resistant

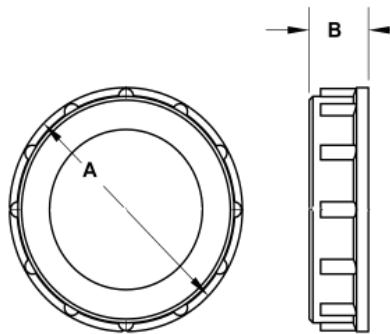

DIMENSIONS = INCHES

CAT. NO.	TRADE SIZE	DIMENSIONS		INNER BOX	OUTER BOX
		A	B		
21732	1/2"	1.06	0.43	100	1,000
21733	3/4"	1.31	0.43	100	1,000
21734	1"	1.59	0.48	50	500
21735	1-1/4"	1.96	0.56	25	250
21736	1-1/2"	2.18	0.56	25	250
21737	2"	2.68	0.59	20	200
21738	2-1/2"	3.25	0.72	-	50
21739	3"	3.87	0.75	-	25
21740	3-1/2"	4.37	0.77	-	25
21741	4"	5.00	0.77	-	10
21742	5"	6.25	1.00	-	10
21743	6"	7.50	1.00	-	10

Malleable Reducing Bushings

- Reduce the trade size of a tapered entry on a conduit fitting
- Threaded for rigid and IMC condulets, Hex Shoulder
- Rolled edge protects wire insulation

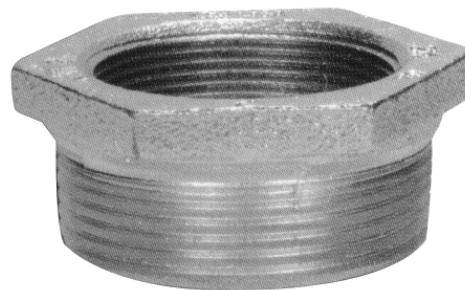
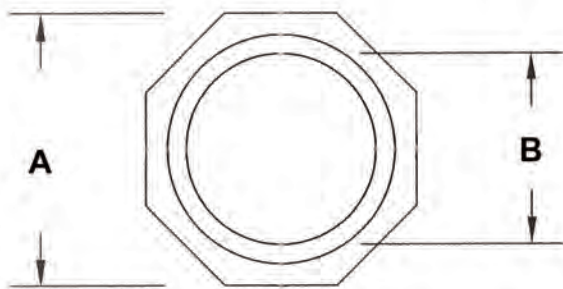

DIMENSIONS = INCHES

CAT. NO.	TRADE SIZE	DIMENSIONS		INNER BOX	OUTER BOX
		A	B		
14700	2-1/2" X 1"	2.83	1.22	-	10
14701	2-1/2" X 1-1/4"	2.83	1.58	-	10
14702	2-1/2" X 1-1/2"	2.83	1.83	-	10
14703	2-1/2" X 2"	2.83	2.28	-	10
14704	3-1/2" X 1-1/2"	3.45	1.83	-	10
14705	3-1/2" X 2"	3.45	2.28	-	10
14706	3-1/2" X 2-1/2"	3.96	2.70	-	10
14707	3-1/2" X 3"	3.96	3.35	-	10
14708	4" X 2-1/2"	4.45	2.70	-	10
14709	4" X 3-1/2"	4.45	4.10	-	10

Steel Reducing Bushings

- Reduce trade size of tapered entry on a conduit fitting
- Threaded for Rigid Conduit & IMC
- Rolled edge protects wire insulation

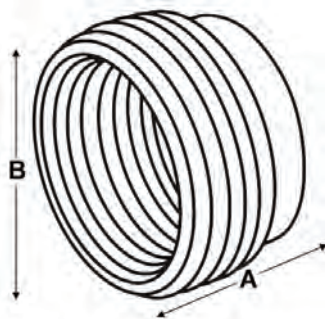

DIMENSIONS = INCHES

CAT. NO.	TRADE SIZE	DIMENSIONS		INNER BOX	OUTER BOX
		A	B		
I4660	1/2" X 3/8"	.63	.91	100	1,000
I4661	3/4" X 1/2"	.65	.93	100	1,000
I4662	1" X 1/2"	.72	1.13	50	500
I4663	1" X 3/4"	.72	1.13	50	500
I4664	1-1/4" X 1/2"	.82	1.47	10	100
I4665	1-1/4" X 3/4"	.82	1.47	25	250
I4666	1-1/4" X 1"	.81	1.47	25	250
I4667	1-1/2" X 1/2"	.85	1.70	10	100
I4668	1-1/2" X 3/4"	.85	1.70	25	100
I4669	1-1/2" X 1"	.85	1.70	25	100
I4670	1-1/2" X 1-1/4"	.85	1.70	10	250
I4671	2" X 1/2"	.97	2.23	10	40
I4672	2" X 3/4"	.97	2.23	10	40
I4673	2" X 1"	.97	2.23	10	40
I4674	2" X 1-1/4"	.97	2.23	10	100
I4675	2" X 1-1/2"	.97	2.23	10	100
I4676	3" X 1/2"	1.57	3.43	-	10
I4677	3" X 3/4"	1.57	3.43	-	10
I4678	3" X 1"	1.57	3.43	-	10
I4679	3" X 1-1/4"	1.57	3.43	-	10
I4680	3" X 1-1/2"	1.57	3.43	-	10
I4681	3" X 2"	1.57	3.43	-	10
I4682	3" X 2-1/2"	1.57	3.43	-	10
I4683	4" X 1/2"	1.68	4.43	-	5
I4684	4" X 3/4"	1.68	4.43	-	5
I4685	4" X 1"	1.68	4.43	-	5
I4686	4" X 1-1/4"	1.68	4.43	-	5
I4687	4" X 1-1/2"	1.68	4.43	-	5
I4688	4" X 2"	1.68	4.43	-	5
I4689	4" X 3"	1.68	4.43	-	5

Polypropylene Stud Bushings

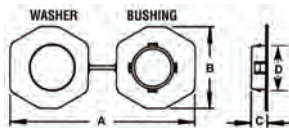

- Fits existing irregular shaped holes in metal studs
Alleviates the need to punch holes in metal studs, weakening the structural member
- Protects wire insulation from abrasion in metal studs
- Bushing allows smooth wire pulling
- No tools needed
- Use these bushings to comply with paragraph 300-4(b)(1) of the 2005 NEC code which states that: "In both exposed & concealed locations where nonmetallic-sheathed cables pass through either factory or field punched, cut, or drilled slots or holes in metal members, the cable shall be protected by bushings or grommets covering all metal edges & securely fastened in the opening prior to installation of the cable"

DIMENSIONS = INCHES

CAT. NO.	STUD SIZE	DIMENSIONS				BAG QTY
		A	B	C	D	
21760	2X4	5.67"	2.50"	.505"	1.30"	25

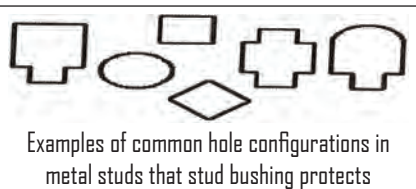

Snap Bushings



- Eliminate sharp edges & insulate your raw-edged holes in metal chassis
- Easily locks into hole firmly with fingertip pressure
- Protect electrical cables, ropes, utility lines passing through metal
- 1/8" maximum steel thickness
- Made from UL approved Nylon 6/6, 94V-2

DIMENSIONS = INCHES

CAT. NO.	MOUNTING HOLE DIAMETER	INSIDE DIAMETER	HEAD DIAMETER	OVERALL HEIGHT	BAG QTY
22311	.28	.23	.34	.24	10
22312	.31	.23	.37	.31	10
22314	.37	.25	.47	.41	10
22316	.50	.32	.57	.41	10
22317	.55	.45	.67	.41	10
22318	.63	.48	.73	.41	10
22320	.75	.56	.85	.41	10
22322	.87 (1/2" TRADE)	.68	.94	.45	10
22324	.99	.75	1.10	.45	10
22326	1.17	.95	1.31	.45	10
22328	1.50	1.14	1.62	.45	10
22330	1.72	1.39	1.88	.46	10
22332	1.97	1.64	2.15	.46	10

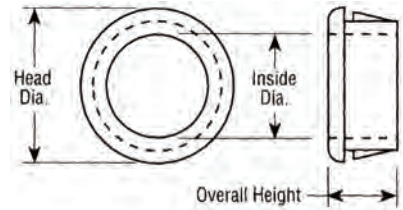

Snap Bushings with Shutters

- Flexible shutters to accommodate a variety of cable & hose sizes from a minimum of 1/8" to a maximum as shown in the table
- Shutters absorb vibration & cushion cables, tubes, etc.
- Fingertip pressure snap-locks the bushing into the mounting hole
- Universal design to hold various cable ranges
- 1/8" maximum steel thickness
- Made from UL approved Nylon 6/6, 94V-2

DIMENSIONS = INCHES

CAT. NO.	MOUNTING HOLE DIAMETER	MAX CABLE SIZE ID	HEAD DIAMETER	OVERALL HEIGHT	BAG QTY
22342	.63	.44	.72	.41	10
22344	.75	.50	.86	.39	10
22346	.81	.50	.89	.39	10
22348	.87 (1/2" TRADE)	.56	.93	.45	10
22350	1.00	.80	1.12	.44	10
22352	1.09 (3/4" TRADE)	.88	1.21	.44	10
22354	1.35 (1" TRADE)	1.15	1.48	.44	10
22356	1.50	1.22	1.61	.43	10

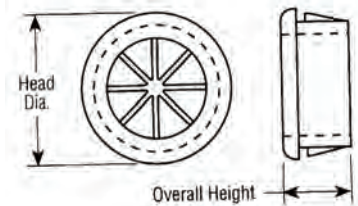

Snap Bushings (Open/Closed)

- Protect wires, tubing, etc. from sharp/uneven drilled & punched metal holes with smooth plastic chassis 1/8" maximum steel thickness
- Finger tip pressure snap-locks the bushing into the mounting hole
- Can be applied where cables are already installed
- Can accommodate cables too large to fit through the inside diameter of a standard bushing Made from UL approved Nylon 6/6, 94V-2

DIMENSIONS = INCHES

CAT. NO.	MOUNTING HOLE DIAMETER	INSIDE DIAMETER	HEAD DIAMETER	OVERALL HEIGHT	BAG QTY
22362	3/8	.26	.42	.375	10
22364	1/2	.31	.56	.375	10
22366	5/8	.45	.70	.375	10
22368	3/4	.52	.80	.375	10
22370	7/8	.67	.92	.375	10
22372	1	.80	1.06	.375	10

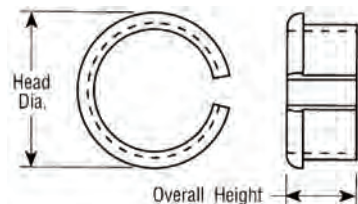

FITTINGS

Non-Metallic Bushings



Reducing Washers



FITTINGS

Washers/Locknuts

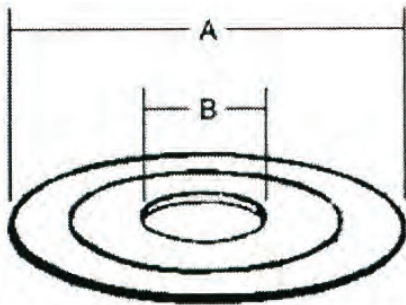

- Use to reduce the size of the knockout in a steel outlet box
- or other metal enclosure or cabinet
- Must use one inside the enclosure opening and one on the outside
- Galvanized Steel

DIMENSIONS = INCHES

CAT. NO.	TRADE SIZE	DIMENSIONS		INNER BOX	OUTER BOX
		A	B		
14620	3/4" X 1/2"	1.42	.87	100	1,000
14621	1" X 1/2"	1.71	.87	100	1,000
14622	1" X 3/4"	1.71	1.66	100	1,000
14623	1-1/4" X 1/2"	2.08	.87	50	500
14624	1-1/4" X 3/4"	2.08	1.125	50	500
14625	1-1/4" X 1"	2.08	1.38	50	500
14626	1-1/2" X 1/2"	2.635	.87	50	500
14627	1-1/2" X 3/4"	2.635	1.06	50	500
14628	1-1/2" X 1"	2.635	1.335	50	500
14629	1-1/2" X 1-1/4"	2.635	1.69	50	500
14630	2" X 1/2"	3.265	.87	25	250
14631	2" X 3/4"	3.265	1.06	25	250
14632	2" X 1"	3.265	1.335	25	250
14633	2" X 1-1/4"	3.265	1.69	25	250
14634	2" X 1-1/2"	3.265	1.935	25	250

Locknuts - Zinc Die Cast

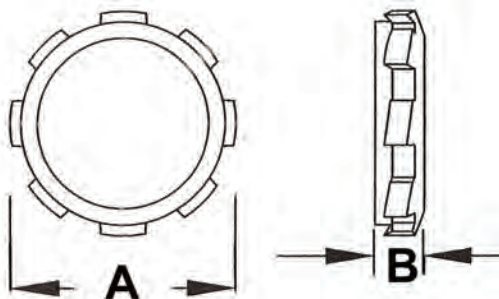

- Conduit locknuts for securing threaded conduit or connectors with tapered or straight thread, to a knockout or unthreaded slip hole

DIMENSIONS = INCHES

CAT. NO.	TRADE SIZE	DIMENSIONS		INNER BOX	OUTER BOX
		A	B		
14720	1/2"	1.08	0.14	100	4,000
14721	3/4"	1.36	0.14	100	2,500
14722	1"	1.69	0.20	50	1,000

Locknuts - Steel



- Conduit locknuts for securing threaded conduit or connectors with tapered or straight thread, to a knockout or unthreaded slip hole

DIMENSIONS = INCHES

CAT. NO.	TRADE SIZE	DIMENSIONS		INNER BOX	OUTER BOX
		A	B		
14730	1/2"	1.13	.13	100	1,000
14731	3/4"	1.38	.13	100	1,000
14732	1"	1.72	.17	50	500
14733	1-1/4"	2.06	.17	25	500
14734	1-1/2"	2.37	.17	25	200
14735	2"	2.89	.18	25	200
14736	2-1/2"	3.44	.18	25	100
14737	3"	4.11	.18	25	100
14738	3-1/2"	4.67	.18	25	100
14739	4"	5.24	.18	25	100
14740	5"	6.52	.39	-	20
14741	6"	7.84	.39	-	20

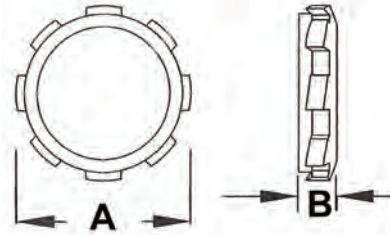

Sealing Locknuts - Steel

- Sealing locknuts provide a rain tight seal when securing threaded conduit or connectors with tapered or straight thread, to a knockout or unthreaded slip hole of a box or enclosure
- Integral Gasket

DIMENSIONS = INCHES

CAT. NO.	TRADE SIZE	DIMENSIONS		INNER BOX	OUTER BOX
		A	B		
14754	1/2"	1.14	.20	100	1,000
14755	3/4"	1.40	.20	100	1,000
14756	1"	1.73	.20	100	1,000
14757	1-1/4"	2.11	.22	50	500
14758	1-1/2"	2.40	.22	50	500
14759	2"	2.91	.22	25	250

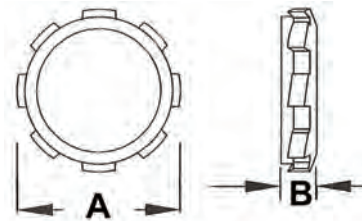

Grounding Locknuts - Steel

- Used with bushings to bond threaded rigid conduit and IMC to boxes, cabinets, or other enclosures where locknut is exposed

DIMENSIONS = INCHES

CAT. NO.	TRADE SIZE	DIMENSIONS		INNER BOX	OUTER BOX
		A	B		
14742	1/2"	1.14	.17	100	1,000
14743	3/4"	1.39	.18	100	1,000
14744	1"	1.73	.24	50	500
14745	1-1/4"	2.08	.24	25	200
14746	1-1/2"	2.40	.25	25	200
14747	2"	2.91	.29	25	100
14748	2-1/2"	3.46	.29	25	100
14749	3"	4.14	.30	25	100
14750	3-1/2"	4.69	.30	25	100
14751	4"	5.25	.34	25	100

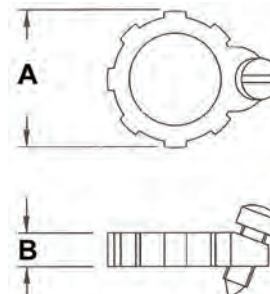

Rigid Water Tight Hubs - Zinc Die Cast



- To secure threaded rigid service entrance conduit & IMC to box or enclosure
- Assembled with 105°C rated flame retardant Lexan throat insulator and BUNA-N sealing ring that completely encircles knockout to prevent contaminants from entering enclosure
- UL Listed and CSA Certified for use in wet locations

DIMENSIONS = INCHES

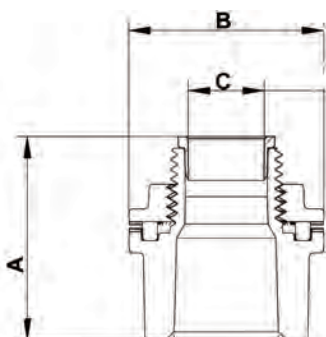

CAT. NO.	TRADE SIZE	DIMENSIONS			INNER BOX	OUTER BOX
		A	B	C		
14800	1/2"	1.49	1.43	.57	-	150
14801	3/4"	1.52	1.69	.73	-	120
14802	1"	1.80	1.99	.93	-	50
14803	1-1/4"	1.92	2.36	1.29	-	40
14804	1-1/2"	1.89	2.76	1.50	-	30
14805	2"	1.89	3.23	1.97	-	30
14806	2-1/2"	2.53	3.54	2.41	-	10
14807	3"	2.53	4.33	2.97	-	6
14808	3-1/2"	2.53	4.72	3.46	-	6
14809	4"	2.53	5.43	3.96	-	6

Rigid Water Tight Hubs with Bonding Screw - Zinc



- Male thread type
- Tapered female thread for Rigid conduit and IMC
- Recessed O-ring seal assures watertight connections
- Insulated throat and bonding locknut is suitable for service entrance application
- Assembled with 105°C rated flame retardant Lexan throat insulator and BUNA-N sealing ring
- UL Listed and CSA Certified for use in wet locations

DIMENSIONS = INCHES

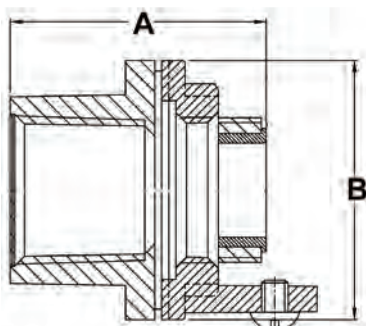

CAT. NO.	TRADE SIZE	DIMENSIONS		INNER BOX	OUTER BOX
		A	B		
14810	1/2"	1.42	1.22	25	250
14811	3/4"	1.61	1.50	25	150
14812	1"	1.87	1.89	25	100
14813	1-1/4"	2.01	2.24	10	60
14814	1-1/2"	2.12	2.52	10	60
14815	2"	2.20	3.03	10	40
14816	2-1/2"	2.64	3.54	-	12
14817	3"	2.64	4.07	-	12
14818	3-1/2"	2.70	4.78	-	6
14819	4"	2.70	5.35	-	6

EMT Set Screw Connectors - Zinc Die Cast



- Use to connect EMT Conduit to Steel Outlet Box, Load Center, or other Metal Enclosures
- Concrete Tight (When Taped)
- Die-Cast Zinc, Male hub threads NPS
- Pre-Set/Pre-Staked Combo Head Set-Screws
- UL Listed for EMT Conduit
- 2-1/2" - 4" are also UL Listed for use with Rigid & IMC
- 2-1/2" - 4" Uses 2 Set Screws



DIMENSIONS = INCHES

CAT. NO.	TRADE SIZE	DIMENSIONS			INNER BOX	OUTER BOX
		A	B	C		
14850	1/2"	1.06	.72	.59	50	500
14851	3/4"	1.25	.94	.78	25	250
14852	1"	1.46	1.18	1.00	25	200
14853	1-1/4"	1.93	1.53	1.32	10	100
14854	1-1/2"	2.09	1.76	1.53	10	60
14855	2"	2.36	2.22	1.99	5	40
14856	2-1/2"	2.95	2.92	2.35	-	12
14857	3"	3.15	3.55	2.95	-	12
14858	3-1/2"	3.52	4.05	3.43	-	6
14859	4"	3.62	4.55	3.91	-	6

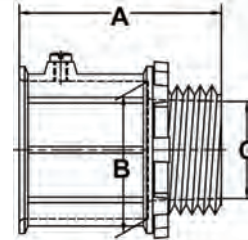

EMT Set Screw Connectors - Insulated Throat - Zinc Die Cast



- Use to connect EMT Conduit to Steel Outlet Box, Load Center, or other Metal Enclosures
- Insulated Throat
- Concrete Tight (When Taped)
- Die-Cast Zinc, Male hub threads NPS
- Pre-Set/Pre-Staked Combo Head Set-Screws
- UL Listed for EMT Conduit
- 2-1/2" - 4" are also UL Listed for use with Rigid & IMC
- 2-1/2" - 4" Uses 2 Set Screws



DIMENSIONS = INCHES

CAT. NO.	TRADE SIZE	DIMENSIONS			INNER BOX	OUTER BOX
		A	B	C		
14860	1/2"	1.14	.72	.59	50	500
14861	3/4"	1.33	.94	.78	25	250
14862	1"	1.54	1.18	1.00	25	200
14863	1-1/4"	1.99	1.53	1.32	10	100
14864	1-1/2"	2.13	1.76	1.53	10	60
14865	2"	2.44	2.22	1.99	5	40
14866	2-1/2"	3.03	2.92	2.34	-	12
14867	3"	3.22	3.55	2.88	-	12
14868	3-1/2"	3.58	4.05	3.31	-	6
14869	4"	3.72	4.55	3.86	-	6

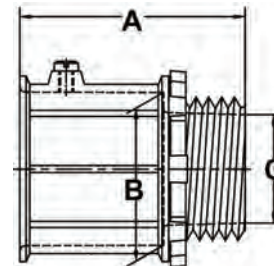

EMT Set Screw Couplings - Zinc Die Cast



- Use to connect EMT Conduit to EMT Conduit
- Concrete Tight (When Taped)
- Die-Cast Zinc
- Pre-set/Pre-staked Combo Head Set-screws
- UL Listed for EMT Conduit
- 2-1/2" - 4" are also UL Listed for use with Rigid & IMC
- 2-1/2" - 4" Uses 4 Set Screws



DIMENSIONS = INCHES

CAT. NO.	TRADE SIZE	DIMENSIONS		INNER BOX	OUTER BOX
		A	B		
14870	1/2"	1.38	.72	50	500
14871	3/4"	1.46	.94	25	250
14872	1"	1.98	1.18	20	200
14873	1-1/4"	2.52	1.53	10	100
14874	1-1/2"	2.95	1.76	10	60
14875	2"	3.43	2.22	5	20
14876	2-1/2"	3.94	2.92	-	12
14877	3"	4.33	3.55	-	12
14878	3-1/2"	4.88	4.05	-	6
14879	4"	5.14	4.55	-	6

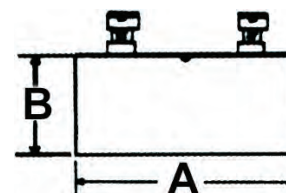



FITTINGS

EMT Steel Set Screw

F25

EMT Set Screw Connectors - Steel



- Use to Connect EMT Conduit to Steel Box, Load Center, or other Metal Enclosures
- Heavy Steel Walls
- Pre-Set/Pre-Staked Combo Head Set-Screws
- Male NPSM hub threads
- Concrete Tight (When Taped)
- UL Listed for EMT Conduit
- 2-1/2" - 4" are also for use with Rigid & IMC
- 2-1/2" - 4" Uses 2 Set Screws

DIMENSIONS - INCHES

CAT. NO.	TRADE SIZE	DIMENSIONS		INNER BOX	OUTER BOX
		A	B		
14880	1/2"	.84	1.47	50	500
14881	3/4"	1.06	1.57	25	250
14882	1"	1.32	1.86	20	200
14883	1-1/4"	1.68	2.24	-	25
14884	1-1/2"	1.91	2.24	-	25
14885	2"	2.37	2.35	-	20
14886	2-1/2"	3.14	2.89	-	12
14887	3"	3.77	2.95	-	12
14888	3-1/2"	4.28	3.23	-	4
14889	4"	4.78	3.33	-	8

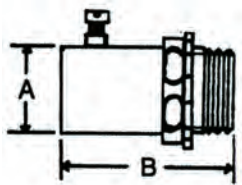

EMT Set Screw Connectors - Insulated Throat - Steel



- Use to Connect EMT Conduit to Steel Box, Load Center, or other Metal Enclosures
- Insulated Throat
- Heavy Steel Walls
- Pre-Set/Pre-Staked Combo Head Set-Screws
- Male NPSM hub threads
- Concrete Tight (When Taped)
- UL Listed for EMT Conduit
- 2-1/2" - 4" are also for use with Rigid & IMC
- 2-1/2" - 4" Uses 2 Set Screws

DIMENSIONS - INCHES

CAT. NO.	TRADE SIZE	DIMENSIONS		INNER BOX	OUTER BOX
		A	B		
14890	1/2"	.84	1.51	50	500
14891	3/4"	1.06	1.61	25	250
14892	1"	1.32	1.90	20	200
14893	1-1/4"	1.68	2.28	-	25
14894	1-1/2"	1.91	2.28	-	25
14895	2"	2.37	2.40	-	20
14896	2-1/2"	3.14	2.95	-	8
14897	3"	3.77	3.02	-	12
14898	3-1/2"	4.28	3.29	-	4
14899	4"	4.78	3.39	-	6

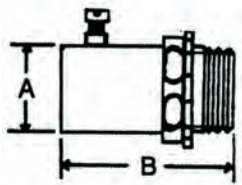

EMT Set Screw Couplings - Steel



- Use to Join Two Lengths of EMT Conduit together
- Heavy Steel Walls
- Pre-Set/Pre-Staked Combo Head Set-Screws
- Concrete Tight (When Taped)
- UL Listed for EMT Conduit
- 2-1/2" - 4" are also for use with Rigid & IMC
- 2-1/2" - 4" Uses 4 Set Screws

DIMENSIONS - INCHES

CAT. NO.	TRADE SIZE	DIMENSIONS		INNER BOX	OUTER BOX
		A	B		
14900	1/2"	.84	1.59	50	500
14901	3/4"	1.06	1.80	25	250
14902	1"	1.32	2.04	10	100
14903	1-1/4"	1.68	2.76	-	25
14904	1-1/2"	1.91	2.97	-	25
14905	2"	2.37	3.22	-	20
14906	2-1/2"	3.14	3.86	-	12
14907	3"	3.77	4.23	-	4
14908	3-1/2"	4.28	4.48	-	6
14909	4"	4.78	4.72	-	6

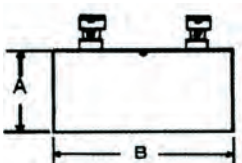

EMT Compression Connectors - Zinc Die Cast



- To secure and terminate EMT to knockouts in concrete tight box, dry or damp location applications
- Male NPSM hub threads
- Concrete tight
- UL Listed for EMT Conduit
- 2-1/2" - 4" are also UL Listed for use with Rigid & IMC

DIMENSIONS = INCHES

CAT. NO.	TRADE SIZE	DIMENSIONS			INNER BOX	OUTER BOX
		A	B	C		
14910	1/2"	1.24	.98	.59	50	500
14911	3/4"	1.26	1.22	.78	25	250
14912	1"	1.46	1.46	1.00	15	150
14913	1-1/4"	1.83	1.85	1.32	10	100
14914	1-1/2"	1.85	2.07	1.53	10	40
14915	2"	2.01	2.54	1.99	5	20
14916	2-1/2"	2.54	3.37	2.35	-	12
14917	3"	2.54	3.94	2.95	-	12
14918	3-1/2"	2.60	4.45	3.43	-	6
14919	4"	2.60	1.94	3.91	-	6

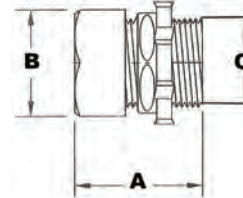

EMT Compression Connectors - Insulated Throat - Zinc Die Cast



- To secure and terminate EMT to knockouts in concrete tight box, dry or damp location application
- Male NPSM hub threads
- Concrete tight
- UL Listed for EMT Conduit
- 2-1/2" - 4" are also UL Listed for use with Rigid & IMC

DIMENSIONS = INCHES

CAT. NO.	TRADE SIZE	DIMENSIONS			INNER BOX	OUTER BOX
		A	B	C		
14920	1/2"	1.28	.98	.59	50	500
14921	3/4"	1.32	1.22	.78	25	250
14922	1"	1.52	1.46	1.00	15	150
14923	1-1/4"	1.89	1.85	1.32	10	100
14924	1-1/2"	1.91	2.07	1.53	10	40
14925	2"	2.09	2.54	1.99	5	20
14926	2-1/2"	2.62	3.37	2.35	-	12
14927	3"	2.62	3.94	2.95	-	12
14928	3-1/2"	2.68	4.45	3.43	-	6
14929	4"	2.68	4.94	3.91	-	6

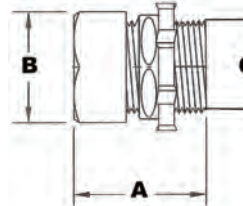

EMT Compression Couplings - Zinc Die Cast



- To join lengths of EMT for concrete tight, dry or damp location applications
- Concrete tight
- UL Listed for EMT Conduit
- 2-1/2" - 4" are also UL Listed for use with Rigid & IMC

DIMENSIONS = INCHES

CAT. NO.	TRADE SIZE	DIMENSIONS		INNER BOX	OUTER BOX
		A	B		
14930	1/2"	1.69	.98	50	500
14931	3/4"	1.73	1.22	25	250
14932	1"	1.85	1.46	15	150
14933	1-1/4"	2.36	1.85	10	100
14934	1-1/2"	2.40	2.07	10	50
14935	2"	2.44	2.54	5	20
14936	2-1/2"	3.15	3.37	-	12
14937	3"	3.15	3.94	-	12
14938	3-1/2"	3.27	4.45	-	6
14939	4"	3.27	4.94	-	6

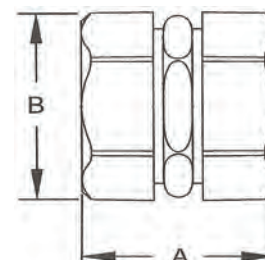



FITTINGS

EMT Steel Compression

F27

Steel EMT Compression Connectors

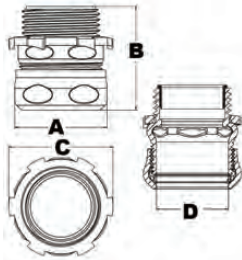

- Use to connect EMT conduit to steel outlet box, load center, or other metal enclosure
- Heavy Steel Walls, Zinc Plated
- Male hub threads - NPSM
- Concrete tight (When Taped)
- UL Listed for EMT Conduit
- 2-1/2" - 4" are also UL Listed for use with Rigid & IMC

DIMENSIONS = INCHES

CAT. NO.	TRADE SIZE	DIMENSIONS				INNER BOX	OUTER BOX
		A	B	C	D		
14940	1/2"	1.06	1.37	1.13	.73	25	250
14941	3/4"	1.30	1.46	1.38	.95	25	250
14942	1"	1.59	1.58	1.72	1.19	-	75
14943	1-1/4"	2.08	2.05	2.06	1.54	-	25
14944	1-1/2"	2.27	2.13	2.37	1.77	-	20
14945	2"	2.72	2.24	2.89	2.22	-	10
14946	2-1/2"	3.46	3.27	3.52	2.93	-	8
14947	3"	4.02	3.50	4.20	3.58	-	4
14948	3-1/2"	4.62	3.78	4.79	4.05	-	4
14949	4"	5.02	3.80	5.32	4.58	-	6

Steel EMT Compression Connectors - Insulated Throat

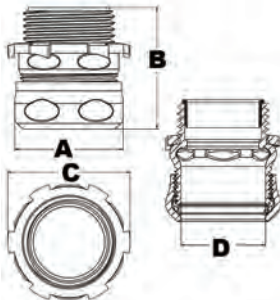

- Use to connect EMT conduit to steel outlet box, load center, or other metal enclosure
- Heavy Steel Walls, Zinc Plated
- Insulated throat
- Male hub threads - NPSM
- Concrete tight (When Taped)
- UL Listed for EMT Conduit
- 2-1/2" - 4" are also UL Listed for use with Rigid & IMC

DIMENSIONS = INCHES

CAT. NO.	TRADE SIZE	DIMENSIONS				INNER BOX	OUTER BOX
		A	B	C	D		
14950	1/2"	1.06	1.41	1.13	.73	25	250
14951	3/4"	1.30	1.50	1.38	.95	25	250
14952	1"	1.59	1.61	1.72	1.19	-	75
14953	1-1/4"	2.08	2.10	2.06	1.54	-	25
14954	1-1/2"	2.27	2.17	2.37	1.77	-	20
14955	2"	2.72	2.29	2.89	2.22	-	15
14956	2-1/2"	3.46	3.35	3.52	2.93	-	8
14957	3"	4.02	3.58	4.20	3.58	-	4
14958	3-1/2"	4.62	3.86	4.79	4.05	-	4
14959	4"	5.02	3.88	5.32	4.58	-	4

Steel EMT Compression Couplings

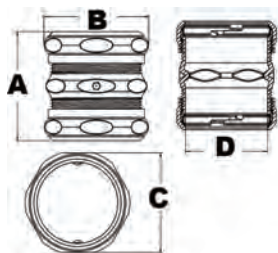

- Use to join to lengths of EMT conduit together
- Heavy Steel Walls, Zinc Plated
- Concrete tight (When Taped)
- UL Listed for EMT Conduit
- 2-1/2" - 4" are also UL Listed for use with Rigid & IMC

DIMENSIONS = INCHES

CAT. NO.	TRADE SIZE	DIMENSIONS				INNER BOX	OUTER BOX
		A	B	C	D		
14960	1/2"	1.72	1.06	1.00	.73	25	250
14961	3/4"	1.73	1.30	1.22	.95	25	250
14962	1"	1.91	1.59	1.48	1.19	10	100
14963	1-1/4"	2.53	2.08	1.93	1.54	-	25
14964	1-1/2"	2.62	2.27	2.16	1.77	-	20
14965	2"	2.78	2.72	2.57	2.22	-	10
14966	2-1/2"	3.94	3.70	3.46	2.93	-	8
14967	3"	4.17	4.38	4.02	3.58	-	4
14968	3-1/2"	4.70	4.68	4.62	4.05	-	4
14969	4"	4.96	5.40	5.02	4.58	-	6

Steel EMT Rain Tight Compression Connectors



- Use to connect EMT conduit to steel outlet box, load center, or other metal enclosure in a dry or wet location
- Internal Sealing Ring & Knockout Gasket create Raintight Seal
- Heavy Steel Walls, Zinc Plated
- Concrete Tight
- UL Listed for EMT Conduit
- 2-1/2" - 4" are also UL Listed for use with Rigid & IMC

DIMENSIONS = INCHES

CAT. NO.	TRADE SIZE	DIMENSIONS			INNER BOX	OUTER BOX
		A	B	C		
14970	1/2"	1.14	.51	1.08	50	500
14971	3/4"	1.42	.51	1.35	25	250
14972	1"	1.58	.57	1.65	10	100
14973	1-1/4"	1.60	.61	2.02	10	100
14974	1-1/2"	1.93	.63	2.24	10	50
14975	2"	2.23	.67	2.80	5	50
14976	2-1/2"	2.80	.83	3.60	-	12
14977	3"	3.00	.83	4.25	-	12
14978	3-1/2"	3.35	.83	4.80	-	6
14979	4"	3.47	.83	5.24	-	6

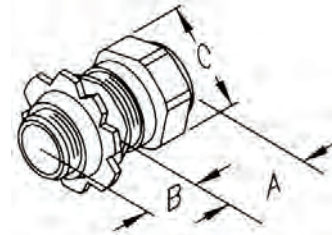

Steel EMT Rain Tight Compression Connectors-Insulated Throat



- Use to connect EMT conduit to steel outlet box, load center, or other metal enclosure in dry or wet location
- Internal Sealing Ring & Knockout Gasket create Raintight Seal
- Heavy Steel Walls, Zinc Plated
- Insulated throat
- Concrete Tight
- UL Listed for EMT Conduit
- 2-1/2" - 4" are also UL Listed for use with Rigid & IMC

DIMENSIONS = INCHES

CAT. NO.	TRADE SIZE	DIMENSIONS			INNER BOX	OUTER BOX
		A	B	C		
14980	1/2"	1.18	.51	1.08	50	500
14981	3/4"	1.46	.51	1.35	25	250
14982	1"	1.61	.57	1.65	10	100
14983	1-1/4"	1.69	.61	2.02	10	100
14984	1-1/2"	2.00	.61	2.24	10	50
14985	2"	2.36	.67	2.76	5	50
14986	2-1/2"	2.87	.83	3.62	-	12
14987	3"	3.07	.83	4.25	-	12
14988	3-1/2"	3.42	.83	4.80	-	6
14989	4"	3.54	.83	5.24	-	6

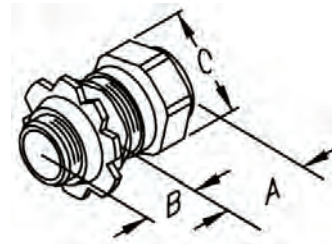

Steel EMT Compression Rain Tight Couplings



- Use to connect two lengths of EMT conduit together in a dry or wet location
- Internal Sealing Ring creates Rain Tight Seal
- Heavy Steel Walls, Zinc Plated
- Concrete Tight
- UL Listed for EMT Conduit
- 2-1/2" - 4" are also UL Listed for use with Rigid & IMC

DIMENSIONS = INCHES

CAT. NO.	TRADE SIZE	DIMENSIONS		INNER BOX	OUTER BOX
		A	B		
14990	1/2"	1.81	1.08	50	500
14991	3/4"	1.89	1.35	25	250
14992	1"	2.30	1.65	10	100
14993	1-1/4"	2.68	2.02	10	100
14994	1-1/2"	2.74	2.24	10	50
14995	2"	2.95	2.76	5	50
14996	2-1/2"	3.90	3.62	-	12
14997	3"	4.11	4.25	-	12
14998	3-1/2"	4.53	4.80	-	6
14999	4"	4.65	5.24	-	6

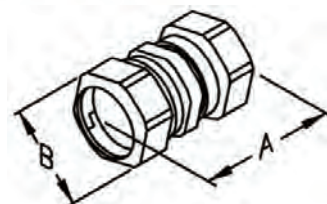

EMT To Box Offset Set Screw Connector - Zinc Die Cast

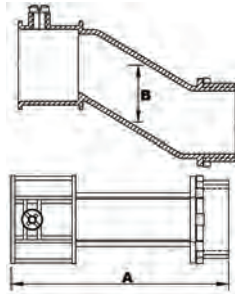

- Use to connect EMT conduit to a Metal Box or Enclosure where Offset is Required
- Zinc Die-Cast
- Combo Head Set-Screw
- Assembled with Zinc Die Cast Locknut
- Concrete Tight (When Taped)

DIMENSIONS = INCHES

CAT. NO.	TRADE SIZE	DIMENSIONS		INNER BOX	OUTER BOX
		A	B		
15010	1/2"	2.11	.37	20	200
15011	3/4"	2.85	.75	10	100
15012	1"	3.14	1.19	-	100

EMT To Box Offset Compression Connector - Zinc Die Cast

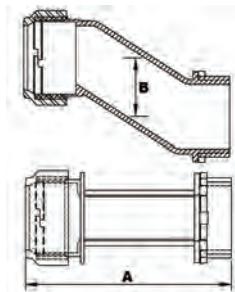

- Use to connect EMT conduit to a Metal Outlet Box or Enclosure where an Offset is Required
- Zinc Die-Cast
- Compression Style
- Assembled with Zinc Die Cast Locknut
- Concrete Tight (When Taped)

DIMENSIONS = INCHES

CAT. NO.	TRADE SIZE	DIMENSIONS		INNER BOX	OUTER BOX
		A	B		
15014	1/2"	2.11	.37	20	200
15015	3/4"	2.88	.75	10	100

EMT to EMT Inside Corner Set Screw Pulling Elbows

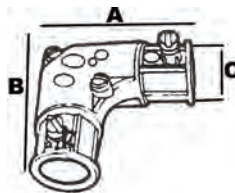

- Use to Connect EMT Conduit together on a 90° Inside Corner
- Combo Head Set Screws
- Zinc Die Cast

DIMENSIONS = INCHES

CAT. NO.	TRADE SIZE	DIMENSIONS			INNER BOX	OUTER BOX
		A	B	C		
15020	1/2"	2.32	2.32	.59	10	100
15021	3/4"	2.64	2.64	.78	5	50
15022	1"	2.94	2.94	1.19	-	50

EMT Insulating Bushings

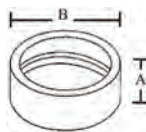

- EMT Insulating Bushings protect cables from abrasion
- Fast & Easy press-on installation

DIMENSIONS = INCHES

CAT. NO.	TRADE SIZE	DIMENSIONS		BAG QTY
		A	B	
21700	1/2"	.522	.570	100
21701	3/4"	.538	.764	50
21702	1"	.614	.954	25
21703	1-1/4"	.620	1.26	25
21704	1-1/2"	.620	1.44	25
21705	2"	.620	1.86	20
21706	2-1/2"	1.12	2.34	-
21707	3"	1.19	2.78	-
21708	3-1/2"	1.22	3.27	-
21709	4"	1.22	3.71	-

- Meets NEC Article 300-15C requirements
- Listed for use in environmental air handling spaces per 2005 NEC code requirements 300-22C
- Polyethylene rated at 194°F(90°C)

EMT To BOX Set Screw Pulling Elbows - Zinc Die Cast



- Used to Connect EMT to a Metal Box/Enclosure at a 90° Bend
- Removable Aluminum Cover and Neoprene Gasket facilitates wire pulling
- Zinc Die Cast
- Assembled with Zinc Die Cast locknut
- Combo Head Set Screws

DIMENSIONS = INCHES

CAT. NO.	TRADE SIZE	DIMENSIONS		OUTER BOX
		A	B	
15030	1/2"	1.34	.97	100
15031	3/4"	1.40	1.26	50
15032	1"	1.97	1.51	30
15033	1-1/4"	2.32	1.91	20

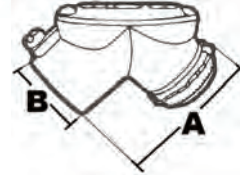

EMT To EMT Set Screw Pulling Elbows - Zinc Die Cast



- Used to Connect EMT together at a 90° bend
- Zinc Die Cast
- Removable Aluminum Cover and Neoprene Gasket facilitates wire pulling
- Combo Head Set Screws

DIMENSIONS = INCHES

CAT. NO.	TRADE SIZE	DIMENSIONS				OUTER BOX
		A	B	C	D	
15035	1/2"	1.34	.97	2.56	1.78	100
15036	3/4"	1.40	1.26	2.81	2.15	50
15037	1"	1.97	1.51	3.88	3.17	30
15038	1-1/4"	2.32	1.91	4.62	3.25	20

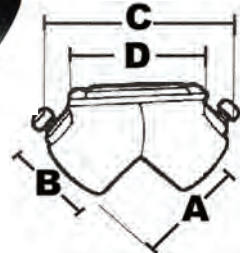

EMT/RIGID To BOX Combination Pulling Elbow - Zinc Die Cast



- Used to Connect a run of EMT, Threaded Rigid or IMC conduit to a Box at a 90° Bend
- Threaded and Set Screw Conduit Entrance
- Removable Aluminum Cover and Neoprene Gasket facilitates wire pulling
- Assembled with Zinc Die Cast Locknut
- Combo Head Set Screws

DIMENSIONS = INCHES

CAT. NO.	TRADE SIZE	DIMENSIONS				INNER BOX	OUTER BOX
		A	B	C	D		
15040	1/2"	1.31	1.01	2.40	1.78	20	200
15041	3/4"	1.44	1.19	2.66	2.14	15	150
15042	1"	1.94	1.53	3.66	3.24	6	60

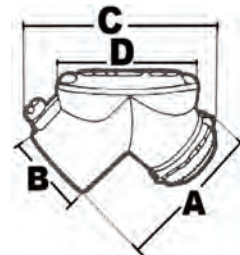

EMT/RIGID To EMT/RIGID Combination Pulling Elbow - Zinc



- Used to facilitate pulling conductors through a sharp bend in a run of EMT, Threaded Rigid or IMC conduit
- Threaded and Set Screw Conduit Entrance
- Removable Aluminum Cover and Neoprene Gasket facilitates wire pulling
- Combo Head Set Screws

DIMENSIONS = INCHES

CAT. NO.	TRADE SIZE	DIMENSIONS				INNER BOX	OUTER BOX
		A	B	C	D		
15044	1/2"	1.37	1.01	2.63	1.78	20	200
15045	3/4"	1.43	1.23	2.73	2.14	15	150

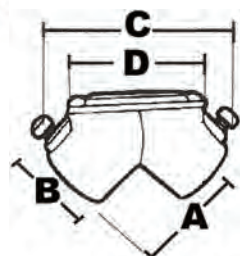

EZfitt Snap-In Range Taking Box Connectors

NEW

UL US LISTED



FIG. 1



FIG. 2

- Use to Connect AC, MC, MCI-A, HCF steel and aluminum cable, Flexible Metal Conduit, Steel and Aluminum MCI cable, Continuous Corrugated Aluminum
- Suitable for 14-2 to 10/3 Steel & Aluminum Armored Cable
- Cable Range: .405" thru .612"
- Zinc Die Cast, Spring Steel mechanism, Polycarbonate Insulator
- Cat# 15046 Includes insulated throat
- Cat# 15047 rated for use with MC-PSC Cable
- UL 514B Listed

DIMENSIONS = INCHES

CAT. NO.	FIGURE	TRADE SIZE	CABLE TYPES	DIMENSIONS					INNER BOX	OUTER BOX
				A	B	C	D	E		
15046	1	3/8"	14/2, 14/3, 14/4, 12/2, 12/3, 12/4, 10/2, 10/3	1.54	.86	.37	1.00	.61	50	500
15047*	2	3/8"	14/2, 14/3, 14/4, 12/2, 12/3, 12/4, 10/2, 10/3	1.53	.86	-	1.00	.61	50	500

*CAT# 15047 RATED FOR USE WITH MC-PCS CABLE

EZfitt Snap-In Double Barrel Range Taking Box Connectors

UL US LISTED

NEW



- Use to Connect AC, MC, MCI-A, HCF steel and aluminum cable, Flexible Metal Conduit, Steel and Aluminum MCI cable, Continuous Corrugated Aluminum
- Suitable for 14-2 to 10/3 Steel & Aluminum Armored Cable
- Cable Range: .505" thru .705"
- Zinc Die Cast, Spring Steel mechanism, Polycarbonate Insulator
- Cat# 15048 Includes insulated throat
- Cat# 15049 rated for use with MC-PSC Cable
- UL 514B Listed

DIMENSIONS = INCHES

CAT. NO.	TRADE SIZE	CABLE TYPES	DIMENSIONS					INNER BOX	OUTER BOX
			A	B	C	D	E		
15049	3/8"	14/2, 14/3, 14/4, 12/2, 12/3, 12/4, 10/2, 10/3	1.76	1.38	.60	.89	.83	50	500
15050*	3/8"	14/2, 14/3, 14/4, 12/2, 12/3, 12/4, 10/2, 10/3	1.01	1.54	.63	.92	.83	50	500

*CAT# 15049 RATED FOR USE WITH MC-PCS CABLE

EZfitt Snap-In Box Connectors

UL US LISTED

NEW



- Use to Connect AC, MC, MCI-A, HCF steel and aluminum cable, Flexible Metal Conduit, Steel and Aluminum MCI cable, Continuous Corrugated Aluminum
- Suitable for 12/2 Steel & Aluminum Armored Cable
- Cable Range: .405" thru .612"
- Zinc Die Cast, Spring Steel mechanism, Polycarbonate Insulator

DIMENSIONS = INCHES

CAT. NO.	TRADE SIZE	CABLE TYPES	DIMENSIONS					INNER BOX	OUTER BOX
			A	B	C	D	E		
15048	3/8"	12/2, 12/3	1.41	.85	.32	1.00	.52	50	500

BX/Flex Set Screw Box Connectors - Zinc Die Cast



- Use to connect 1/2 BX cable to a Steel Box or other Metal Enclosure
- Suitable for #14-2 Steel armored cable
- 3/8" size - fits 1/2" Knockout
- Furnished with Zinc Die-Cast locknuts
- Combo Head Screws

DIMENSIONS = INCHES

CAT. NO.	TRADE SIZE	DIMENSIONS			INNER BOX	OUTER BOX
		A	B	C		
15052	3/8"	.79	.97	.39	50	500

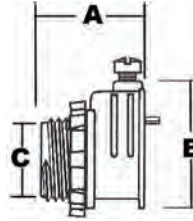

Flex Angled Set Screw Box Connectors - Zinc Die Cast



- Use to connect Steel or Aluminum Flexible Metallic Conduit to a Steel Box or other Metal Enclosure
- Angled Combo Head Set Screw for Easy Access
- Furnished with Die Cast Zinc locknuts

DIMENSIONS = INCHES

CAT. NO.	TRADE SIZE	DIMENSIONS		INNER BOX	OUTER BOX
		A	B		
15055	3/8"	.95	1.00	40	400
15053	1/2"	1.20	1.46	25	250
15054	3/4"	1.33	1.56	25	250

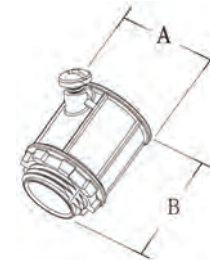

Flex 2 Set Screw - Strap Type Multi-Purpose Box Connectors



- Terminate flexible metallic conduit FMC, AC, MC, or NM cable to a Steel box or other enclosure:
 - 1/2, 12/2 or 12/3 NM Cable
 - 1/2 Thru 12/4 AC or MC Cable
 - 3/8" FMC
- 3/8" Trade Size fits a 1/2" knockout
- Male Hub - NPSM Thread
- Combination Head Screws
- Zinc Die Cast

DIMENSIONS = INCHES

CAT. NO.	TRADE SIZE	DIMENSIONS		INNER BOX	OUTER BOX
		A	B		
15058	3/8"	1.18	.80	100	1,000

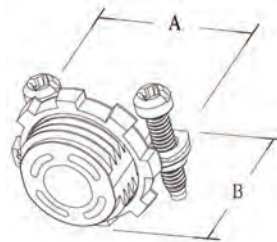

Flex Saddle Box Connector For AC & MC Flex Conduits - Zinc



- Use to connect flexible metal conduit, AC, MC and NM sheathed cable to a Steel Box or other Metal Enclosure
- 3/8" size fits 1/2" knockout
- End Stopped
- Combo Head Screws
- Zinc Die Cast

DIMENSIONS = INCHES

CAT. NO.	TRADE SIZE	DIMENSIONS			INNER BOX	OUTER BOX
		A	B	C		
15060	3/8"	1.09	1.70	.96	500	500

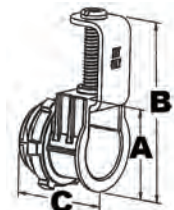



Flex Duplex Box Connectors - Zinc Die Cast



FIG 1

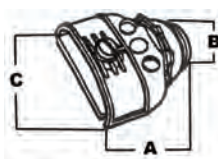

FIG 1

- Use to connect two pieces of Flexible Metallic Conduit, AC, MC, or NM sheathed cable to a steel box or other metal enclosure when using only one knockout opening:
 - 14/2 Thru 12/3 NM
 - 14/2 Thru 10/4 AC
 - 14/2 Thru 10/3 MC
 - 3/8" FMC
- 3/8" size fits 1/2" knockout
- One Screw or Two Screw design



FIG 2

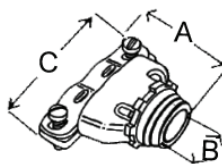
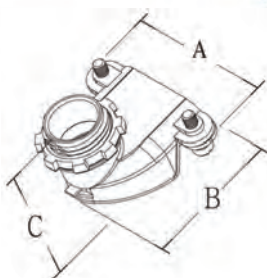

FIG 2

DIMENSIONS = INCHES

CAT. NO.	TRADE SIZE	FIGURE	# OF SCREWS	DIMENSIONS			INNER BOX	OUTER BOX
				A	B	C		
15065	3/8"	1	1	1.43	.61	1.61	25	250
15066	3/8"	2	2	1.57	.61	2.32	25	250

90° Flex Conduit Duplex Box Connector - Zinc Die Cast



- Use to connect two pieces of Flexible Metallic Conduit, AC, MC or NM sheathed cable to a steel outlet box or other metal enclosure when using only one knockout opening in a dry location:
 - 14/2 Thru 10/3 NM
 - 14/2 Thru 10/4 AC
 - 14/2 Thru 10/3 MC
 - 3/8" FMC
- 3/8" size fits 1/2" knockout
- Two Combo Head Mounting Screws

DIMENSIONS = INCHES

CAT. NO.	TRADE SIZE	DIMENSIONS			INNER BOX	OUTER BOX
		A	B	C		
15067	3/8"	2.02	1.64	1.24	25	250

Anti-Short Bushings

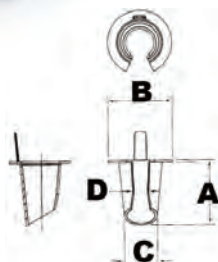

- Insulates conductor from cut armor ends on flexible BX or Greenfield conduit
- Inserted into I.D. at termination point
- Overlapping horizontal flange protects against sharp metal edges
- Tapered design assures fast insertion
- Extra length assures positive grip
- Polypropylene material resists weather extremes, oil, moisture and chemicals
- Rated up to 194°F

DIMENSIONS = INCHES

CAT. NO.	SIZE	CABLE SIZES	DIMENSIONS				BAG QTY
			A	B	C	D	
21752	0	14/2, 14/3, 12/2	.56"	.67"	.38"	.312"	35
21753	1	14/4, 12/3, 6/1, 4/1	.65"	.67"	.45"	.312"	35
21754	2	12/4, 10/2, 10/3, 2/1	.61"	.859"	.58"	.125"	35
21755	3	10/4, 8/2, 8/3, 1/1	.67"	1.046"	.79"	.109"	20
21756	4	8/4, 6/4, 6/3, 6/2, 4/3, 4/2	.83"	1.266"	1.00"	.156"	16

Screw-In Connector For Greenfield/Flex Conduit



- Use to connect Flexible Metallic Conduit to steel outlet box, load center or other metal enclosure
- Zinc Die Cast
- Assembled with Zinc Die Cast locknut

DIMENSIONS = INCHES

CAT. NO.	TRADE SIZE	DIMENSIONS			INNER BOX	OUTER BOX
		A	B	C		
15070	3/8"	1.22	.38	1.1	80	800
15071	1/2"	1.30	.64	1.1	60	600
15072	3/4"	1.52	.81	1.38	35	350
15073	1"	1.87	1.00	1.70	15	150
15074	1-1/4"	2.13	1.27	2.1	10	100
15075	1-1/2"	2.32	1.51	2.42	6	60
15076	2"	2.48	2.02	2.98	3	30

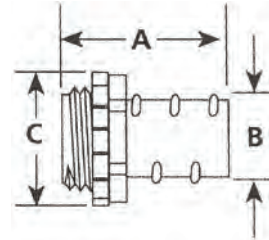

Screw-In Connector Insulated Throat For Greenfield/Flex Conduit



- Use to connect Flexible Metallic Conduit to steel outlet box, load center or other metal enclosure
- Insulated Throat
- Zinc Die Cast
- Assembled with Zinc Die Cast locknut

DIMENSIONS = INCHES

CAT. NO.	TRADE SIZE	DIMENSIONS			INNER BOX	OUTER BOX
		A	B (OD)	C		
15077	3/8"	1.26	.38	1.10	80	800
15078	1/2"	1.34	.64	1.10	60	600
15079	3/4"	1.56	.81	1.38	35	350
15080	1"	1.91	1.00	1.70	15	150
15081	1-1/4"	2.17	1.27	2.10	10	100
15082	1-1/2"	2.36	1.51	2.42	6	60
15083	2"	2.52	2.02	2.98	3	30

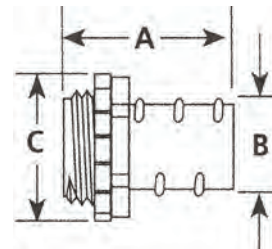

Screw-In Couplings For Greenfield/Flex Conduit



- Use to connect two pieces of Flexible Metal Conduit
- Zinc Die Cast

DIMENSIONS = INCHES

CAT. NO.	TRADE SIZE	DIMENSIONS			INNER BOX	OUTER BOX
		A	B	C		
15084	1/2"	1.81	.91	.20	40	400
15085	3/4"	2.09	1.10	.24	25	250
15086	1"	2.40	1.36	.32	15	150
15087	1-1/4"	2.76	1.66	.32	10	100
15088	1-1/2"	3.08	1.93	.32	6	60
15089	2"	3.32	2.48	.32	3	30

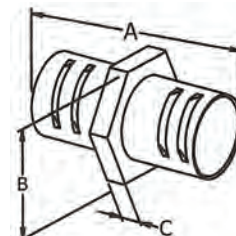

Straight Squeeze Box Connectors



BX - Flex - MC FITTINGS

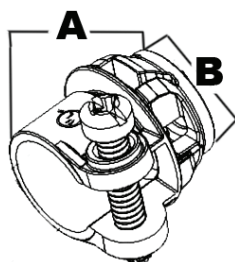

- Used with a locknut to terminate steel or aluminum Flexible Metal Conduit, Armored Cable & MC to enclosure
- Assembled with Zinc Die Cast Locknut & Combo Screws

DIMENSIONS = INCHES

CAT. NO.	TRADE SIZE	DIMENSIONS		INNER BOX	OUTER BOX
		A	B		
15110	3/8"	1.00	.35	50	500
15111	1/2"	1.38	.59	25	250
15112	3/4"	1.54	.77	25	250
15113	1"	1.76	.98	-	100
15114*	1-1/4"	1.82	1.21	-	100
15115*	1-1/2"	1.92	1.41	-	50
15116*	2"	2.03	1.95	4	40
15117*	2-1/2"	3.00	2.32	-	10
15118*	3"	3.38	2.82	-	10
15119*	3-1/2"	3.78	3.28	-	10
15120*	4"	4.16	3.76	-	10

* Flexible Metal Conduit Only

Straight Squeeze Box Connectors - Insulated Throat

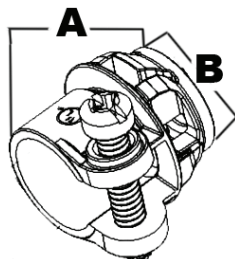

- Used with a locknut to terminate steel or aluminum Flexible Metal Conduit, Armored Cable & MC to Enclosure
- Insulated Throat
- Assembled with Zinc Die Cast Locknut & Combo screws

DIMENSIONS = INCHES

CAT. NO.	TRADE SIZE	DIMENSIONS		INNER BOX	OUTER BOX
		A	B		
15121	1/2"	1.42	.54	25	250
15122	3/4"	1.57	.70	25	250
15123	1"	1.80	.92	10	100
15124*	1-1/4"	1.88	1.65	10	100
15125*	1-1/2"	1.98	1.97	5	50
15126*	2"	2.09	2.47	4	40
15127*	2-1/2"	3.08	2.32	-	18
15128*	3"	3.46	2.82	-	12
15129*	3-1/2"	3.86	3.28	-	8
15130*	4"	4.24	3.76	-	8

* Flexible Metal Conduit Only

F35

Squeeze Box Connectors 90°

NEW



- Used with a locknut to Terminate Steel or Aluminum Flexible Metal Conduit, AC and MC Cable to a steel outlet box or other metal enclosure
- Assembled with Zinc Die Cast Locknut & Combo Screws

DIMENSIONS = INCHES

CAT. NO.	TRADE SIZE	DIMENSIONS					INNER BOX	OUTER BOX
		A	B	C	D	E		
15131	3/8"	1.22	1.34	.63	.97	1.89	50	500
15132	1/2"	1.50	1.65	.63	.97	2.07	25	250
15133	3/4"	1.58	1.89	.86	1.20	2.38	10	100
15134	1"	2.26	2.38	1.04	1.45	3.04	5	50
15135*	1-1/4"	2.76	2.68	1.42	1.86	4.08	10	40
15136*	1-1/2"	4.06	3.76	1.58	2.32	6.56	2	12
15137*	2"	4.08	3.76	2.07	2.66	6.69	2	12
15138*	2-1/2"	6.90	5.40	2.50	3.07	3.98	-	10
15139*	3"	7.80	5.70	3.15	3.71	4.80	-	6
15140*	3-1/2"	9.40	7.52	3.46	4.53	5.66	-	3
15141*	4"	10.50	8.28	3.94	5.04	6.24	-	3

* Flexible Metal Conduit Only

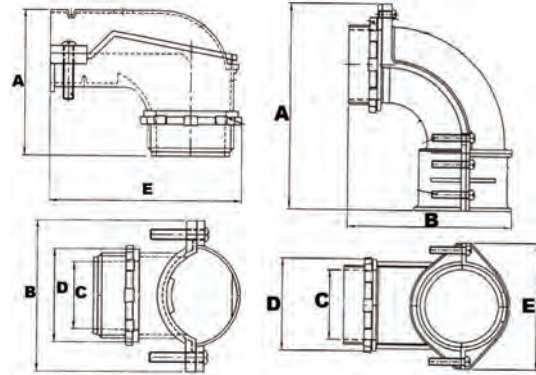

3/8" - 2"

2-1/2" - 4"

Squeeze Box Connectors 90° - Insulated Throat



- Used with a locknut to Terminate Steel or Aluminum Flexible Metal Conduit, AC and MC Cable to a steel outlet box or other metal enclosure
- Insulated Throat
- Assembled with Zinc Die Cast Locknut & Combo Screws

DIMENSIONS = INCHES

CAT. NO.	TRADE SIZE	DIMENSIONS					INNER BOX	OUTER BOX
		A	B	C	D	E		
15142	3/8"	1.26	1.34	.55	.97	1.89	50	500
15143	1/2"	1.54	1.65	.55	.97	2.07	25	250
15144	3/4"	1.61	1.89	.73	1.20	2.38	10	100
15145	1"	2.26	2.38	.96	1.46	2.99	5	50
15146*	1-1/4"	2.82	2.68	1.24	1.81	4.02	10	40
15147*	1-1/2"	4.08	3.76	1.44	2.32	6.46	2	12
15148*	2"	4.08	3.76	1.89	2.58	6.69	2	12
15149*	2-1/2"	6.90	5.40	2.30	3.07	3.92	-	6
15150*	3"	7.80	5.70	2.95	3.70	4.72	-	4
15151*	3-1/2"	9.40	7.52	3.27	4.53	5.57	-	3
15152*	4"	10.50	8.26	3.74	5.04	6.14	-	3

* Flexible Metal Conduit Only

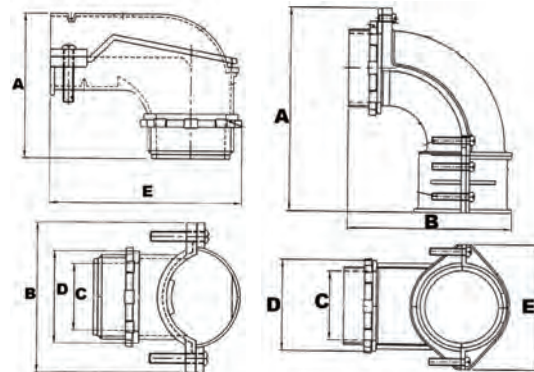

3/8" - 2"

2-1/2" - 4"



EMT to Flex Combination Coupling Squeeze Type - Zinc Die Cast



- Use to join EMT Conduit to Flexible Metal Conduit
- They allow a quick connection between different conduits to create one continuous raceway
- Their smooth interior surface ensures a snag free wire pull every time
- Pre-set and staked Robertson combo head screws

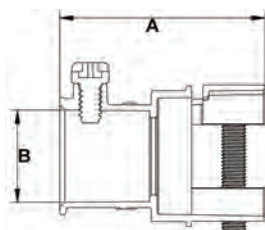

DIMENSIONS = INCHES

CAT. NO.	TRADE SIZE	DIMENSIONS		INNER BOX	OUTER BOX
		A	B		
15416	1/2"	1.65	.72	25	250
15417	3/4"	1.76	.95	15	150
15418	1"	2.15	1.19	-	200

EMT to BX or NM Cable Combination Set Screw Couplings



- Set Screw 1/2" EMT to 2 Screw 3/8" BX/NM Cable
- Used on EMT Conduit, BX cable, NM cable
- They allow a quick connection between different conduits to create one continuous raceway
- Zinc Die Cast

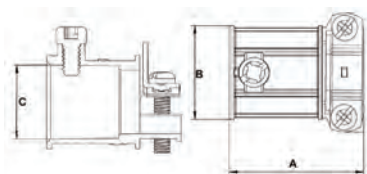

DIMENSIONS = INCHES

CAT. NO.	TRADE SIZE	DIMENSIONS			INNER BOX	OUTER BOX
		A	B	C		
15411	1/2"	1.33	.93	.73	50	500

EMT to Greenfield Combination Compression Couplings



- To join EMT to Flexible Metallic Conduit
- Compression for EMT and Screw-In for Flex Conduit
- Zinc Die Cast

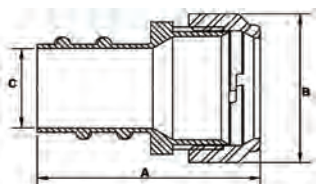

DIMENSIONS = INCHES

CAT. NO.	TRADE SIZE	DIMENSIONS			INNER BOX	OUTER BOX
		A	B	C		
15420	1/2"	1.61	.98	.57	50	500
15421	3/4"	1.87	1.20	.73	25	250
15422	1"	1.96	1.43	.92	10	100

Cord Grips - Zinc Die Cast

- Use to Connect S, SD, ST, SJ, SJD and SJT Cord to a Steel Outlet Box or other Metal Enclosure
- Neoprene Grommet for a moisture proof seal
- Simple Installation, cord can be installed without disassembly of the fitting
- Liquid-tight/Oil-tight/Rain-tight
- Suitable for NEMA 4 Enclosures and other wet locations
- Male Tapered NPT Threading
- Colored Seal allows for Easy Identification

DIMENSIONS = INCHES

CAT. NO.	TRADE SIZE	INSERT COLOR	CABLE RANGE		OVERALL DIM.		INNER BOX	OUTER BOX
			C	A	B			
15450	1/2"	RED	.190 - .260	1.22	1.14	25	250	
15451	1/2"	BLUE	.260 - .375	1.22	1.14	25	250	
15452	1/2"	GREEN	.375 - .500	1.22	1.14	25	250	
15453	3/4"	GREEN	.375 - .500	1.34	1.20	25	250	
15454	3/4"	BROWN	.500 - .625	1.34	1.20	25	250	
15455	3/4"	ORANGE	.625 - .725	1.34	1.20	25	250	
15457	1"	BROWN	.500 - .650	1.42	1.69	10	100	
15458	1"	ORANGE	.625 - .750	1.42	1.69	10	100	
15459	1"	BLACK	.750 - .880	1.42	1.69	10	100	
15460	1"	PURPLE	.880 - .985	1.42	1.69	10	100	

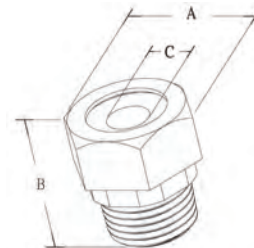

Metal Cable Glands - NPT Thread

- Used to introduce cables or leads into metal housings, or to introduce reinforced cables
- Designed for use in areas of zone 1(2G) and 21(ID) with no risk of explosion and for cables with and without reinforcement
- In case of systems or housing manufactured according to NEC, the line or the connecting cable must be introduced by conduits, mounting fittings, etc. with NPT threads
- Working Temp: -40°F to 212°F
- Brass Nickel Plated
- IP 68 (NEMA 6P) rated - Submersible & Dustproof

DIMENSIONS = INCHES

CAT. NO.	CABLE RANGE	DIMENSIONS			INNER BAG QTY	OUTER BOX QTY
		D1 THREAD	GL (INCHES)	H (INCHES)		
22600	.16" - .32"	3/8"	.59	.83	100	1,500
22601	.24" - .48"	1/2"	.51	.94	100	800
22602	.40" - .55"	1/2"	.51	.94	50	600
22603	.51" - .71"	3/4"	.51	.98	50	500
22604	.71" - .99"	1"	.67	1.14	25	400

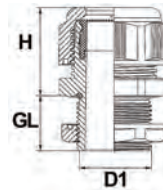

Metal Cable Glands - Metric Thread

- Cable Glands with Metric threads are now standard and replacements for the PG Cable Glands
- Used to introduce cables or leads into metal housings or to introduce reinforced cables
- Designed for use in areas of zone 1(2G), and 21(ID) with no risk of explosion and for cables with and without reinforcement
- Working Temp: -40°F to 212°F
- Brass Nickel Plated
- IP 68 (NEMA 6P) rated - Submersible & Dustproof

DIMENSIONS = INCHES

CAT. NO.	CABLE RANGE	DIMENSIONS			INNER BAG QTY	OUTER BOX QTY
		D1 THREAD	GL (INCHES)	H (INCHES)		
22590	.12" - .26"	M12	.26	.75	100	2,000
22591	.16" - .32"	M16	.24	.83	100	1,500
22592	.20" - .40"	M16	.24	.83	100	1,000
22593	.24" - .48"	M20	.24	.91	100	800
22594	.40" - .55"	M20	.24	.91	50	600
22595	.51" - .71"	M25	.28	1.02	50	500
22596	.71" - .99"	M32	.31	1.22	20	400
22597	.87" - 1.26"	M40	.31	1.46	10	160
22598	1.26" - 1.50"	M50	.35	1.46	10	120
22599	1.46" - 1.73"	M63	.39	1.50	10	80

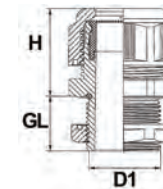

Nylon Cable Glands - NPT Thread

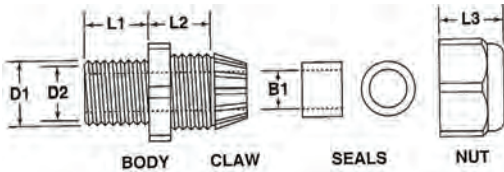

- Seal & Clamp System allows cord connector to tighten in a Circular Sequence on the sealing ring to give Superior Strain Relief without twisting or damaging the cable
- Simply push the cable through the liquid-tight nylon strain relief & tighten nut for quick installation
- Threads into your panel for clearance, locknut included
- Internal Ratchet with Self-Locking Feature protects against vibration
- 'Collet' Design Accommodates Various Size Cords, Cables, Tubing, etc.
- Nylon Body Material is resistant to most common chemicals & solvents
- For Best Results, Use the Minimum Size that accommodates your cable
- No Disassembly Required
- Made of UL approved NYLON 66, 94V-2 (Black)
- IP68 Rated Submersible & Dustproof
- UL Recognized
- 94V-2 Flame Rating, -22°F to 140°F Temp Rating
- Locknut Not Included (Sold Separately)

DIMENSIONS = INCHES

CAT. NO.	NPT THREAD	CABLE RANGE	D1	D2	B1	L1	L2	L3	BAG QTY	MASTER BAG QTY
22550	1/4-18	.118" - .256"	.520"	.327"	.236"	.299"	.500"	.520"	10	100
22551	3/8-18	.197" - .394"	.646"	.421"	.354"	.575"	.539"	.661"	10	100
22552	1/2-14	.394" - .551"	.815"	.587"	.500"	.492"	.740"	.724"	10	100
22553	3/4-14	.512" - .709"	1.008"	.728"	.650"	.575"	.701"	.878"	10	100
22554	1-11.5	.709" - .984"	1.299"	1.024"	.933"	.579"	.811"	1.071"	10	100
22555	1-1/4-11.5"	.866" - 1.260"	1.642"	1.260"	1.142"	.705"	.882"	1.236"	10	100

Nylon Cable Glands - NPT Thread - 90°

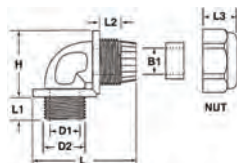

- Same features as Nylon Cable Gland above
- 90° Orientation
- UV Resistant Black
- 94V-2 Flame Rating, -22°F to 140°F Temp Rating
- IP68 Rated Submersible & Dustproof

DIMENSIONS = INCHES

CAT. NO.	NPT THREAD	CABLE RANGE	MOUNTING HOLE DI	D2	B1	L1	L2	L3	L	H	BAG QTY	MASTER BAG QTY
22582	3/8-18	.02-.35"	.47"	.65"	.37"	.46"	.39"	.66"	1.91"	1.18"	10	100
22584	1/2-1/4	.39-.51"	.55"	.83"	.51"	.58"	.46"	.72"	2.03"	1.23"	10	100
22586	3/4-1/4	.51-.63"	.76"	1.04"	.65"	.58"	.49"	.88"	2.54"	1.64"	10	100
22588	1-1/4-11.5	.87-1.14"	1.24"	1.64"	1.15"	.74"	.64"	1.22"	3.35"	2.09"	10	100

Nylon NPT Lock Nuts

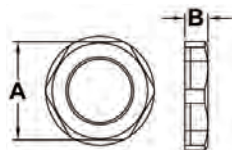

- Nylon 66 Material
- NPT Thread
- Hexagonal Head
- UL 94 V-2 Flame Rating

DIMENSIONS = INCHES

CAT. NO.	TRADE SIZE	DIMENSIONS		BOX QTY
		W	H	
22556	1/4"	.67	.19	50
22557	3/8"	.87	.20	50
22558	1/2"	1.06	.24	50
22559	3/4"	1.30	.28	50
22560	1"	1.66	.32	25
22561	1-1/4"	1.92	.35	10

Nylon Cable Glands - Multi-Conductor - NPT Thread

- Same features as Nylon Cable Gland on previous page
- Multi-Hole Design organizes Multiple Cables within a Gland
- Easy to Assemble
- Wide Clamping Range
- -22°F to 140°F Temperature Rating
- UV Resistant Black
- Made of UL Approved NYLON 66
- Flammability Rating: 94V-2
- IP68 Rated Submersible & Dustproof
- Locknut Not Included (Sold Separately)



DIMENSIONS - INCHES

CAT. NO.	NPT THREAD	CABLE RANGE	DI	LI	BAG QTY	MASTER BAG
2 HOLE GLAND						
22230	1/4-18	.078 - .122	.52	.31	10	100
22231	3/8-18	.064 - .102	.66	.57	10	100
22232	3/8-18	.078 - .122	.66	.57	10	100
22233	3/8-18	.119 - .161	.66	.57	10	100
22234	1/2-14	.064 - .102	.83	.51	10	100
22235	1/2-14	.098 - .138	.83	.51	10	100
22236	1/2-14	.130 - .170	.83	.51	10	100
22237	1/2-14	.157 - .240	.83	.51	10	100
22238	3/4-14	.098 - .138	1.04	.57	10	100
22239	3/4-14	.138 - .200	1.04	.57	10	100
22240	3/4-14	.200 - .256	1.04	.57	10	100
22241	3/4-14	.252 - .343	1.04	.57	10	100
22242	1-11.5	.142 - .205	1.31	.59	10	100
22243	1-11.5	.200 - .256	1.31	.59	10	100
22244	1-11.5	.252 - .343	1.31	.59	10	100
22245	1-11.5	.303 - .394	1.31	.59	10	100
22246	1-1/4-11.5	.276 - .354	1.65	.72	10	100
22247	1-1/4-11.5	.433 - .512	1.65	.72	10	100
3 HOLE GLAND						
22248	1/4-18	.063 - .102	.52	.31	10	100
22249	3/8-18	.063 - .102	.66	.57	10	100
22250	3/8-18	.118 - .165	.66	.57	10	100
22251	1/2-14	.078 - .118	.83	.51	10	100
22252	1/2-14	.118 - .165	.83	.51	10	100
22253	1/2-14	.138 - .205	.83	.51	10	100
22254	3/4-14	.102 - .142	1.04	.57	10	100
22255	3/4-14	.142 - .205	1.04	.57	10	100
22256	3/4-14	.189 - .244	1.04	.57	10	100
22257	3/4-14	.244 - .315	1.04	.57	10	100
22258	1-11.5	.142 - .205	1.31	.59	10	100
22259	1-11.5	.189 - .244	1.31	.59	10	100
22260	1-11.5	.244 - .315	1.31	.59	10	100
22261	1-11.5	.303 - .394	1.31	.59	10	100
22262	1-1/4-11.5	.256 - .327	1.65	.72	10	100
22263	1-1/4-11.5	.303 - .394	1.65	.72	10	100
4 HOLE GLAND						
22264	1/4-18	.051 - .091	.52	.31	10	100
22265	3/8-18	.051 - .091	.66	.57	10	100
22266	3/8-18	.094 - .134	.66	.57	10	100
22267	1/2-14	.055 - .094	.83	.51	10	100
22268	1/2-14	.094 - .134	.83	.51	10	100
22269	1/2-14	.134 - .189	.83	.51	10	100
22270	3/4-14	.063 - .098	1.04	.57	10	100
22271	3/4-14	.098 - .142	1.04	.57	10	100
22272	3/4-14	.150 - .205	1.04	.57	10	100
22273	3/4-14	.220 - .287	1.04	.57	10	100
22274	1-11.5	.079 - .122	1.31	.59	10	100
22275	1-11.5	.118 - .161	1.31	.59	10	100
22276	1-11.5	.150 - .205	1.31	.59	10	100
22277	1-11.5	.220 - .287	1.31	.59	10	100
22278	1-11.5	.276 - .354	1.31	.59	10	100
22279	1-1/4-11.5	.394 - .472	1.65	.72	10	100

DIMENSIONS - INCHES

CAT. NO.	NPT THREAD	CABLE RANGE	DI	LI	BAG QTY	MASTER BAG
5 HOLE GLAND						
22280	3/8-18	.079 - .110	.66	.57	10	100
22281	1/2-14	.051 - .079	.83	.51	10	100
22282	1/2-14	.079 - .110	.83	.51	10	100
22283	1/2-14	.118 - .161	.83	.51	10	100
22284	3/4-14	.047 - .079	1.04	.57	10	100
22285	3/4-14	.079 - .122	1.04	.57	10	100
22286	3/4-14	.118 - .161	1.04	.57	10	100
22287	3/4-14	.142 - .181	1.04	.57	10	100
22288	3/4-14	.181 - .236	1.04	.57	10	100
22289	1-11.5	.102 - .142	1.31	.59	10	100
22290	1-11.5	.142 - .181	1.31	.59	10	100
22291	1-11.5	.181 - .237	1.31	.59	10	100
22292	1-11.5	.237 - .315	1.31	.59	10	100
22293	1-1/4-11.5	.256 - .327	1.65	.72	10	100
6 HOLE GLAND						
22294	3/8-18	.055 - .083	.66	.57	10	100
22295	1/2-14	.051 - .079	.83	.51	10	100
22296	1/2-14	.079 - .118	.83	.51	10	100
22297	3/4-14	.055 - .083	1.04	.57	10	100
22298	3/4-14	.079 - .118	1.04	.57	10	100
22299	3/4-14	.102 - .142	1.04	.57	10	100
22300	3/4-14	.142 - .205	1.04	.57	10	100
22301	1-11.5	.102 - .142	1.31	.59	10	100
22302	1-11.5	.142 - .205	1.31	.59	10	100
22303	1-11.5	.220 - .276	1.31	.59	10	100
7 HOLE GLAND						
22304	1/2-14	.051 - .079	.83	.51	10	100
22305	1/2-14	.079 - .118	.83	.51	10	100
22306	3/4-14	.051 - .079	1.04	.57	10	100
22307	3/4-14	.079 - .118	1.04	.57	10	100
22308	3/4-14	.102 - .142	1.04	.57	10	100
22309	1-11.5	.102 - .142	1.31	.59	10	100
22310	1-11.5	.181 - .236	1.31	.59	10	100

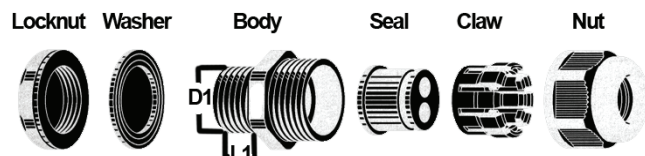

FITTINGS

Cable Glands

F40

Nylon Cable Glands - Metric Thread

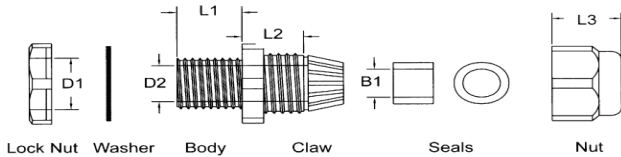

- Seal & Clamp System allows the cord connector to tighten in a Circular Sequence on the sealing ring to give Superior Strain Relief without twisting or damaging the cable
- Simply push the cable through the liquid-tight nylon strain relief & tighten nut for quick installation
- Threads into your panel for clearance, locknut included
- Internal Ratchet with Self-Locking Feature protects against vibration
- 'Collet' Design Accommodates Various Size Cords, Cables, Tubing, etc.
- Nylon Body Material is resistant to most common chemicals & solvents
- For Best Results, Use the Minimum Size that accommodates your cable
- No Disassembly Required
- Made of UL approved NYLON 66, 94V-2 (Black)
- -22°F to 140°F Temperature Rating
- IP68 Rated Submersible & Dustproof
- Metric Thread - Does not have NPT threading
- UL Recognized - 22564-22568 UR Listed

*Not UL Recognized

DIMENSIONS = INCHES

CAT. NO.	MOUNTING HOLE (DI)	CABLE RANGE	THREAD PITCH (MM)	D2	B1	L1	L2	L3	BAG QTY	MASTER BAG QTY
22532*	.47"	.12-.26"	M12-1.25	.33"	.24"	.31"	.48"	.52"	10	100
22534	.63"	.20-.39"	M16-1.50	.43"	.38"	.62"	.57"	.66"	10	100
22536	.79"	.39-.55"	M20-1.50	.58"	.51"	.59"	.78"	.72"	10	100
22538	.98"	.51-.71"	M25-1.50	.73"	.65"	.59"	.74"	.88"	10	100
22540	1.26"	.71-.98"	M32-1.50	1.02"	.92"	.58"	.80"	1.03"	10	100
22542	1.57"	.87-1.26"	M40-1.50	1.30"	1.20"	.70"	.92"	1.24"	10	100
22544*	1.97"	1.18-1.50"	M50-1.50	1.62"	1.50"	.68"	1.01"	1.24"	10	100
22546*	2.40"	1.34-1.73"	M61-1.50	2.13"	1.73"	.73"	1.06"	1.28"	10	100
22548*	2.48"	1.65-1.97"	M63-1.50	2.20"	1.95"	1.00"	1.16"	1.43"	10	100

Nylon Cable Glands - Metric Thread (With Strain Relief)

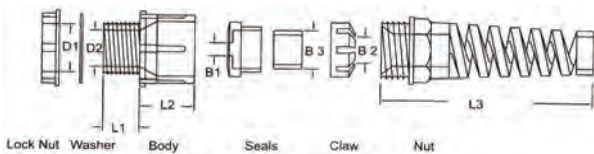

- Extended Cord Support Strain Relief Feature
- Seal & Clamp System allows the cord connector to Tighten in a Circular Sequence on the sealing ring to give Superior Strain Relief without twisting or damaging the cable
- Simply push the cable through the liquid tight nylon strain relief & tighten nut for quick installation
- Threads into your panel for clearance, locknut included
- Internal Ratchet with Self-Locking Feature protects against vibration
- 'Collet' Design Accommodates Various Size Cords, Cables, Tubing, etc.
- Nylon body Material is resistant to most common chemicals & solvents
- For Best Results, Use the Minimum Size that fits into your cable
- No Disassembly Required
- Made of UL approved NYLON 66, 94V-2 (Black)
- -22°F to 140°F Temperature Rating
- IP68 Rated Submersible & Dustproof
- Metric Thread - Does not have NPT threading
- UL Recognized - 22564-22568 UR Listed

*Not UL Recognized

DIMENSIONS = INCHES

CAT. NO.	MOUNTING HOLE (DI)	CABLE RANGE	THREAD PITCH (MM)	D2	B1	L1	L2	L3	BAG QTY	MASTER BAG QTY
22562*	.47"	.12-.26"	M12-1.25	.33"	.24"	.31"	.48"	.52"	10	100
22564	.63"	.20-.39"	M16-1.50	.43"	.38"	.62"	.57"	.66"	10	100
22566	.79"	.39-.55"	M20-1.50	.58"	.51"	.59"	.78"	.72"	10	100
22568	.98"	.51-.71"	M25-1.50	.73"	.65"	.59"	.74"	.88"	10	100

NM Cable Connector



- Accommodates:
 - One or Two 14-2, 14-3 and 12-2 Cables,
 - One 12-3, 10-2 and 10-3 cable,
 - One or Two .300" to .600" Diameter Cords
- Push-in Design with a Captive Locking Wedge that secures cable with a single squeeze with pliers
- Excellent Insulation and Superior Strain Relief
- Sized to fit 1/2" Knockout



DIMENSIONS = INCHES

CAT. NO.	SIZE	DIMENSIONS			BAG QTY	CASE QTY
		A	B	C		
21762	1/2"	1-3/8"	.1/2"	1"	50	1,000

NM Cable Connector



- Smaller and Easily Installed in confined areas
- No tools Required
- Simple Snap-in Installation
- Easily Removed from Knockouts and Easy Removal of NM from Connector
- A Labor Saving Connector with 60 pound Test Pull
- 21764 is gray and 21765 is black

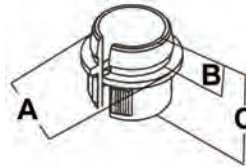

DIMENSIONS = INCHES

CAT. NO.	SIZE	CABLE SIZE	DIMENSIONS			BAG QTY	CASE QTY
			A	B	C		
21764	1/2"	SINGLE CABLE 14/2 - 10/3 TWO CABLES 14/2, 12/2, 14/3	1"	3/8"	15/16"	100	3,000
21765	3/4"	THREE CABLES (3)#6 - (3)#8	1-5/16"	5/8"	1"	50	1,000

NM Cable Connector



- Smaller and Easily Installed in confined areas
- No tools Required
- Simple Snap-in Installation
- Easily Removed from Knockouts and Easy Removal of NM from Connector

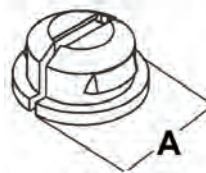

DIMENSIONS = INCHES

CAT. NO.	KO SIZE	CABLE SIZE	DIM. "A"	BAG QTY	CASE QTY
21766	1/2"	14/2 OR 12/2	1-1/16"	100	5,000



3/8" NM Connector - Zinc Die Cast

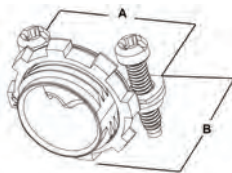

- Used to connect Non-Metallic Sheath Cable and Flexible Cord from .30" to .45" in diameter to Outlet Boxes, Enclosures, or Raceway Systems
- 3/8" size fits 1/2" knockout
- Assembled with Zinc Die Cast Locknut and Combo Screws

DIMENSIONS = INCHES

CAT. NO.	TRADE SIZE	DIMENSIONS		INNER BOX	OUTER BOX
		A	B		
15330	3/8"	1.18	.78	100	1,000

Non-Watertight NM Round Connectors - Zinc Die Cast

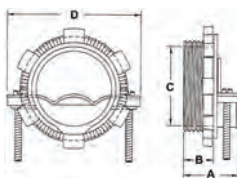

- Used with Locknut to Terminate Service Entrance Cable to Enclosure
- Assembled with Zinc Die Cast Locknut and Combo Screws
- For Type SEU and NM Cable

DIMENSIONS = INCHES

CAT. NO.	TRADE SIZE	DIMENSIONS				INNER BOX	OUTER BOX
		A	B	C	D		
15331	3/4"	.83	.32	.83	1.67	40	400
15332	1"	1.14	.55	1.04	1.95	20	200
15333	1-1/4"	1.24	.57	1.38	2.20	15	150
15334	1-1/2"	1.40	.57	1.61	2.60	10	100
15335	2"	1.50	.65	2.05	3.03	8	80

Non-Watertight NM Oval Connectors - Zinc Die Cast

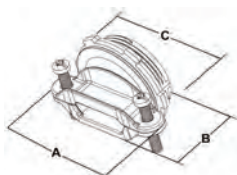

- Used with Locknut to Terminate NM Cable to Enclosure
- Assembled with Zinc Die Cast Locknut and Combo Screws
- For NM Oval Cable

DIMENSIONS = INCHES

CAT. NO.	TRADE SIZE	DIMENSIONS			INNER BOX	OUTER BOX
		A	B	C		
15337	1-1/4"	2.26	1.29	1.91	10	100
15338	1-1/2"	2.84	1.30	2.19	10	100
15339	2"	3.48	1.51	2.76	5	50

Tilt-in NM Connectors - Steel

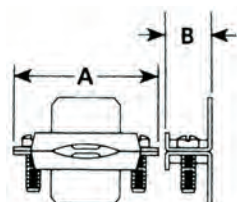

- To terminate one or more Non-Metallic Sheathed Cables to a Knockout in a dry location box or enclosure
- Zinc Plated Steel
- No locknut Required

DIMENSIONS = INCHES

CAT. NO.	TRADE SIZE	DIMENSIONS		INNER BOX	OUTER BOX
		A	B		
19012	1/2"	1.31	.59	100	1000
19013	3/4"	1.73	.75	-	100
19014	1-1/4"	1.97	.69	-	50
19015	1-1/2"	2.52	.78	25	250

Water-Tight Service Entrance Connectors - Zinc Die-Cast

- Compression Type SEU Connector
- Used to Connect Service Entrance Cable to a Service Enclosure in Wet Locations
- Accepts 2 Insulated Conductors, 1 Bare
- U/Flat Style Conductor Only
- Assembled with Rubber Grommet and Steel Washer
- Locknut Included



FITTINGS

Service Entrance

DIMENSIONS = INCHES

CAT. NO.	TRADE SIZE	CABLE SIZE	MAX GROMMET OPENING		OVERALL DIMENSIONS		INNER BOX	OUTER BOX
			LENGTH	WIDTH	A	B		
15370	1"	#8	.67	.40	1.67	1.45	20	100
15371	1"	#6	.77	.50	1.67	1.45	20	100
15372	1"	#4	.81	.53	1.67	1.45	20	100
15373	1-1/4"	#3	.92	.56	2.05	1.80	10	50
15374	1-1/4"	#2	.98	.59	2.05	1.80	10	50
15375	1-1/4"	#1	1.09	.65	2.05	1.80	10	50
15377	1-1/2"	#2/0	1.34	.86	2.31	2.02	10	50
15379	2"	#2/0	1.34	.86	2.82	2.39	5	25
15380	2"	#3/0	1.37	.87	2.82	2.39	5	25
15381	2"	#4/0	1.50	.90	2.82	2.39	5	25
15382	2"	#4/0	1.73	1.11	2.82	2.39	5	25

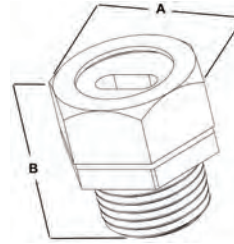

Underground Feed UF To Box Connector - Zinc Die Cast



- Used to Connect Underground Feeder Cables (UF) To Weatherproof Enclosures in Wet Locations.
- Assembled with a Rubber Grommet and Steel Washer
- Sealing Locknut System

DIMENSIONS = INCHES

CAT. NO.	TRADE SIZE	CABLE SIZE	MAX GROMMET OPENING		OVERALL DIMENSIONS		INNER BOX	OUTER BOX
			LENGTH	WIDTH	A	B		
15386	1/2"	14/2, 12/2, 10/2	.475	.235	1.22	1.14	25	250
15387	3/4"	14/3, 12/3, 10/3, 8/2	.720	.260	1.34	1.20	25	250

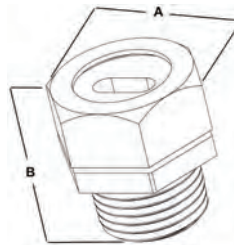

Kenny Clamps



- UL 467 listed connector for use with Equipment Ground Conductors, Ground Electrode Conductors and Bonding Jumpers
- The Kenny Clamp bonds the enclosure of a service panelboard, load center, separately derived system or switchboard to the grounding electrode conductor per the requirements of NEC 250.8; 312.5(A); 250.53 D(2); 250.52 (A)(1); 250.52(A)(3); 250.66; 250.104 (D)(1); 250.24; 450.10(A)
- Assures good metallic connection and low impedance path for grounding and bonding of electrical equipment
- 12,000 Amp listed and tested
- Brass

DIMENSIONS = INCHES

CAT. NO.	MODEL NO.	TRADE SIZE	DIMENSIONS		INNER BOX	OUTER BOX
			A	B		
15390	KC8ST	8 AWG STRANDED	1.75	1.06	10	100
15391	KC8SO	8 AWG SOLID	1.75	1.06	10	100
15392	KC6SO	6 AWG SOLID	1.75	1.06	10	100
15393	KC6ST	6 AWG STRANDED	1.75	1.06	10	100
15394	KC4SO	4 AWG SOLID	1.75	1.06	10	100
15395	KC4ST	4 AWG STRANDED	1.75	1.06	10	100
15396	KC2ST	2 AWG STRANDED	1.75	1.06	10	100
15397	KCIAST	1/0 STRANDED	1.75	1.06	10	100
15398	KC2AST	2/0 STRANDED	1.75	1.06	10	100
15399	KC3AST	3/0 STRANDED	1.75	1.06	10	100

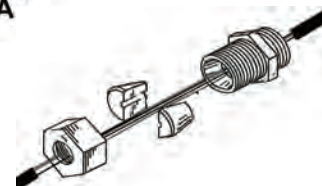
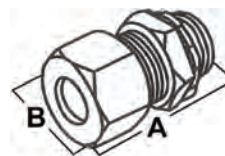



Non-Metallic Service Entrance Cable Hoods

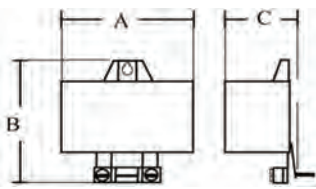

- Provides Protection to Service Entrance Cables
- Non-Metallic PVC construction
- Suitable for Outdoor use

DIMENSIONS = INCHES

CAT. NO.	CABLE SIZE	DIMENSIONS			BOX QTY
		A	B	C	
15500	(3)#3 TO #1	4.25	6.02	2.00	10
15501	(3)2/0 TO 4/0	5.90	6.12	2.50	10

Aluminum Service Entrance Caps - SEU Cable

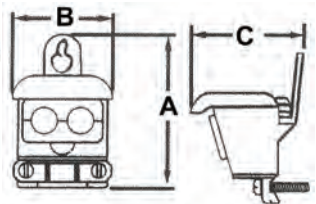

- Used with Type U Service Entrance Cable
- Removable Cap and 2 Piece Insulator Make Wire Pulling and Assembly Easy
- Cable Clamp
- Suitable for Outdoor use

DIMENSIONS = INCHES

CAT. NO.	CABLE SIZE	DIMENSIONS			BOX QTY
		A	B	C	
15502	(3)#8 TO #1	2.96	2.76	2.59	175
15504	(3)1/0 TO 4/0	4.48	3.79	3.60	54

PVC Entrance Caps - Cable Clamp

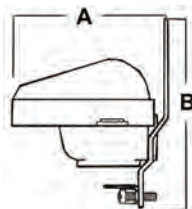

- Rigid, weather-resistant material assembled with a Galvanized Back Plate for easy installation

DIMENSIONS = INCHES

CAT. NO.	SIZE	CABLE SIZE	DIMENSIONS		BOX QTY
			A	B	
21772	SMALL	(3) #8, 6, 4, 2	2.75	2.80	20
21773	MEDIUM	(3) 1/0 TO 2/0	4.25	4.90	10
21774	LARGE	(3) 3/0 TO 4/0	4.25	4.90	10

PVC Entrance Caps - Conduit Mount

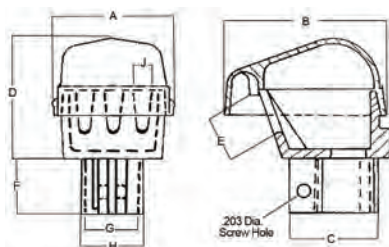

- Entrance head for mounting on PVC, RIGID, IMC and EMT Conduit (Red adaptor included for EMT)
- Rugged Non-Metallic Design is resistant to adverse weather conditions
- Provides 50% Larger Wiring Compartment than other entrance heads
- Entire Head acts as an Insulator of high dielectric strength

DIMENSIONS = INCHES

CAT. NO.	SIZE	DIMENSIONS									BOX QTY
		A	B	C	D	E	F	G	H	J	
21782	1/2"	2.00	2.71	1.50	1.97	.69	.94	.86	2.61	.31	200
21783	3/4"	2.41	2.30	1.72	2.23	.81	.94	1.07	1.25	.44	140
21784	1"	2.41	2.30	1.97	2.23	.81	1.13	1.33	1.31	.44	140
21785	1-1/4"	3.03	4.03	2.34	2.66	.88	1.09	1.68	1.89	.53	75
21786	1-1/2"	3.50	4.03	2.59	2.63	.88	1.13	1.92	2.13	.63	75
21787	2"	4.53	6.31	3.38	3.81	1.44	1.63	2.39	2.69	.75	20

Aluminum Service Entrance Cap - Clamp On



- Clamp-on type head used with Rigid conduit, IMC or E.M.T. for pulling service drop conductors
- Cast Aluminum
- Bar type Clamp
- Heavy pressure clamp in body
- Weather resistant
- Assembled with electrical grade phenolic insulator with multiple holes

DIMENSIONS = INCHES

CAT. NO.	TRADE SIZE	DIMENSIONS			INNER BOX	OUTER BOX
		A	B	C		
15520	1/2"	2.68	2.50	2.19	-	100
15521	3/4"	3.04	2.76	2.39	-	100
15522	1"	3.48	2.96	2.58	-	100
15523	1-1/4"	4.22	3.27	3.06	-	60
15524	1-1/2"	5.22	4.28	3.49	-	60
15525	2"	6.68	5.81	4.33	-	30
15526	2-1/2"	9.94	7.05	6.54	1	4
15527	3"	11.69	8.54	6.93	1	4
15528	3-1/2"	11.69	8.54	7.28	1	4
15529	4"	11.69	8.54	7.86	1	4

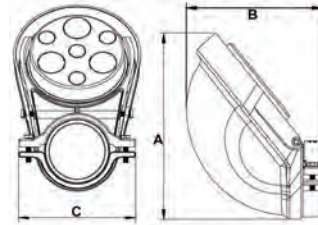

Aluminum Service Entrance Cap - Conduit Mount Threaded



- Conduit Mount Head used with Rigid or IMC for Pulling Service Entrance Conductors
- Weather Resistant
- Assembled with Electrical Grade Phenolic Insulator with multiple holes

DIMENSIONS = INCHES

CAT. NO.	TRADE SIZE	DIMENSIONS			INNER BOX	OUTER BOX
		A	B	C		
15530	1/2"	1.97	2.68	2.29	-	100
15531	3/4"	2.13	3.04	2.66	-	100
15532	1"	2.36	3.48	2.96	-	100
15533	1-1/4"	2.68	4.22	3.11	-	60
15534	1-1/2"	3.39	5.22	4.06	-	60
15535	2"	4.33	6.69	5.28	-	30
15536	2-1/2"	6.30	9.94	6.69	1	4
15537	3"	7.99	11.69	8.08	1	4
15538	3-1/2"	7.99	11.69	8.08	1	4
15539	4"	7.99	11.69	8.08	1	4

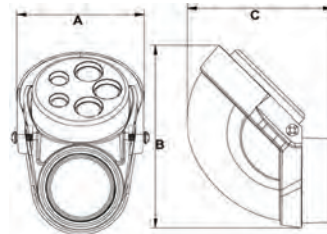

Aluminum Service Entrance Cap - Slip Fitter Mast Head



- Slip Fitter Mast Head used with Rigid or IMC Conduit for Pulling Service Drop conductors
- Cast Aluminum
- Mast type Clamp
- Screw does not bear directly on conduit
- Weather Resistant
- Assembled with electrical grade phenolic insulator with multiple holes

DIMENSIONS = INCHES

CAT. NO.	CONDUIT SIZE	INSULATOR CAP SIZE	DIMENSIONS			SET SCREW	BOX QTY
			A	B	C		
15540	2"	1-1/4"	3.46	1.95	3.75	1/4-20 X 5/8	50
15541	2-1/2"	1-1/4"	3.46	1.95	3.75	1/4-20 X 1/2	50
15542	2-1/2"	2"	4.68	1.95	4.88	1/4-20 X 5/8	50

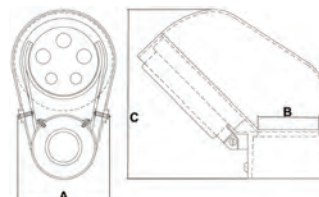



Malleable Mast Support Clamp

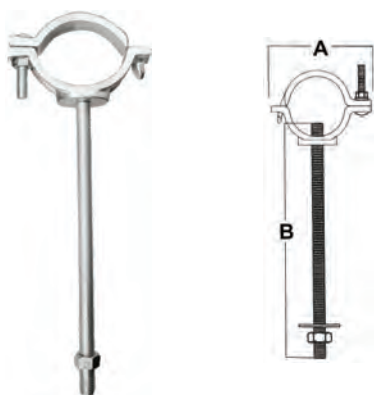

- Used to secure Service Entrance Conduit to the Outside surface of a building
- Hinged on one side and bolted on other side for easy installation
- Machined Bolt and Nut
- Malleable Iron

DIMENSIONS = INCHES

CAT. NO.	CONDUIT SIZE	DIMENSIONS		BOX QTY
		A	B	
21830	2"	4.23	10	25
21831	2-1/2"	4.79	10	25

Conduit Support Split Ring

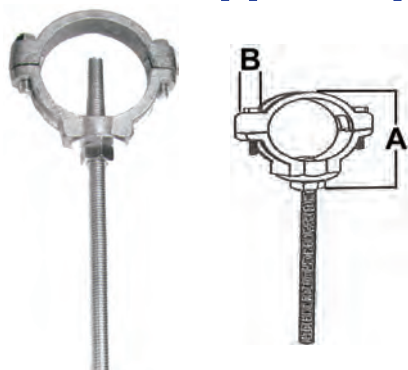

- Used to secure Service Entrance Conduit to the Outside surface of a building
- Bolted on both sides
- Malleable Iron

DIMENSIONS = INCHES

CAT. NO.	CONDUIT SIZE	BOLT SIZE	DIMENSIONS		BOX QTY
			A	B	
21835	2"	1/2" X 10"	2.70	.99	25
21836	2-1/2"	1/2" X 10"	3.33	1.07	25
21837	3"	5/8" X 13"	4.50	1.04	10
21838	3-1/2"	5/8" X 13"	5.13	1.08	10
21839	4"	5/8" X 13"	5.60	1.08	10

Conduit Support Universal



- Used to secure Service Entrance Conduit to the Outside surface of a building
- 1/2" x 10" Bolt
- Zinc Plated Steel

DIMENSIONS = INCHES

CAT. NO.	CONDUIT SIZE	DIMENSIONS		BOX QTY
		A	B	
21833	1-1/4" TO 3"	3.80	10.00	20

Malleable U-Bolt Pipe Clamps

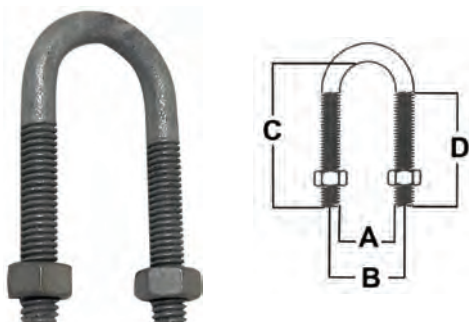

- Recommended for supporting or guiding heavy loads along runs of non-insulated pipe
- 2 hex nuts
- Malleable Iron - Galvanized

DIMENSIONS = INCHES

CAT. NO.	TRADE SIZE	DIMENSIONS				INNER BOX	OUTER BOX
		A	B	C	D		
21840	1/2"	1.00	1.25	2.50	1.81	25	250
21841	3/4"	1.12	1.38	2.81	1.81	25	250
21842	1"	1.38	1.63	3.06	1.81	25	250
21843	1-1/4"	1.75	2.00	3.19	1.81	20	200
21844	1-1/2"	2.00	2.38	3.50	1.81	20	200
21845	2"	2.50	2.50	4.50	2.63	10	100
21846	2-1/2"	3.00	3.25	4.88	2.63	-	20
21847	3"	3.63	3.88	5.38	2.63	-	20
21848	3-1/2"	4.06	4.56	5.88	2.63	-	20
21849	4"	4.69	5.06	6.69	2.63	-	20

Lag Type Service Insulator Wire Holder

- Indoor or Outdoor use in Overhead Service Entrance
- These small porcelain insulators can also be used with all fence wire including high tensile, poly rope and poly tape
- 600V or Less

DIMENSIONS = INCHES

CAT. NO.	DUTY	SCREW SIZE	DIMENSIONS			BOX QTY
			A	B	C	
21892	LIGHT	1/4" X 1-11/16"	1.37	1.98	1.62	100
21894	MEDIUM	3/8" X 2-1/4"	1.90	2.90	1.85	50

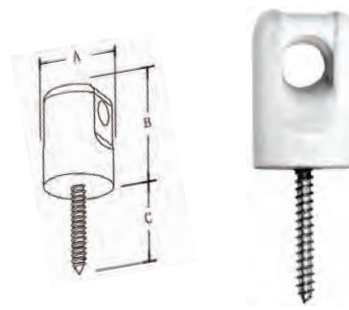

Porcelain Wire Holders - Heavy Duty Reinforced

- Single-point wire holders are strong and compact
- Solid Rivet through head
- Made with Porcelain and Galvanized Steel
- Quick and easy installation for most projects
- For use with wooden construction

DIMENSIONS = INCHES

CAT. NO.	SCREW SIZE	DIMENSIONS			BOX QTY
		A	B	C	
21896	3/8" X 2-1/4" LAG	2.11	2.90	3.00	50

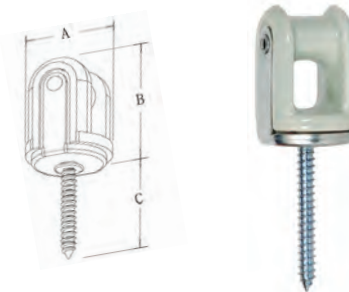

Porcelain Wire Holders - Heavy Duty Adjustable

- Porcelain Wire holder has a steel reinforced saddle for use with pipe or pole attachment
- Adjustable Steel Clamp
- Fits 1-1/4" to 3" Conduit/Pipe

DIMENSIONS = INCHES

CAT. NO.	CONDUIT SIZE	DIMENSIONS			CLAMP MIN. DIA.	CLAMP MAX. DIA.	BOX QTY
		A	B	C			
21898	1-1/4" TO 3"	2.11	2.90	3.80	1.62	3.93	20

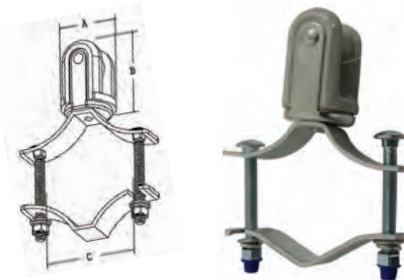

Service Entrance Insulator Wire Holder - 2" Pipe Hanger

- Ceramic Service Entrance Wire Insulator with 2" Conduit/Pipe Hanger Clamp
- Fits 2" Rigid or EMT Conduit

DIMENSIONS = INCHES

CAT. NO.	CONDUIT SIZE	DIMENSIONS			BOX QTY
		A	B	C	
21897	2"	2.11	2.90	2.38	25

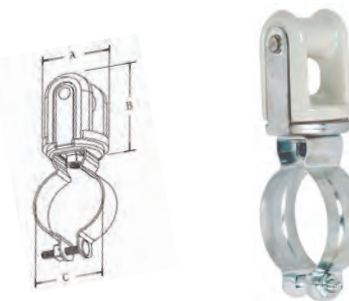

Service Entrance Insulator Wire Holder - 3/8" X 5" Bolt

- Single-point wire holders are strong and compact
- Solid Rivet through head
- Made with Porcelain and Galvanized steel
- Bolt & Nut Type Wire Holder

DIMENSIONS = INCHES

CAT. NO.	BOLT SIZE	DIMENSIONS			BOX QTY
		A	B	C	
21899	3/8" X 5"	2.11	2.90	5.00	25

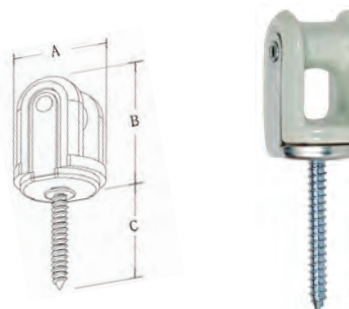



Wedge Clamps

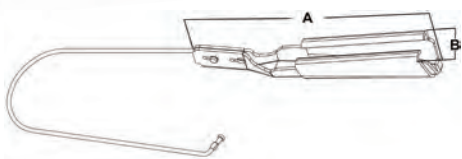

- Designed to hold triplex overhead service-entrance cable to a mounting structure
- Aluminum wedge and shell with a stainless-steel ball
- Can be used indoors or outdoors
- Corrosion resistant
- Installs quickly and easily

DIMENSIONS = INCHES

CAT. NO.	ACSR RANGE	DIMENSIONS		BOX QTY
		A	B	
28881	#6-#2	5.94	.85	50
28882	#4-1/0	7.21	1.04	25
28883	2/0-4/0	7.21	1.22	25

Wire Rope Clip - Guy Wire

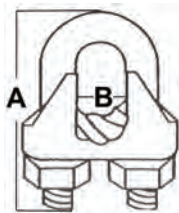

- For Guy Wire
- Malleable Iron
- Galvanized

DIMENSIONS = INCHES

CAT. NO.	TRADE SIZE	DIMENSIONS		BOX QTY
		A	B	
17302	1/4"	1.50	0.25	50

Steel Snap-In Blanks

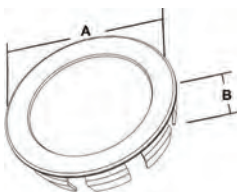

- For use in closing off unused openings in boxes or panel boards
- All steel construction provides installation integrity
- Snap-Fit Design

DIMENSIONS = INCHES

CAT. NO.	TRADE SIZE	DIMENSIONS		INNER BOX	OUTER BOX
		A	B		
21800	1/2"	1.08	.29	100	1,000
21801	3/4"	1.23	.31	100	1,000
21802	1"	1.47	.34	100	1,000
21803	1-1/4"	1.88	.37	50	500
21804	1-1/2"	2.22	.31	50	500
21805	2"	2.67	.34	10	100

Type S With Screw and Bar Knockout Seals



- Set screw/bar type knockout seals are inserted in open box knockouts to protect exposed wires
- Used in standard, air tight or dust tight applications
- Pre-assembled screw and backer bar slides on open knockout holes without removing box devices or covers
- Steel Galvanized

DIMENSIONS = INCHES

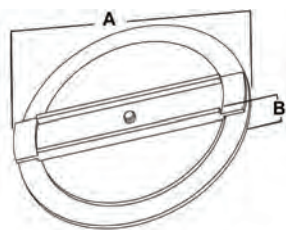

CAT. NO.	TRADE SIZE	DIMENSIONS		INNER BOX	OUTER BOX
		A	B		
21790	1/2"	1.20	.27	100	500
21791	3/4"	1.39	.32	100	500
21792	1"	1.66	.28	50	500
21793	1-1/4"	2.10	.33	50	500
21794	1-1/2"	2.46	.33	10	300
21795	2"	2.94	.34	10	300
21796	2-1/2"	3.75	.34	-	100
21797	3"	4.51	.34	-	100
21798	3-1/2"	5.01	.344	-	100
21799	4"	5.50	.34	-	100

Plastic Knockout Plugs

- To cap knockout holes in box or enclosure

DIMENSIONS = INCHES

CAT. NO.	TRADE SIZE	MOUNTING HOLE DIAMETER	A	BAG QTY
21721	1/2"	.85"	1-1/8"	100
21722	3/4"	1.10"	1-1/4"	100
21723	1"	1.35"	1-1/2"	50

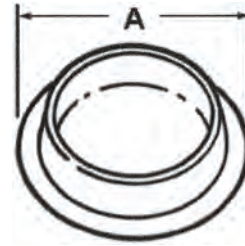

Plastic Knockout Plugs - Snap-In

- Plugs electrical knockouts with finger tip pressure
- Snap-In Winged Protrusion for Positive Lock
- Low cost and assures good appearance
- Less costly & safer than steel snap-in blanks
- 1/8" maximum steel thickness
- Made from UL approved Nylon 6/6, 94V-2

DIMENSIONS = INCHES

CAT. NO.	MOUNTING HOLE DIAMETER	HEAD DIAMETER	OVERALL HEIGHT	BAG QTY
22380	.18 (3/16")	.25"	.23"	10
22382	.31 (5/16")	.47"	.31"	10
22384	.37 (3/8")	.51"	.41"	10
22386	.50 (1/2")	.67"	.41"	10
22388	.63 (5/8")	.78"	.41"	10
22390	.75 (3/4")	.90"	.41"	10
22392	.87 (7/8") (1/2" TRADE)	.98"	.44"	10
22394	.98 (1")	1.11"	.44"	10
22396	1.18 (1-1/4")	1.35"	.44"	10
22398	1.50 (1-1/2")	1.67"	.44"	10
22400	1.75 (1-3/4")	1.93"	.44"	10

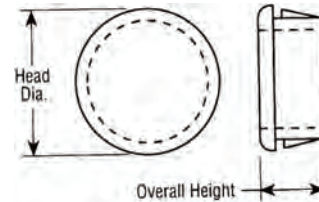

**SIZES LISTED ARE ACTUAL DIAMETER
(NOT TRADE SIZES EXCEPT WHERE NOTED)**

Plastic Pull Caps

- Used for capping EMT, IMC & Rigid Conduits and most bushings

DIMENSIONS = INCHES

CAT. NO.	TRADE SIZE	DIMENSIONS		BOX QTY
		A	B	
21712	1/2"	11/16"	5/8"	100
21713	3/4"	15/16"	13/16"	100
21714	1"	1-3/16"	1-1/16"	100
21715	1-1/4"	1-1/2"	1-3/8"	50
21716	1-1/2"	1-3/4"	1-9/16"	25
21717	2"	2-3/16"	2-1/16"	25

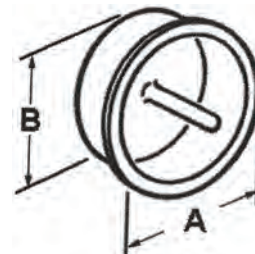

1 Hole EMT Pipe Straps - Steel



- Secures EMT Conduit
- Reinforced Rib for Extra Strength
- Reinforced Hole
- Snap-On Installation
- 19431-19433 Fits EMT, Rigid or IMC conduit
- Zinc Plated Steel



DIMENSIONS = INCHES

CAT. NO.	TRADE SIZE	INNER BOX	OUTER BOX
19400	1/2"	100	1000
19401	3/4"	100	1000
19402	1"	100	500
19403	1-1/4"	25	250
19404	1-1/2"	20	100
19405	2"	10	100
19431	3"	-	10
19432	3-1/2"	-	10
19433	4"	-	10

2 Hole EMT Pipe Straps - Steel



- Secures EMT Conduit
- Reinforced Rib for Extra Strength
- 2 Hole - Reinforced Holes
- Snap-On Installation
- Zinc Plated Steel



DIMENSIONS = INCHES

CAT. NO.	TRADE SIZE	INNER BOX	OUTER BOX
19412	1/2"	100	1,000
19413	3/4"	50	500
19414	1"	25	250
19415	1-1/4"	25	250
19416	1-1/2"	10	100
19417	2"	5	50

1 Hole Rigid Pipe Straps - Heavy Duty - Steel



- Secures Rigid & IMC Conduit
- Reinforced Rib for Extra Strength
- Reinforced Hole
- Snap-On Installation
- 19431-19433 Fits EMT, Rigid or IMC conduit
- Zinc Plated Steel



DIMENSIONS = INCHES

CAT. NO.	TRADE SIZE	INNER BOX	OUTER BOX
19424	1/2"	100	1,000
19425	3/4"	50	500
19426	1"	25	250
19427	1-1/4"	25	250
19428	1-1/2"	20	200
19429	2"	10	100
19430	2-1/2"	5	50
19431	3"	-	10
19432	3-1/2"	-	10
19433	4"	-	10
19434*	5"	-	10
19435*	6"	-	10

*Not UL listed

2 Hole Rigid Pipe Straps - Steel



- Secures Rigid & IMC Conduit
- Reinforced Rib for Extra Strength
- Reinforced Holes
- Snap-On Installation
- Zinc Plated Steel



DIMENSIONS = INCHES

CAT. NO.	TRADE SIZE	INNER BOX	OUTER BOX
19436	1/2"	100	1,000
19437	3/4"	50	500
19438	1"	25	250
19439	1-1/4"	20	200
19440	1-1/2"	10	100
19441	2"	5	50
19442	2-1/2"	-	50
19443	3"	-	50
19444	4"	-	10
19445*	5"	-	10
19446*	6"	-	10

*Not UL listed

1 Hole Rigid Pipe Straps - Malleable Iron

- Secures Rigid & IMC Conduit
- Malleable Iron, Heavy Duty Casting
- Reinforced Rib for Extra Strength
- Snap-On Installation
- Zinc Plated

DIMENSIONS = INCHES

CAT. NO.	TRADE SIZE	DIMENSIONS				INNER BOX	OUTER BOX
		A	B	C	D		
19522	1/2"	2.25	.66	.94	.35	100	1,000
19523	3/4"	2.26	.75	1.22	.49	50	500
19524	1"	3.06	.81	1.50	.63	25	250
19525	1-1/4"	3.69	.88	1.88	.82	20	200
19526	1-1/2"	4.00	1.00	2.06	.91	10	100
19527	2"	5.06	1.13	2.56	1.16	-	25
19528	2-1/2"	6.10	1.60	3.30	1.38	-	25
19529	3"	7.28	1.46	3.70	1.71	-	25
19531	4"	8.86	2.08	4.85	2.23	-	10
19532	5"	9.38	2.59	6.00	2.88	-	2
19533	6"	10.38	3.13	7.00	3.38	-	2

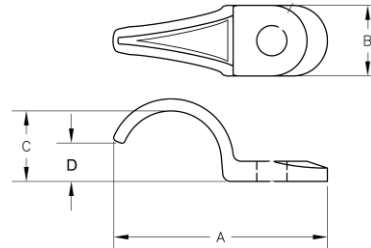

Malleable EMT/Rigid Clamp Back Spacers

- Provides Space between conduit and mounting surface
- For use with malleable iron or aluminum straps
- Can be used with one hole straps
- Heavy Duty Casting

DIMENSIONS = INCHES

CAT. NO.	TRADE SIZE	DIMENSIONS							INNER BOX	OUTER BOX
		A	B	C	D	E	F	G		
14782	1/2"	2.06	1.00	.50	.43	.32	.40	.08	25	250
14783	3/4"	2.38	1.06	.50	.53	.32	.40	.08	25	250
14784	1"	2.94	1.25	.56	.67	.32	.40	.08	25	250
14785	1-1/4"	3.50	1.38	.75	.84	.32	.40	.08	10	100
14786	1-1/2"	3.81	1.44	.81	.96	.32	.40	.08	10	100
14787	2"	4.75	1.94	1.00	1.20	.32	.40	.08	5	50
14788	2-1/2"	5.75	2.44	.75	1.45	.32	.40	.08	-	25
14789	3"	6.69	2.63	.088	1.77	.32	.40	.08	-	10
14790	3-1/2"	7.13	2.88	1.08	2.02	.32	.40	.08	-	10
14791	4"	8.88	3.06	1.06	2.27	.32	.40	.08	-	10
14792	5"	10.13	3.75	.06	2.81	.32	.40	.08	-	10
14793	6"	12.19	4.00	.75	3.35	.32	.40	.08	-	10

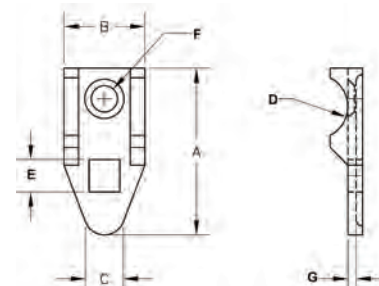

1 Hole SEU Pipe Straps

- Secures SE & SEU Service Entrance Cable
- Zinc Plated Steel

CAT. NO.	CABLE SIZE	INNER BOX	OUTER BOX
19452	(3)#8, (3)#6 OR (3)#4	100	1,000
19453	(3)#3 OR (3)#2	100	1,000
19454	(3)#1, (3)#1/0, (3)#2/0	50	500
19455	(3)#3/0, (3)#4/0	50	500



2 Hole SEU Pipe Straps

- Secures SE & SEU Service Entrance Cable
- Zinc Plated Steel

CAT. NO.	CABLE SIZE	INNER BOX	OUTER BOX
19456	(3)#8 OR (3)#6, (3)#4	100	1,000
19457	(3)#2 OR (3)#3	100	1,000
19458	(3)#1, (3)#1/0, OR (3)#2/0	50	500
19459	(3)#3/0, (3)#4/0	25	250



Non Metallic Cable One Hole Strap



- Used To Secure 14/2 NM Romex Cables
- Zinc Plated Steel
- Reinforced Rib for Extra Strength

CAT. NO.	CABLE SIZE	INNER BOX	OUTER BOX
19460	14/2	25	250



BX 1 Hole Strap



- These one-hole pipe straps are ideal for hanging tubing, pipe, conduit and BX cable
- Pre-galvanized zinc plated steel

CAT. NO.	CABLE SIZE	BOX QTY
19463*	BX: 14-2 THRU 10-3	100
19464	EMT: 1/2", RIGID: 1/4", BX: 12-3, 10-2, 10-3 SER 8	100

*Not UL listed



2 Hole PVC Pipe Straps



- For Schedule 40 PVC Conduit
- Heavy Duty Polyethylene resists deterioration from UV rays and breakage from extreme cold

DIMENSIONS = INCHES

CAT. NO.	TRADE SIZE	BOX QTY
19490	1/2"	100
19492	3/4"	100
19494	1"	100
19496	1-1/4"	50
19498	1-1/2"	50
19500	2"	50
19501	2-1/2"	25
19502	3"	25
19503	4"	25



Conduit Hanger with Bolt



- Secures EMT or Rigid Conduit to any mounting surface, Threaded Rod or Insulated Supports
- Zinc Plated Steel

DIMENSIONS = INCHES

CAT. NO.	TRADE SIZE	OUTER BOX
19470	1/2"	100
19471	3/4"	100
19472	1"	100
19473	1-1/4"	100
19474	1-1/4" RIGID TO 1-1/2" EMT	100
19475	1-1/2"	100
19476	2"	50
19477	2-1/2"	25
19478	3"	25
19479	3-1/2"	25
19480	4"	25

Plastic Cable Clips

- Impact resistant, non-corrosive
- Complete with corrosion resistant, hardened steel nails for securing cable to wood, cement, plaster, brick, etc.
- Nail heads are recessed for minimum exposure
- Smooth saddle prevents damage to insulation
- High-grade injection-molded polyethylene
- Resists rot, rust and the effects of temperature extremes



FIG 1

FIG 2

FIG 3

DIMENSIONS = INCHES

CAT. NO.	FIG	USED FOR WIRE SIZES	COLOR	W X HT X INSIDE HT	INNER BAG	MASTER BAG
35000	1	2 NAIL 12/2 & 14/2 NM & UF (1/2" WIDE)	WHITE	.49 X .31 X .21	100	1,000
35001	1	2 NAIL 10/2 NM & UF (3/4" WIDE)	WHITE	.74 X .31 X .21	100	1,000
35002	2	12/2 & 14/2 NM & UF	WHITE	.39 X .39 X .26	100	1,000
35004	3	14/3 NM	GRAY	.31 X .51 X .32	100	1,000
35006	3	10/3 & 12/3 NM	GRAY	.43 X .65 X .48	100	1,000
35008	3	RG 59 COAX CABLE, CAT 5 UTP 4 PAIR	GRAY	.24 X .35 X .26	100	1,000
35040	3	RG 59 COAX CABLE, CAT 5 UTP 4 PAIR	WHITE	.24 X .35 X .26	100	1,000
35041	3	RG 59 COAX CABLE, CAT 5 UTP 4 PAIR	BLACK	.24 X .35 X .26	100	1,000
35010	3	RG 6 COAX CABLE	GRAY	.28 X .43 X .30	100	1,000
35042	3	RG 6 COAX CABLE	WHITE	.28 X .43 X .30	100	1,000
35043	3	RG 6 COAX CABLE	BLACK	.28 X .43 X .30	100	1,000
35012	3	4 CONDUCTOR TELEPHONE WIRE	GRAY	.14 X .23 X .15	100	1,000
35044	3	4 CONDUCTOR TELEPHONE WIRE	WHITE	.14 X .23 X .15	100	1,000
35045	3	4 CONDUCTOR TELEPHONE WIRE	BLACK	.14 X .23 X .15	100	1,000
35014	2	SMALL CORDS SUCH AS LAMP, THERMOSTAT, SPEAKER & PHONE	WHITE	.24 X .25 X .15	100	1,000

Plastic Stacking Staples

- Plastic insulated staples quickly and easily secure vertical stacks of non-metallic cable
- Electro-zinc plated nails provide strength and durability
- Smooth saddles prevent damage to insulation
- UV-protected Polyethylene saddle resists rot, rust and deterioration
- 1/2" wide, white color



CAT. NO.	CABLE SIZE	INNER BAG	OUTER BAG
35016	(2) 14/2 & 12/2	50	500
35018	(3) 14/2 & 12/2	50	500
35020	(4) 14/2 & 12/2	50	500

Plastic Service Entrance Cable Straps

- Plastic insulated straps quickly and easily secure service entrance cable
- Electro-zinc plated nails provide strength and durability
- Stabilized against UV rays and extreme cold; withstand deterioration and breakage
- Smooth saddles prevent damage to insulation
- Polyethylene Material



CAT. NO.	CABLE SIZE	INNER BAG	OUTER BAG
35022	#6 & #8 SEU	50	500
35024	#2 SEU	25	250
35026	4/0 SEU	25	250
35028	#6 SER & 1/2" EMT	50	500
35030	#2 SER & 3/4" EMT	25	250
35032	2/0 SER	25	250
35034	4/0 SER	25	250

35028 THRU 35034

35022 THRU 35026



FITTINGS

Cable Clips

Cable Stacker

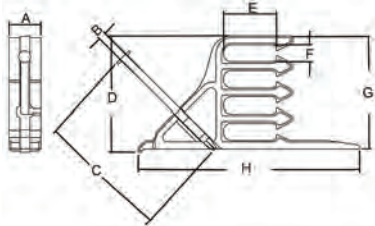

- Accepts a wide range of NM cables
- Angled nail allows easy installation from any direction regardless of stud positioning and spacing
- Keeps a professional look in exposed areas
- Cables snap easily in between tines for a secure hold
- Makes cable identification simple
- Also used with CATV, Telephone, Instrumentation and Security Cables
- Material: Polypropylene

DIMENSIONS = INCHES

CAT. NO.	DIMENSIONS								BAG QTY	CASE QTY
	A	B	C	D	E	F	G	H		
21757	.47	.11	1.93	1.72	.78	.26	1.67	3.26	25	1,000

Nail Straps - Heavy Duty - Rigid IMC & EMT

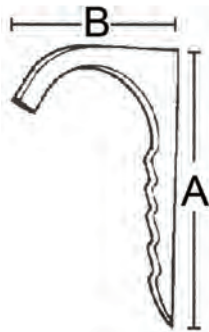

- Secures Rigid, IMC & EMT Conduits thru 1" Diameter
- Zinc Plated Stamped Steel
- Wood or Masonry Applications

DIMENSIONS = INCHES

CAT. NO.	TRADE SIZE	DIMENSIONS		INNER BOX	OUTER BOX
		A	B		
19482	1/2"	2.13	1.10	100	1,000
19483	3/4"	2.13	1.20	100	1,000
19484	1"	2.25	1.50	50	500

Nail Plates

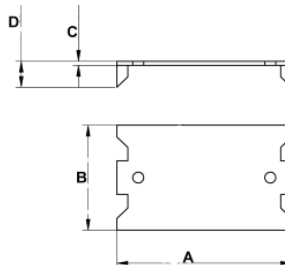

- Used to protect internal wire runs from nail punctures
- Hammer On
- Zinc Plated Stamped Steel

DIMENSIONS = INCHES

CAT. NO.	TRADE SIZE	DIMENSIONS				INNER BOX	OUTER BOX
		A	B	C	D		
19542	1-1/2" X 2-1/2"	2.50	1.50	.06	.37	100	500

LiquidTite Flexible Conduit



- Type B Non-metallic liquidtight conduit
- For outside, inside and industrial uses
- Motor & Controls Installations
- HVAC Applications
- Power Distribution to Equipment
- Machine Tool Applications
- Transformer Terminations
- Outdoor lighting Applications
- Joins with metallic or non-metallic connectors
- 176° (80°C) Rated
- U.L. and C.U.L. Listed
- Non-conductive and non-corrosive
- Lightweight for easy handling, transportation, and installation
- Resistant to oil, acid, ozone, and alkaline
- Crush, abrasion, and strain resistant
- Smooth interior ideal for pulling cable
- Easy to cut into lengths, no jagged edges
- Maintains internal I.D. even in tight radius bends
- UL Listed for use as indicated in Article 351 of the 1987 NEC and Section 12-1300 of the 2002 Canadian Electrical Code, Part I.
- UL Listed for outdoor use
- UV resistant



T750-12100

CAT. NO.	DESCRIPTION	UOM	ORDER MULTIPLE
T750-12100	1/2" X 100' LIQUID TITE CONDUIT - NON-METALLIC, 100' PER ROLL	EA	1
T750-12100 BOX	1/2" X 100' LIQUID TITE CONDUIT - NON-METALLIC, 100' PER ROLL IN BOX	EA	1
T750-121000*	1/2" X 1000' LIQUID TITE CONDUIT - NON-METALLIC, 1000' PER ROLL	EA	1
T750-34100	3/4" X 100' LIQUID TITE CONDUIT - NON-METALLIC, 100' PER ROLL	EA	1
T750-34800*	3/4" X 800' LIQUID TITE CONDUIT - NON-METALLIC, 800' PER ROLL	EA	1
T750-10100	1" X 100' LIQUID TITE CONDUIT - NON-METALLIC, 100' PER ROLL	EA	1
T750-10500*	1" X 500' LIQUID TITE CONDUIT - NON-METALLIC 500' PER ROLL	EA	1
T750-125100	1-1/4" X 100' LIQUID TITE CONDUIT - NON-METALLIC, 100' PER ROLL	EA	1
T750-1550	1-1/2" X 50' LIQUID TITE CONDUIT - NON-METALLIC, 50' PER ROLL	EA	1
T750-2050*	2" X 50' LIQUID TITE CONDUIT - NON-METALLIC, 50' PER ROLL	EA	1

* Must Ship LTL Freight; \$2,000 Order to qualify for freight allowed

DiversiWhips



CAT. NO.	DESCRIPTION	UOM	ORDER MULTIPLE
T6-12-4	1/2 X 4' #10 THHN WIRE - METALLIC CONNECTORS	EA	1
T6-12-6	1/2 X 6' #10 THHN WIRE - METALLIC CONNECTORS	EA	1
T6-34-4	3/4 X 4' #8 THHN WIRE - METALLIC CONNECTORS	EA	1
T6-34-6	3/4 X 6' #8 THHN WIRE - METALLIC CONNECTORS	EA	1
T6-12-4NM	1/2 X 4' #10 THHN WIRE - NON-METALLIC CONNECTORS	EA	1
T6-12-6NM	1/2 X 6' #10 THHN WIRE - NON-METALLIC CONNECTORS	EA	1
T6-34-4NM	3/4 X 4' #8 THHN WIRE - NON-METALLIC CONNECTORS	EA	1
T6-34-6NM	3/4 X 6' #8 THHN WIRE - NON-METALLIC CONNECTORS	EA	1



T6-12-4

- Liquid tight flexible conduit system
- A labor saving convenience kit for A/C unit hookup
- Also use for heat pumps, refrigeration, hot tubs, swimming pools and outdoor lighting
- Three distinct wire colors for ease of hook up
- One (1) straight and one (1) 90° metallic or non-metallic connector
- 90° connector is removable for straight connections.
- (Second straight connector not included.)
- U.L. and C.U.L. Listed
- Bagged for Pegboard Display Hanging

DiversiWhips Pallet Packs

- DiversiWhips are now available in a convenient, bulk packaged pallet pack at a discounted price
- (1) straight and (1) 90° non-metallic connector

CAT. NO.	DESCRIPTION	UOM	ORDER MULTIPLE
TB6-12-4NM*	1/2 X 4' #10 THHN WIRE - NON-METALLIC CONNECTORS	EA	90
TB6-12-6NM*	1/2 X 6' #10 THHN WIRE - NON-METALLIC CONNECTORS	EA	60
TB6-34-6NM*	3/4 X 6' #8 THHN WIRE - NON-METALLIC CONNECTORS	EA	45

* Must Ship LTL Freight; \$2,000 Order to qualify for freight allowed



TB6-12-4NM

LiquidTite Connectors - Straight - Zinc Die Cast



DIMENSIONS = INCHES

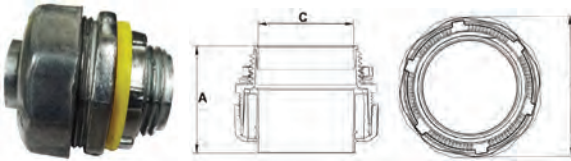

CAT. NO.	TRADE SIZE	DIMENSIONS			INNER BOX	OUTER BOX
		A	B	C (ID)		
15240	3/8"	1.46	1.30	.42	25	250
15241	1/2"	1.46	1.30	.54	25	250
15242	3/4"	1.46	1.58	.72	15	150
15243	1"	1.87	1.81	.93	8	80
15244	1-1/4"	2.06	2.26	1.26	5	50
15245	1-1/2"	2.07	2.50	1.46	4	40
15246	2"	2.01	3.01	1.89	2	20
15247	2-1/2"	3.33	3.32	2.39	-	12
15248	3"	3.50	4.32	2.95	-	12
15249	3-1/2"	4.05	4.90	3.05	-	6
15250	4"	4.09	5.17	3.83	-	6

- Terminate and Seal Liquid-tight Flexible Metal Core Conduit to either Oil-tight, Liquid-tight or Rain-tight Box or Enclosure
- Connectors can be used with Tapered Threaded Female Entry or Unthreaded KD using the Sealing Washer and Locknut

LiquidTite Connectors - Straight - Insulated - Zinc Die Cast



DIMENSIONS = INCHES

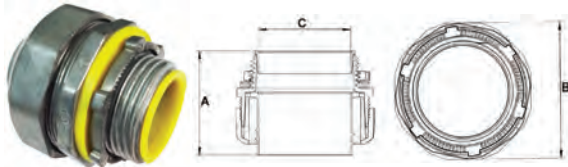

CAT. NO.	TRADE SIZE	DIMENSIONS			INNER BOX	OUTER BOX
		A	B	C		
15251	3/8"	1.52	1.30	.42	25	250
15252	1/2"	1.52	1.30	.54	25	250
15253	3/4"	1.52	1.58	.72	15	150
15254	1"	1.93	1.81	.93	8	80
15255	1-1/4"	2.08	2.26	1.26	5	50
15256	1-1/2"	2.15	2.50	1.46	4	40
15257	2"	2.08	3.01	1.89	2	20
15258	2-1/2"	3.41	3.72	2.32	-	10
15259	3"	3.58	4.33	2.93	-	10
15260	3-1/2"	4.07	4.86	3.33	-	6
15261	4"	4.17	5.24	3.83	-	6

- Terminate and Seal Liquid-tight Flexible Metal Core Conduit to either Oil-tight, Liquid-tight or Rain-tight Box or Enclosure
- Connector can be used with Tapered Threaded Female Entry or Unthreaded KD using the Sealing Washer and Locknut

90° LiquidTite Connectors - Zinc Die Cast



DIMENSIONS = INCHES

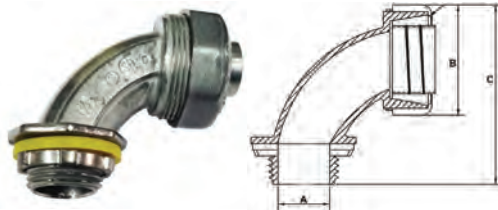

CAT. NO.	TRADE SIZE	DIMENSIONS			INNER BOX	OUTER BOX
		A	B	C		
15280	3/8"	.61	1.30	2.04	15	150
15281	1/2"	.61	1.30	2.10	15	150
15282	3/4"	.81	1.57	2.64	10	100
15283	1"	1.00	1.81	2.93	5	50
15284	1-1/4"	1.36	2.26	3.34	4	40
15285	1-1/2"	1.61	2.50	3.74	2	20
15286	2"	2.05	3.01	4.21	1	10
15287	2-1/2"	2.48	3.72	5.31	-	6
15288	3"	3.10	4.33	6.05	-	4
15289	3-1/2"	3.54	4.86	6.47	-	3
15290	4"	4.10	5.24	6.90	-	3

- 90° Orientation
- Terminate and Seal Liquid-tight Flexible Metal Core Conduit to either Oil-tight, Liquid-tight or Rain-tight Box or Enclosure
- Connectors can be used with Tapered Threaded Female Entry or Unthreaded KD using the Sealing Washer and Locknut

90° LiquidTite Connectors - Insulated Throat - Zinc Die Cast



DIMENSIONS = INCHES

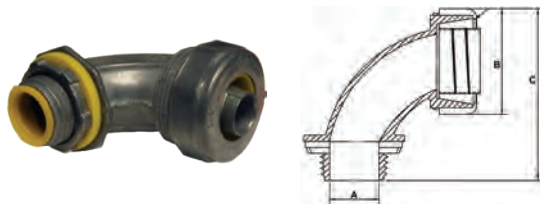

CAT. NO.	TRADE SIZE	DIMENSIONS			INNER BOX	OUTER BOX
		A	B	C		
15291	3/8"	.56	1.30	2.09	15	150
15292	1/2"	.56	1.30	2.15	15	150
15293	3/4"	.73	1.57	2.69	10	100
15294	1"	.93	1.81	2.98	5	50
15295	1-1/4"	1.22	1.46	3.40	4	40
15296	1-1/2"	1.46	2.50	3.80	2	20
15297	2"	1.87	3.01	4.27	1	10
15298	2-1/2"	2.32	3.72	5.39	-	6
15299	3"	2.93	4.33	6.13	-	4
15300	3-1/2"	3.33	4.86	6.55	-	3
15301	4"	3.86	5.24	6.98	-	3

- 90° Orientation
- Terminate and Seal Liquid-tight Flexible Metal Core Conduit to either Oil-tight, Liquid-tight or Rain-tight Box or Enclosure
- Connectors can be used with Tapered Threaded Female Entry or Unthreaded Knockout using the Sealing Washer and Locknut provided

LiquidTite Connectors



- For use with metallic and non metallic liquid tite conduit, Type B
- Provides smooth connection
- No sharp edges to damage wir.
- Wire easily pulled through
- U. L. Listed, C.U.L. Listed.

CAT. NO.	DESCRIPTION	UOM	ORDER MULTIPLE
NON-METALLIC			
T750-NMLT50	1/2" NON-METALLIC STRAIGHT CONNECTOR	EA	1
T750-NMLT75	3/4" NON-METALLIC STRAIGHT CONNECTOR	EA	1
T750-NMLT9050	1/2" NON-METALLIC 90 DEGREE ELBOW CONNECTOR	EA	1
T750-NMLT9075	3/4" NON-METALLIC 90 DEGREE ELBOW CONNECTOR	EA	1



T750-NMLT50



T750-NMLT9050

Single Piece LiquidTite Fittings



- Conduit threads onto ferrule and up inside the outer body
- Inside taper squeezes down on conduit for superior liquid tight seal
- Cut portion of conduit does not show, giving a more finished appearance
- Easy to use at a lower cost than regular liquid tite fittings
- U.L. and C.U.L. Listed

DIMENSIONS = INCHES

CAT. NO.	DESCRIPTION	UOM	ORDER MULTIPLE
T750-SLTC50	1/2" STRAIGHT SCREW-ON FITTING	EA	1
T750-SLTC9050	1/2" 90° SCREW-ON FITTING	EA	1
T750-SLTC75	3/4" STRAIGHT SCREW-ON FITTING	EA	1
T750-SLTC9075	3/4" 90° SCREW-ON FITTING	EA	1



T750-SLTC50

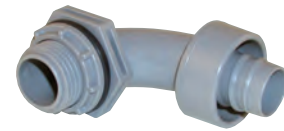

T750-SLTC9050

Non-Metallic LiquidTite Connectors - Straight



- Terminate and Seal Non-Metallic Liquid-tight Conduit
- Nylon Construction with Zinc Die-Cast Locknut
- UV Resistant

DIMENSIONS = INCHES

CAT. NO.	TRADE SIZE	DIMENSIONS		INNER BOX	OUTER BOX
		A	B		
21813	1/2"	2.11	1.43	25	150
21814	3/4"	2.30	1.70	10	100
21815	1"	2.26	1.91	5	50
21816	1-1/4"	2.70	2.40	5	50
21817	1-1/2"	2.76	2.70	4	40
21818	2"	2.81	3.39	2	20

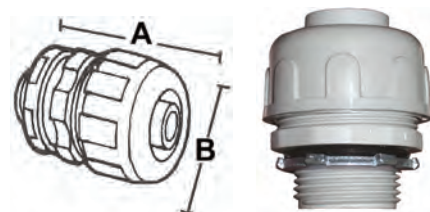

Non-Metallic LiquidTite Connectors - 90°



- 90° Orientation
- Terminate and Seal Non-Metallic liquid-tight Conduit
- Nylon Construction with Zinc Die-Cast Locknut
- UV Resistant

DIMENSIONS = INCHES

CAT. NO.	TRADE SIZE	DIMENSIONS			INNER BOX	OUTER BOX
		A	B	C		
21823	1/2"	.80	1.43	2.39	25	150
21824	3/4"	1.00	1.70	2.52	10	100
21825	1"	1.28	1.91	2.74	5	50
21826	1-1/4"	1.64	2.40	4.31	3	30
21827	1-1/2"	1.88	2.70	4.55	2	20
21828	2"	2.37	3.39	4.88	1	10

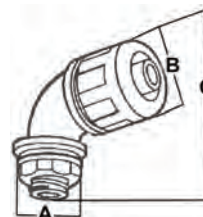



FLEX STRIPS AND ROPES

***IP20 AND IP65
12V / 24V / 120V***

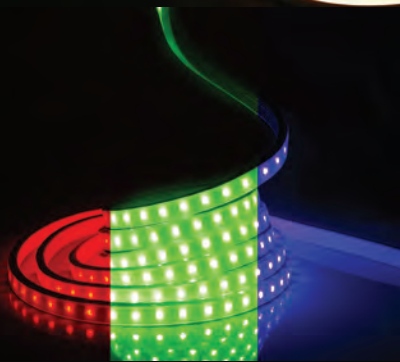

***2700K
4000K
6500K
& **R****G****B*****

FLEXIBLE
STRIP LIGHTING