



LUMENEST
LIGHTING INC.

LumeLit Lighting Products.

LED Exterior Lights:

Pg.4-5 LumelLit Outdoor Area Lights

Pg.6 LumelLit Tun-able Wall pack.

Pg.7-8 LumelLit Flood Lights.

LED Interior Flat Panels & Troffer Retro:

Pg.9 LumelLit Tunable Back-Lit LED Panel

Pg.10 LumelLit Tunable Edge-Lit LED Panel

Pg.11 LumelLit Tunable Troffer LED Retro

LED Can Lights, Linear Lights & Linear LED Tubes

Pg.12-13 LumelLit LED Tun-able Commercial Can Lights:

Pg.14 LumelLit LED Tun-able Can Retro:

Pg.15 LumelLit Led Tun-able Linear Strip Lights:

Pg.16 LumelLit Led Tun-able Vapor-tight Fixtures:

Pg.17 LumelLit 4Ft. Linear LED Tubes:

Pg.18 LumelLit 8Ft. Linear Led Tubes:

LED Hi Bay Lights:

Pg.19 LumelLit LED I Beam Type Hi Bays:

Pg.20 LumelLit LED UFO Hi Bays:

Please Email for Ship Quote or Quantity Pricing: lumenestlightinginc@pm.me



Lighting & Electrical Supply

www.lumenestlightinginc.com

lumenestlightinginc@pm.me

Smart Control Technology. Remote program sensor functions to automate and control sensitivity and brightness levels for photocell, bi-level dimming, and motion detection.

FEATURES

Lumen Output	17000 to 51000 lumens
Efficacy	170 lm/W
Input Voltage	120-277V or 277-480V
Dimmable	0-10V Continuous
CCT	4000K or 5000K
IP Rating	IP67 Wet Location
Impact Protection	IK10 /20J
Neutral Salt Spray /Fog Rating	Grade 9
Surge Protection	3kV-6.6kV: LN, 5kV-10kV: LN-PE/N-PE
Vibration Rating	3g
Warranty	10 Years

APPLICATIONS

Premium outdoor luminaire suitable for parking areas, auto dealerships, industrial yards, building exteriors, roadways, alleys, and pedestrian walkways.

CONSTRUCTION

Manufactured for weather-proof durability using solid heavy duty die cast aluminum housing with anti-UV polyester coating to resist water, salt, corrosion, discoloration, and scratching. IP67 Wet Location rated for dust-tight, temporary immersion: IEC 60529. Impact Protection IK10, 20 joules: IEC 62262:2002. NSS, Neutral Salt Spray Rating Grade 9, 0<A≤1%: ASTM B117-2018/ASTM D1654-05. Vibration Acceleration Rating 3g: IEC 6008-2-6:1995.

ELECTRICAL

Input voltages 120-277V or 277-480V models with 0-10V Continuous Dimming. Operating temperatures -4°F to 122°F (-20°C to 50°C). Surge Protection Rating 3kV-6.6kV: L-N, 5kV-10kV: L-PE/N-PE: IEC 61000-4-5.

MOUNTING

Adjustable options include Slip-Fit, Round /Square Pole, and Trunnion Mounts.

OPTICS

Anti-UV Clear Polycarbonate IES /NEMA Type III Lens standard. Type II, Type IV, Type V Lens, and Glare Shield available.

CONTROLS

PIR Photocell, Bi-Level Dimming, and Motion Detection programmable twist-lock cap with Remote Control. Shorting Cap for manual switch or timer control.

LISTINGS

DLC Premium listed. UL certified to meet US and Canadian standards. FCC, CE and RoHS compliant.

WARRANTY

10 year exclusive limited warranty. View complete product warranty information



150W, 200W Models



240W, 300W Models



Slip-Fit Mount

Trunnion Mount



Square /Round Pole Mount

Smart Sensor Cap



CORRELATED COLOR TEMPERATURES (CCT)

4000K

5000K



SPECIFICATIONS

ENERGY DATA

Input Voltage: 120-277V, 277-480V
 Input Frequency: 50/60 Hz
 Wattage: 100W, 150W, 200W, 240W, 300W
 Power Factor: >0.9
 Total Harmonic Distortion (THD): <15%
 Operating Temperature: -4°F to 122°F (-20°C to 50°C)

LIGHTING DATA

Lumens: 17000 (100W), 21500 (150W), 34000 (200W), 40800 (240W), 51000 (300W)
 Lumens Per Watt: 170 lm/W
 Color Correlated Temperature (CCT): 4000K, 5000K
 Dimmable: 0-10V
 Color Rendering Index (CRI): >70
 L70: 75000 hours

ORDERING INFORMATION



LIGHTING & ELECTRICAL SUPPLY



LumeLit Area Light IP67 170lm/W

Project Name: _____

Model	Wattage	Voltage	CCT	Lumens	Life	Color	Item#	Price
LumeLIT/Area /100	100W	120/277	4000	17000	75000	D/Bronze	L0001	119.00
LumeLIT/Area /100	100W	120/277	5000	17000	75000	D/Bronze	L0002	119.00
LumeLIT/Area/100	100W	277/480	4000	17000	75000	D/Bronze	L0003	152.00
LumeLIT/Area/100	100W	277/480	5000	17000	75000	D/Bronze	L0004	152.00
LumeLIT/Area /150	150W	120/277	4000	25500	75000	D/Bronze	L0005	153.00
LumeLIT/Area /150	150W	120/277	5000	25500	75000	D/Bronze	L0006	153.00
LumeLIT/Area /150	150W	277/480	4000	25500	75000	D/Bronze	L0007	186.00
LumeLIT/Area /150	150W	277/480	5000	25500	75000	D/Bronze	L0009	186.00
LumeLIT/Area /200	200W	120/277	4000	34000	75000	D/Bronze	L0010	169.00
LumeLIT/Area /200	200W	120/277	5000	34000	75000	D/Bronze	L0011	169.00
LumeLIT/Area /240	240W	120/277	4000	40800	75000	D/Bronze	L0012	223.00
LumeLIT/Area /240	240W	120/277	5000	40800	75000	D/Bronze	L0013	223.00
LumeLIT/Area /240	240W	277/480	4000	40800	75000	D/Bronze	L0014	264.00
LumeLIT/Area /240	240W	277/480	5000	40800	75000	D/Bronze	L0015	264.00
LumeLIT/Area /300	300W	120/277	4000	51000	75000	D/Bronze	L0016	256.00
LumeLIT/Area /300	300W	120/277	5000	51000	75000	D/Bronze/Wh	L0017	256.00
LumeLIT/Area /300	300W	277/480	4000	51000	75000	D/Bronze	L0018	294.00
LumeLIT/Area /300	300W	277/480	5000	51000	75000	D/Bronze	L0019	294.00
Trunion/Slip/Pole/Yoke Mount							P0010	14.50
Photo Cell							P0011	14.50
Photocell +Dimming Motion Sensor							P0012	26.50
Sensor Remote control							P0013	22.95
Glare Shield							P0014	10.00

Optics	Mount	Sensor	Accessory
T2 Type II Lens	A Slip-Fit (Adjustable)	ALPCSG2 Photocell Cap Sensor	AGLS Glare Shield
T3 Type III Lens	B Square or Round Pole (Adjustable)	ALMSPCSG2 Photocell + Dimming Motion Sensor	(Blank) None
T4 Type IV Lens	C Square Pole (Adjustable)	SC Shorting Cap	
T5 Type V Lens	D Trunion Mount (Adjustable)		
	E None		

PHYSICAL DIMENSIONS

100W Models

13.14"L x 12.40"W x 2.55"H



150W and 200W Models

17.91"L x 12.40"W x 2.55"H



240W and 300W Models

22.79"L x 12.40"W x 2.55"H

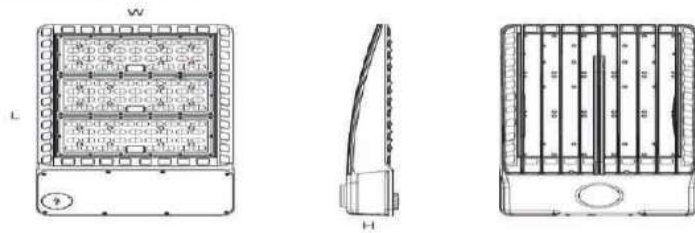

Slip-Fit Mount

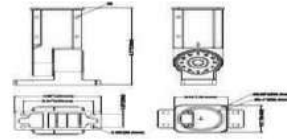

Round /Square Pole Mount

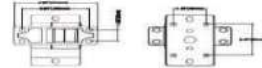
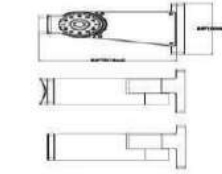

Trunion Mount

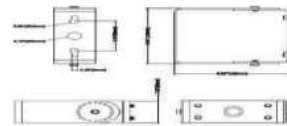

LIGHTING & ELECTRICAL SUPPLY



LumeLIT Tun able Color/ Wattage Wall pack **Project:**

Wattages, Select (40W, 50W, 60W, 80W) or Select (90W, 100W, 110W, 120W).

FEATURES

Lumen Output	5000 to 15000 lumens
Efficacy	125 lm/W
Input Voltage	120-277V
Dimmable	0-10V Continuous
CCT	5000K
IP Rating	IP65 Wet Location
Warranty	7 Years

APPLICATIONS

Premium outdoor luminaire suitable for wall mounting on building exteriors for entrances, courtyards, alleys, and pedestrian walkways.

CONSTRUCTION

Manufactured for weather-proof durability using solid heavy duty die cast aluminum housing with anti-UV polyester coating to resist water, salt, corrosion, discoloration, and scratching. IP65 Wet Location rated for dust-tight, water jets. IEC 60529.

ELECTRICAL

Input voltages 120-277V with 0-10V Continuous Dimming. Operating temperatures -22°F to 113°F (-30°C to 45°C). Surge Protection Rating L-N: 2kV, L/N-PE: 4kV. IEC 61000-4-5.

OPTICS

Anti-UV Clear Prismatic Tempered Lens.

LISTINGS

DLC Premium listed. UL certified to meet US and Canadian standards. FCC, CE and RoHS compliant.

WARRANTY

7 year exclusive limited warranty. View complete product warranty information



CORRELATED COLOR TEMPERATURE (CCT)

5000K



PHYSICAL DIMENSIONS

14.25"L x 7.50"W x 9.36"H

W

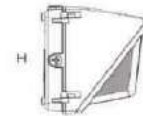
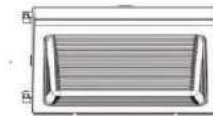

Model	Wattage	Voltage	Lumen	CCT	Item#	Price
LumeLIT/TunableWallPack80W	40W	120/277	5000	5000	L0020	86.50
	50W		6250			
	60W		7500			
	80W		10000			
LumeLIT/TunableWallPack120W	90W	120/277	11250	5000	L0021	117.00
	100W		12500			
	110W		13750			
	120W		15000			



Lighting & Electrical Supply



LumeLIT FLOOD LIGHTS

PROJECT:

FEATURES

Lumen Output	3900 to 9100 lumens
Efficacy	130 lm/W
Input Voltage	120-277V
Dimmable	No
CCT	5000K
IP Rating	IP65 Wet Location
Warranty	5 Years

APPLICATIONS

Premium outdoor luminaire suitable for building exteriors, billboards, accent lighting, and pedestrian walkways.

CONSTRUCTION

Manufactured for weather-proof durability using solid heavy duty die cast aluminum housing with anti-UV polyester coating to resist water, salt, corrosion, discoloration, and scratching. IP65 Wet Location rated for dust-tight, water jets: IEC 60529.

ELECTRICAL

Input voltages 120-277V. Operating temperatures -40°F to 113°F (-40°C to 45°C).

MOUNTING

Adjustable Knuckle Mount included.

OPTICS

Anti-UV Clear Polycarbonate Lens.

LISTINGS

DLC Premium listed, ETL certified to meet US and Canadian standards. FCC, CE and RoHS compliant.

WARRANTY

5 year exclusive limited warranty. View complete product warranty information



SPECIFICATIONS

ENERGY DATA

Input Voltage: 120-277V

Input Frequency: 50/60 Hz

Wattage: 30W, 50W, 70W

Power Factor: >0.9

Operating Temperature: -40°F to 113°F (-40°C to 45°C)

LIGHTING DATA

Lumens: 3900 (30W), 6500 (50W), 9100 (70W)

Lumens Per Watt: 130 lm/W

Color Correlated Temperature (CCT): 5000K

Dimmable: No

Color Rendering Index (CRI): >70

L70: 75000 hours

CORRELATED COLOR TEMPERATURE (CCT)

6000K



ORDERING INFORMATION

Model	Wattage	CCT	Voltage	Lumens	Color	Item#	Price.
LumeLIT/FLOOD/30W/5K	30W	5000	120/277	3900	Bronze	L0022	38.50
LumeLIT/FLOOD/50W/5K	50W	5000	120/277	6500	Bronze	L0023	56.00
LumeLIT/FLOOD/70W/5K	70W	5000	120/277	9100	Bronze	L0024	86.50



Lighting & Electrical Supply



LED Back-Lit Panel

Lumelit Tunable 2™ LED Back-Lit Panel, Select
 (3-Wattages + 3-CCT), ~117 lm/w, Dimmable +
 Smart Ready

*Includes: 3-Wattage and 3-CCT Tuning Switches on Housing, White Eggshell Housing, Frosted Polycarbonate Lens.



Description	Size	Wattage	Voltage	CCT	Light Output	Life	Item#	Price
Lumelit 2x2 Back-Lit Panel Tunable	2X2	25	120/277	(3500K	2925Lm	75000Hrs.	L0025	47.50
Wattage and CCT		30		4000K	3510Lm			
		40		5000K)	4680Lm			
Lumelit 2x4 Back-Lit Panel Tunable	2X4	30	120/277	(3500K	3510Lm	75000Hrs.	L0026	72.00
Wattage and CCT		40		4000K	4880Lm			
		50		5000K)	5850Lm			

2x2 Flange Kit	16.00
2x4 Flange Kit	21.00
2x2 Surface Mount Kit	26.00
2x4 Surface Mount Kit	30.50
INSTALLED - Emergency Battery Backup Tunable, Select (10W, 15W, 20W)	92.00



Lighting & Electrical Supply



LumeLit Color & Wattage Tun-able Flat Panel Project:

0X Setting Combinations. Select (3500K, 4000K, 5000K), Select (30W, 35W, 40W).

2x2 and 2x4 Models

FEATURES	
Lumen Output	3900 to 5200 lumens
Efficacy	150 lm/W
Input Voltage	120-277V
Dimmable	0-10V Continuous
CCT	Select (3500K, 4000K, 5000K)
Size	2x2, 2x4
Warranty	7 Years

APPLICATIONS
Premium indoor luminaire suitable for general indoor commercial spaces, lobbies, offices, meeting rooms, schools, retail stores, restrooms, hallways, and workstations.

CONSTRUCTION
Manufactured for durability using aluminum sheet housing with bath coating to resist corrosion, discoloration, and scratching. For use in Dry Locations.

ELECTRICAL
Input voltages: 120-277V with 0-10V Continuous Dimming. Operating temperatures: -4°F to 104°F (-20°C to 40°C).

MOUNTING
Recessed T-Bar Ceiling Mount.

OPTICS
Anti-UV Frosted Polycarbonate Lens.

LISTINGS
DLC Premium listed, UL certified to meet US and Canadian standards, FCC, CE and RoHS compliant.

WARRANTY
7 year exclusive limited warranty. [View complete product warranty information](#)

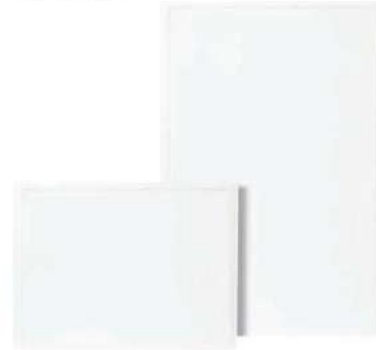

TUNABLE CORRELATED COLOR TEMPERATURES (CCT)



Model	Wattage	Voltage	Lumens	Size	CCT	Item#	Price
LumeLIT/Tunable Edge Lit Flat Panel	30W	120/277	3900	2X2	3500K	L0025	48.00
	35W		4550		4000K		
	40W		5200		5000K		
LumeLIT/Tunable Edge Lit Flat Panel	30W	120/277	3900	2X4	3500K	L0026	64.00
	35W		4550		4000K		
	40W		5200		5000K		

PHYSICAL DIMENSIONS

2x2 Models
23.74" L x 23.74" W x 1.50" H



2x4 Models
47.72" L x 23.74" W x 1.50" H

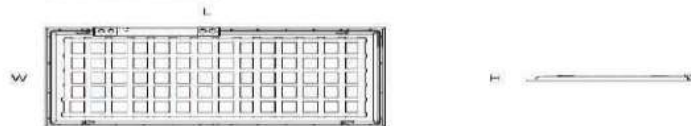

Lighting & Electrical Supply



LED Troffer

Lumelit Tunable™ LED Troffer,
 Select (3-Wattages +
 3-CCT), 130 lm/W, Dimmable
 + Smart Inside

*Includes: 3-Wattage and 3-CCT Tuning
 Switches on Housing, White Eggshell Housing,
 Frosted Polycarbonate Lens.



Description	Size	Wattage	Voltage	CCT	Light Output	Life	Item#	Price
Lumelit 2x2 Tunable Troffer	2X2	20	120/277	(3500K	2600Lm	75000Hrs.	L0029	47.50
Wattage and CCT Tunable		25		4000K	3250Lm			
		30		5000K)	3900Lm			
Lumelit 2x4 Tunable Troffer	2X4	30	120/277	(3500K	3900Lm	75000Hrs.	L0030	72.00
Wattage and CCT Tunable		35		4000K	4550Lm			
		42		5000K)	5460Lm			
2x2 Flange Kit								16.00
2x4 Flange Kit								21.00
2x2 Surface Mount Kit								26.00
2x4 Surface Mount Kit								30.50
INSTALLED - Emergency Battery Backup Tunable, Select (10W, 15W, 20W)								92.00



Lighting & Electrical Supply



LumeLIT Tunable 6"- 8" and 10" Commercial Can Light.



LED 9X Tun able (3-Wattage + 3-CCT) Commercial Down Light, 6- 8 and 10inch, IP54 Wet Location, White, 0-10V Dimmable (120-277V)

- The LumeLit is an industry leading commercial-grade 9X Tunable LED Down Light producing 100 lumens per watt.
- 9X Total Tunable Setting Combinations: 3X Tunable Wattage Settings and 3X Tunable (Select between 3000K, 4000K, 5000K)
- Includes quick set spring-arms for installation without down light housing.
- 18" Greenfield Whip & Connector
- It has anti-UV Frosted Poly-carbonate Lens for even light transmission and to prevent discoloration.
- Designed with a wide heat-sink for maximum heat dissipation.
- Suitable for commercial locations: general indoor, lobbies, offices, meeting rooms, restrooms, hallways, hospitals, airports, hotels, restaurants and shopping centers.
- 7 year /50000-hour warranty, and listed with all applicable bodies for safety and performance to qualify for energy-efficient LED lighting rebates.

LumeLIT Tunable 6-8 and 10" Commercial Can Light.

Model	Wattage	Voltage	Lumen	Dim	Size	CCT	Item#	Price
LumeLIT/6-Inch Commercial	8-12 and 16	120/277	800-1600	0-10	6-Inch	35K4K&5K	L0046	46.00
LumeLIT/8-Inch Commercial	12-16 and 22	120/277	1200-2200	0-10	8-Inch	35K4K&5K	L0047	52.00
LumeLIT/10-Inch Commercial	22-28 and 33	120/277	2200-3300	0-10	10-Inch	35K4K&5K	L0048	58.00

TUNABLE CORRELATED COLOR TEMPERATURES (CCT)

3500K

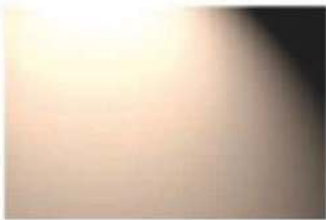

4000K

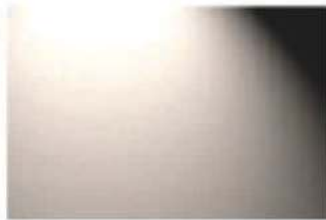

5000K



Lighting & Electrical Supply

LumeLIT Tunable 4 and 6 Inch Can Lights

Project: _____



- -3X CCT Tunable (Select between 3000K, 4000K, 5000K)
- Includes E26 Adapter and V-Springs to install into existing down light frame housing.
- It has Frosted Polycarbonate Lens for even light transmission and to prevent discoloration.
- Rated IP40 Dry Location
- Fits into most recessed housings and suitable for non-commercial general indoor and covered locations.
- 5year /50000-hour warranty, and listed with all applicable bodies for safety and performance to qualify for energy-efficient LED lighting rebates

Model	Wattage	Voltage	Lumens	Size	CCT	Item#	price.
LumeLIT/4-Inch Can Retro	8W	120/277	700	4-Inch	3K4K&5K	L0049	20.50
LumeLIT/6-Inch Can Retro	12W	120/277	1040	6-Inch	3K4K&5K	L0050	24.50



Lighting & Electrical Supply

LumeLIT Wattage/Color Tunable Strip Light

Project:

SR Setting Combinations: Select (3500K, 4000K, 5000K), Select 4-FT (25W, 30W, 40W) or Select 8-FT (54W, 60W, 65W). Smart Sensor Ready for Daylight, Bi-level dimming, and motion detection.

SPEC LINKS	
Lumen Output	3250, 3650 Lumens
Efficiency	130 lm/W
Input Voltage	120-277V
Dimming	0-10V Continuous
CRI	85+ (3500K, 4000K, 5000K)
IP Rating	IP65 Wet Location
Size	4-FT, 8-FT
Warranty	7 Years

APPLICATIONS
Premium indoor luminaire for hanging or surface mounting in setting spaces less than 25 feet. Suitable for gymnasiums, warehouses, manufacturing, packaging storage areas, workstations, and covered decks.

CONSTRUCTION
Manufactured for durability using aluminum, steel housing with non-toxic coating to resist corrosion, discoloration, and scratching. IP65 Wet Location rated for protection against solid objects 1.0mm diameter and greater, splashing water. IEC 60529.

ELECTRICAL
Input voltages: 120-277V models with 0-10V Continuous Dimming. Tunable CCT (3500K, 4000K, 5000K) and Tunable Wattage (4-FT, 25W, 30W, 40W) or (8-FT, 54W, 60W, 65W). Operating temperatures -4°F to 104°F (-20°C to 40°C).

MOUNTING
Surface, Surface (Chain), Hang Mounts standard. Optional V-Hooks and Chains for hanging available.

OPTICS
Anti-UV Frosted Prismatic Polycarbonate Lens.

CONTROLS
Fixture mounted daylight, bi-level dimming, and motion detection sensor available.

LISTINGS
DLC Premium listed, UL certified to meet US and Canadian standards, FCC, CE, and RoHS compliant.

WARRANTY
7 year exclusive limited warranty. View complete product warranty information.



TUNABLE CORRELATED COLOR TEMPERATURES (CCT)



Model	Wattage	Voltage	Lumens	Size	CCT	Item#	Price
LumeLIT/Tunable Linear Strip	25W	120/277	3250	4-FT	3500K	L0051	46.00
	30W		3900		4000K		
	40W		5200		5000K		
LumeLIT/Tunable Linear Strip	54W	120/277	7020	8-FT	3500K	L0052	88.00
	60W		7900		4000K		
	65W		8450		5000K		

- 4-FT Wire Guard
- 8-FT Wire Guard
- 4-FT Frosted Prismatic Polycarbonate Replacement Lens
- 8-FT Frosted Prismatic Polycarbonate Replacement Lens
- 10-FT Galvanized Aircraft Cables for Hanging (Pair)
- INSTALLED - Smart Sensor for Photocell and PIR Bi-Level Motion Dimming
- Wireless Remote Controller to Smart Sensor
- INSTALLED - Emergency Battery Backup Tunable, Select (10W, 15W, 20W)

\$	15.00
\$	26.00
\$	12.00
\$	20.00
\$	9.00
\$	37.00
\$	15.00
\$	80.00



Lighting & Electrical Supply



LumeLIT Tunable Wattage/Color Vapor Tight Project:

FEATURES	
Lumen Output	4420 to 11700 lumens
Efficiency	130 lm/W
Input Voltage	120-277V
Dimmable	0-10V Continuous
CCT	Select (3500K, 4000K, 5000K)
IP Rating	UL Wet Location
Size	4-FT, 8-FT
Warranty	7 Years

APPLICATIONS

Premium indoor luminaire for hanging or surface mounting in ceiling spaces less than 26 feet. Suitable for harsh environments, manufacturing, production, processing, R&D, parking garages, stairwells, and wet locations.

CONSTRUCTION

Manufactured for durability with injection molded polycarbonate to resist corrosion, discoloration, and scratching. Stainless steel clips lock the lens cover to resist dust, moisture and vapors. UL Wet Location rated.

ELECTRICAL

Input voltages 120-277V models with 0-10V Continuous Dimming, Tunable CCT (3500K, 4000K, 5000K) and Tunable Wattage (4-FT, 34W, 38W, 45W) or (8-FT, 65W, 75W, 90W). Operating temperatures -40°F to 104°F (-40°C to 40°C).

MOUNTING

Surface Mounts standard. Optional V-Hooks and Chain ready.

OPTICS

Anti-UV Frosted Prismatic Polycarbonate Lens.

LISTINGS

DLC Premium listed, UL certified to meet US and Canadian standards, FCC, CE and RoHS compliant.

WARRANTY

7 year exclusive limited warranty. View complete product warranty information



TUNABLE CORRELATED COLOR TEMPERATURES (CCT)



Model	Wattage	Voltage	Lumens	Size	CCT	Item#	Price
LumeLIT/Tunable Vapor Tight	(34W)	120/277	4420	4-FT	(3500K)	L0053	63.00
	38W		4940		4000K		
	45W		5850		5000K		
LumeLIT/Tunable Vapor Tight	(65W)	120/277	8450	8-FT	(3500K)	L0054	137.00
	75W		9750		4000K		
	90W		11700		5000K		
Chain and V Hooks Kit						P0010	3.15



LumELIT TLED HYBRID TYPE A + B

Project Name: _____

with or without a ballast. Supports single-ended or double-ended installations and compatible with shunted or non-shunted tombstones.

FEATURES	
Lumen Output	1860 to 2790 lumens
Efficacy	155 lm/W
Input Voltage	120-277V
Driver	Dual Mode Internal Driver (Type A+B)
Installation	Single or Double Ended
Dimmable	No
Size	4-FT
CCT	4000K or 5000K
IP Rating	IP44 Wet Location
Warranty	5 Years



APPLICATIONS

Premium indoor replacement lamp intended to replace 4 foot T8 or T12 fluorescent lamps with a G13 base for linear lighting fixtures. Suitable for use in linear troffers, wraparounds, and shop lights.

CONSTRUCTION

Manufactured for durability and heat dissipation using aluminum sheet backing. IP44 Wet Location rated for protection against solid objects 1.0mm diameter and greater, splashing water. IEC 60529.

ELECTRICAL

Input voltages 120-277V. Type A+B, Hybrid plug and play to operate with or without a ballast. Single or Double-Ended Power installations. Operating temperatures -4°F to 104°F (-20°C to 40°C).

OPTICS

Anti-UV Frosted Polycarbonate Lens standard. Optional Clear Polycarbonate Lens available.

CONTROLS

Compatible with ON/OFF occupancy sensors.

LISTINGS

DLC Premium listed. UL certified to meet US and Canadian standards. FCC, CE and RoHS compliant.

WARRANTY

5 year exclusive limited warranty. View complete product warranty information

CORRELATED COLOR TEMPERATURES (CCT)

4000K

5000K



SPECIFICATIONS

ENERGY DATA

Input Voltage: 120-277V

Input Frequency: 50/60 Hz

Wattage: 12W, 15W, 18W

Power Factor: >0.9

Total Harmonic Distortion (THD): <15%

Operating Temperature: -4°F to 104°F (-20°C to 40°C)

LIGHTING DATA

Lumens: 1860 (12W), 2325 (15W), 2790 (18W)

Lumens Per Watt: 155 lm/W

Color Correlated Temperature (CCT): 4000K, 5000K

Dimmable: No

Color Rendering Index (CRI): >80

L70: 50000 hours

ORDERING INFORMATION

MODEL	SIZE	Wattage	Voltage	Lumens	CCT	Dimming	Color	Item#	Price
LumELIT/-T8-4F-12	4FT	12	120/277	1860	4K	NO	4000	L0055	5.65
LumELIT/-T8-4F-12	4FT	12	120/277	1860	5K	NO	5000	L0056	5.65
LumELIT/-T8-4F-15	4FT	15	120/277	2325	4K	NO	4000	L0057	5.65
LumELIT/-T8-4F-15	4FT	15	120/277	2325	5K	NO	5000	L0058	5.65
LumELIT-T8-4F-18	4FT	18	120/277	2790	4K	NO	4000	L0059	5.65
LumELIT-T8-4F-18	4FT	18	120/277	2790	5K	NO	5000	L0060	5.65



Lighting & Electrical Supply



LumeLIT TLED HYBRID TYPE A + B

Project Name: _____

installations for use without a ballast. Compatible with shunted or non-shunted tombstones.

FEATURES	
Lumen Output	5200 lumens
Efficacy	130 lm/W
Input Voltage	120-277V
Driver	Internal Driver, Line Voltage (Type B)
Installation	Double Ended
Dimmable	No
Size	8-FT
CCT	4000K or 5000K
IP Rating	IP44 Wet Location
Warranty	5 Years

APPLICATIONS

Premium indoor replacement lamp intended to replace 8 foot T8 or T12 fluorescent lamps with FA8 Single-Pin, or R17D Rotatable base, for linear lighting fixtures. Suitable for use in linear wraparounds and shop lights.

CONSTRUCTION

Manufactured for durability and heat dissipation using aluminum sheet backing. IP44 Wet Location rated for protection against solid objects 1.0mm diameter and greater, splashing water. IEC 60529.

ELECTRICAL

Input voltages 120-277V, Type B, to operate without a ballast. Double-Ended Power installations for FA8 or R17D Rotatable end caps. Operating temperatures -4°F to 104°F (-20°C to 40°C).

OPTICS

Anti-UV Frosted Polycarbonate Lens standard. Optional Clear Polycarbonate Lens available.

CONTROLS

Compatible with ON/OFF occupancy sensors.

LISTINGS

DLC Premium listed, UL certified to meet US and Canadian standards. FCC, CE and RoHS compliant.

WARRANTY

5 year exclusive limited warranty. View complete product warranty information



CORRELATED COLOR TEMPERATURES (CCT)

4000K

5000K



MODEL	SIZE	Wattage	Voltage	Lumens	CCT	Dimming	Item#	Price.
LumeLIT/-T8-8F-40/FAB	8FT	40	120/277	5200	4K	NO	L0061	16.25
LumeLIT/-T8-8F-40/FAB	8FT	40	120/277	5200	5K	NO	L0062	16.25
LumeLIT/-T8-8F-40/R17D	8FT	40	120/277	5200	4K	NO	L0063	16.25
LumeLIT/-T8-8F-40/R17D	8FT	40	120/277	5200	5K	NO	L0064	16.25



Lighting & Electrical Supply

LumeLit 2ft 4ft I BEAM HI Bay SERIES

Project Name:

Engineered for balanced LED lumen output with long-rated life. Smart Ready for daylight, and bi-level dimming, motion and occupancy sensor functions.

Features

Sizes	2 ft and 4 ft
Finish	Pure White Semi-Gloss
Diffuser	Anti-UV Frosted Polycarbonate Lens
Rated Life	75000 hours
Warranty	7 years

Construction

Manufactured for durability using heavy duty die cast aluminum housing with anti-UV polyester coating to resist corrosion, discoloration, and scratching.

Applications

Primary use as high-bay luminaires for commercial and industrial buildings. Pendant or surface mounted specifically for indoor high ceiling spaces above 25 feet.

Listings

DLC Premium listed. UL certified to meet US and Canadian standards. FCC, CE and RoHS compliant. View DLC Premium listing at: designlights.org/qpl



Model NO.	Wattage	Voltage	CCT	Light Output	Life	Item#	Price
LumeLIT/HIBAY2/90/4k/	90	120/277	4000	11700LM	75000	L0065	75.00
LumeLIT/HIBAY2/90/5k/	90	120/277	5000	11700LM	75000	L0066	75.00
LumeLIT/HIBAY2/110/4k/	110	120/277	4000	14300LM	75000	L0067	85.50
LumeLIT/HIBAY2/110/5k/	110	120/277	4000	14300LM	75000	L0068	85.50
LumeLIT/HIBAY2/162/4k/	162	120/277	4000	21060LM	75000	L0069	103.50
LumeLIT/HIBAY2/162/5k/	162	120/277	5000	21060LM	75000	L0070	103.50
LumeLIT/HIBAY4/225/4k/	225	120/277	4000	29250LM	75000	L0071	151.00
LumeLIT/HIBAY4/225/5k/	225	120/277	5000	29250LM	75000	L0072	151.00
LumeLIT/HIBAY4/321/4k/	321	120/277	4000	41730LM	75000	L0073	187.00
LumeLIT/HIBAY4/321/5k/	321	120/277	5000	41730LM	75000	L0074	187.00
Occupancy Sensor						P0015	36.50
Pendant Mount Bracket						P0016	8.50
Wire Guard 90-321W						P0017	16.50

MODEL INCLUDES: V HOOKS AND CHAINS AS WELL AS POLYCARBONATE LENS.



Lighting & Electrical Supply



LumeLit UFO HI Bay Series

Project Name:

program Smart Sensor functions in minutes to automate or control sensitivity and brightness levels for photocell, bi-level dimming, and motion detection.

Features

IP Rating	IP65 - Wet Location
Finish	Black Satin
Diffuser	NSF Certified Clear Polycarbonate Lens
Rated Life	75000 hours
Warranty	7 years

Construction

Manufactured for wet-location durability using heavy duty die cast aluminum housing with anti-UV polyester coating to resist corrosion, discoloration, and scratching.

Applications

Primary use as high-bay luminaires for commercial and industrial buildings. Pendant or hook mounted specifically for indoor high ceiling spaces above 25 feet.

Listings

DLC listed, ETL certified to meet US and Canadian standards, FCC, CE and RoHS compliant, IP65 rated for wet location use, NSF Certified lens. View DLC listing at designlights.org/gpl

Warranty

7 year exclusive limited warranty. View complete product warranty



Performance

Wattage	See ordering information.
Voltage	120-277V or 277-480V
Frequency	50/60 Hz
Efficacy	150 lm/W
CCT	4000K or 5000K
CRI	≥ 80
Power Factor	> 0.9
THD	≤ 15%
Operating Temp.	-20°C to 45°C (-4°F to 113°F)
Dimming	0-10V

Model NO.	Wattage	Voltage	CCT	Light Output	Life	Item#	Price
LumeLIT/UFO/HIbay/100W/4K	100	120/277	4000	14000LM	75000	L0075	84.00
LumeLIT/UFO/HIbay/100W/5K	100	120/277	5000	14000LM	75000	L0076	84.00
LumeLIT/UFO/HIbay/150W/4K	150	120/277	4000	21000LM	75000	L0077	105.00
LumeLIT/UFO/HIbay/150W/5K	150	120/277	5000	21000LM	75000	L0078	105.00
LumeLIT/UFO/HIbay/200W/4K	200	120/277	4000	28000LM	75000	L0079	133.00
LumeLIT/UFO/HIbay/200W/5K	200	120/277	5000	28000LM	75000	L0080	133.00
LumeLIT/UFO/HIbay/240W/4K	240	120/277	4000	33600LM	75000	L0081	146.00
LumeLIT/UFO/HIbay/240W/5K	240	120/277	5000	33600LM	75000	L0082	146.00
LumeLIT/UFO/HIbay/150W/4K	150	277/480	4or5K	21120LM	75000	L0083	148.00
LumeLIT/UFO/HIbay/240W/5K	240	277/480	4or5K	33600LM	75000	L0084	184.00
Frosted Polycarbonate Lens						P0001	12.00
60-90- or 120-Degree Reflector						P0002	32.00
Yoke Mount						P0003	12.00
Occupancy Sensor						P0004	32.00
Sensor Remote						P0005	26.00

Model Includes Surface Mount, Black Satin Housing, Clear Polycarbonate Lens, IP65 Wet Location, Surge Protection



Lighting & Electrical Supply



